

Cambridge Road

Eastbourne

LEXTONS /
SALES
LETTINGS
AUCTIONS
COMMERCIAL



About the property

Welcome to this charming studio located on Cambridge Road in Eastbourne. This delightful building offers a modern studio apartment, perfect for those seeking a cosy living space.

One of the standout features of this property is its direct sea views, allowing you to enjoy the calming sights of the sea right from the comfort of your own home.

Conveniently situated close to Eastbourne town centre, you'll have easy access to a variety of shops, restaurants, and amenities, making daily errands a breeze. Whether you fancy a leisurely stroll along the promenade or a shopping spree in town, everything you need is just a stone's throw away.

Managed by Lextons, you can rest assured that your new home will be well taken care of, providing you with peace of mind and a hassle-free living experience.

Don't miss out on the opportunity to make this lovely property your own. With its modern finish, prime location, and captivating sea views, this house is sure to capture your heart. Contact us today to arrange a viewing and take the first step towards your new seaside lifestyle in Eastbourne!

Cambridge Road Eastbourne

£725 Per month



1

BEDROOM

null

RECEPTION

1

BATHROOM





SCAN HERE TO VIEW ALL AVAILABLE PROPERTIES

Second Floor

Approx. 15.9 sq. metres (171.4 sq. feet)

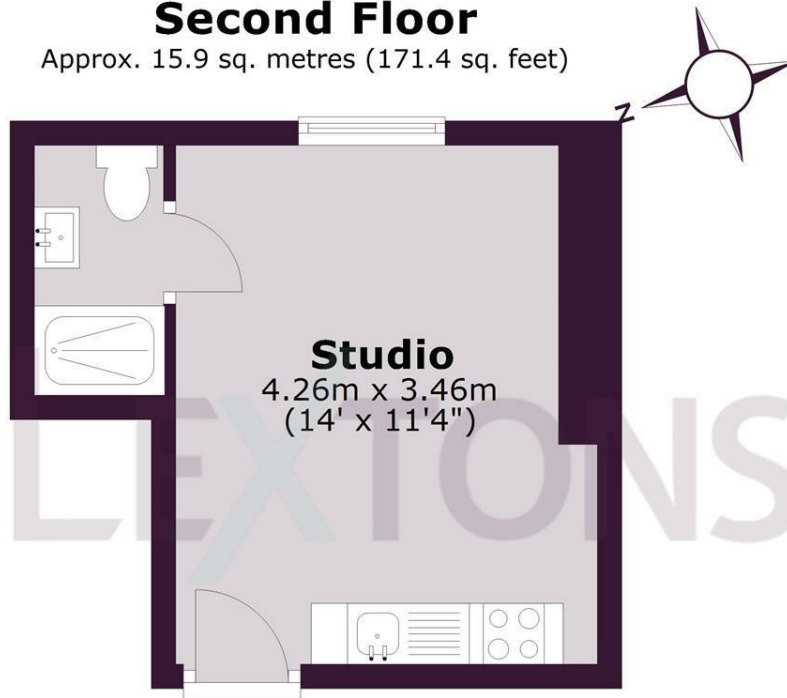

Studio

4.26m x 3.46m
(14' x 11'4")

Total area: approx. 15.9 sq. metres (171.4 sq. feet)

Whilst every care has been taken to ensure accuracy, dimensions are approximate and for illustrative purposes only.

Created for exclusive use for Lextons. All rights reserved.

Plan produced using PlanUp.

Energy Efficiency Rating		
	Current	Potential
Very energy efficient - lower running costs		
(92 plus) A		
(81-91) B		
(69-80) C	75	78
(55-68) D		
(39-54) E		
(21-38) F		
(1-20) G		
Not energy efficient - higher running costs		
England & Wales		EU Directive 2002/91/EC