



Gervase Drive, Dudley, DY1 4AT

Guide Price £399,950

🛏️ 3 🚿 2 🚗 2

- A stunning example of a three bedroom 1930's style Detached Family Home, oozing character and charm throughout, having been thoughtfully extended.
- Creating a stunning family home from the details of "stand and key ready" fittings
- Occupying this prime location within this tree lined road close to Dudley Castle & Priory Ruins, local amenities and transport routes.
- Having a Reception Hall, large Living/Dining Room, Sun Room, Modern Kitchen, Utility Room, downstairs Shower Room, Three Bedrooms, two with fitted wardrobes and a large Family Bathroom.
- To the Rear are beautiful Gardens set within an idyllic backdrop.
- An early and internal viewing is essential to appreciate the standard of living accommodation on offer.
- EPC Rating D.



A stunning example of a three bedroom 1930's style Detached Family Home, oozing character and charm throughout, having been thoughtfully extended to create this stunning family home occupying this prime location within this tree lined road close to Dudley Castle, Priory Ruins, local amenities and transport routes. Having a Reception Hall, large Living/Dining Room, Sun Room, Modern Kitchen, Utility Room, downstairs Shower Room, Three Bedrooms, two with fitted wardrobes and a large Family Bathroom. To the Rear are beautiful Gardens set within an idyllic backdrop. An early and internal viewing is essential to appreciate the standard of living accommodation on offer.



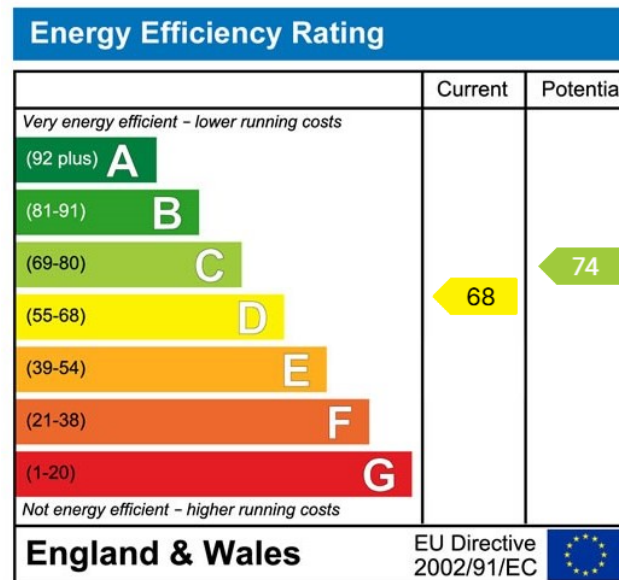
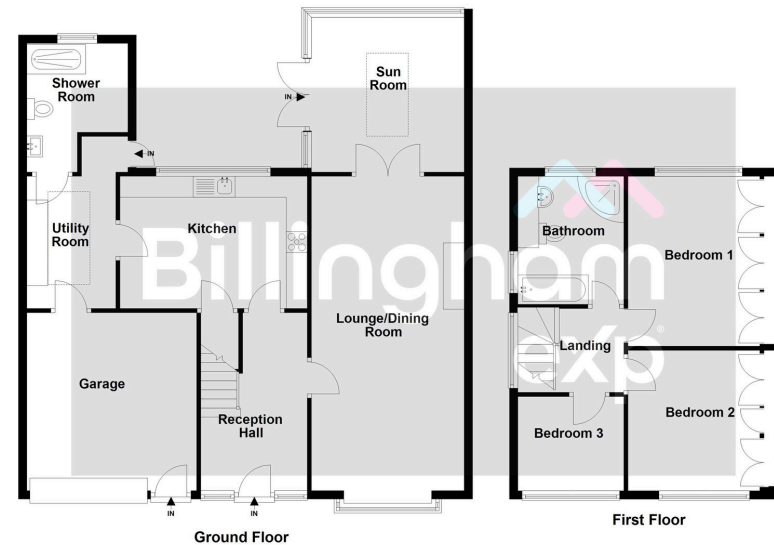

01384 444 004
www.billingham.properties

