



**St. Margarets Road, St. Leonards-On-Sea TN37 6EH**

**Offers in excess of £150,000**



A bright and spacious TWO BEDROOM APARTMENT set in an idyllic position JUST METRES FROM THE BEACH and the hub of St. Leonards On Sea where there is a range of local shops, eateries and a mainline railway station with connections to London. Set on the TOP FLOOR, the accommodation here is arranged as an OPEN PLAN LIVING SPACE which is positioned at the rear of the property measuring an impressive 19'8 x 15'3 providing plenty of room for a dining table and the kitchen is fitted to offer ample storage space and a handy BREAKFAST BAR. There are two bedrooms both enjoying a front aspect together with a family bathroom where there is a bath with shower and screen over. Being sold with NO ONWARD CHAIN, this fantastic property would make the PERFECT FIRST TIME HOME or seaside retreat and is not to be missed.

TOP FLOOR  
617 sq.ft. (57.3 sq.m.) approx.

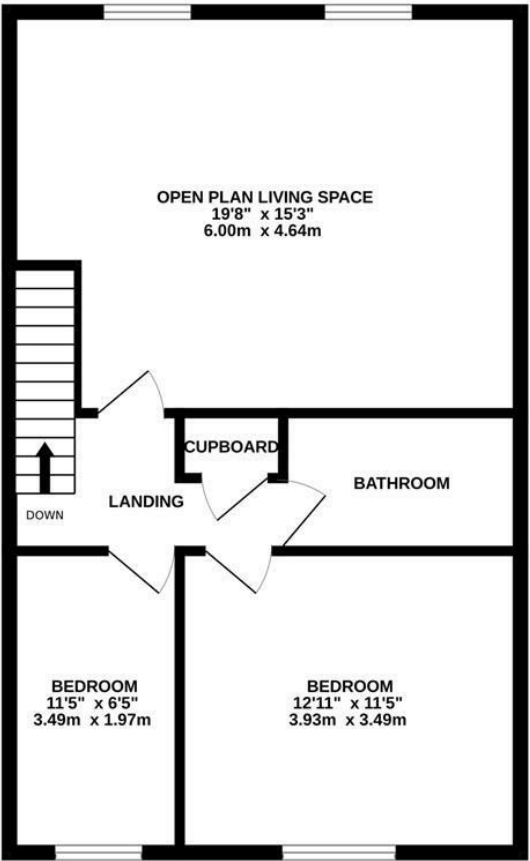

TOTAL FLOOR AREA : 617 sq.ft. (57.3 sq.m.) approx.

Whilst every attempt has been made to ensure the accuracy of the floorplan contained here, measurements of doors, windows, rooms and any other items are approximate and no responsibility is taken for any error, omission or mis-statement. This plan is for illustrative purposes only and should be used as such by any prospective purchaser. The services, systems and appliances shown have not been tested and no guarantee as to their operability or efficiency can be given.

Made with Metropix ©2025

