

**Whittaker Lane, Rochdale OL11 5PL**  
**OFFERS INVITED IN EXCESS OF £300,000**  
**Council Tax Band C**



**ADAMSONS BARTON KENDAL** are pleased to present this exceptional two bedroom detached bungalow, ideally located on a generous corner plot in the highly sought-after area of Norden. Situated within an established and popular development, the property is within walking distance of the village and a wide range of local amenities. The bungalow enjoys an elevated position, offering delightful views of the surrounding countryside, including Knowl Hill and Scout Moor

**Head Office** - 122 Yorkshire Street  
ROCHDALE  
Lancashire  
OL16 1LA  
Tel : (01706) 653214

**Middleton Office** – 13 Long Street  
Middleton  
M24 6TE  
Tel : (0161) 643 0777

Upon entering the property, prospective buyers are greeted by a spacious entrance hallway, accessed via a welcoming front porch. To the right, a large reception room provides a bright and airy living space, perfect for both relaxation and entertaining. The fitted dining kitchen, located at the rear, offers ample storage and workspace, with the adjoining conservatory providing a peaceful area to enjoy the garden views. The property benefits from two generously sized double bedrooms, as well as a modern family bathroom featuring a walk-in shower cubicle.

Set on a substantial plot, the property offers potential for expansion (subject to obtaining the relevant planning permissions), allowing buyers the opportunity to enhance and tailor the property to their individual needs.

Externally, the bungalow boasts excellent kerb appeal, with mature and meticulously maintained wraparound gardens. The rear garden offers a high degree of privacy, featuring a well-maintained lawn, a charming patio area, and beautifully stocked borders. To the front, a block-paved driveway accommodates up to two vehicles, while a single garage provides excellent storage space and the potential for conversion into additional living space, should the buyer wish to explore that option.

Early viewing is highly recommended to fully appreciate the superb position of this property, which is ideally suited for those looking to downsize while enjoying the benefits of a tranquil and picturesque setting.





## ADDITIONAL INFORMATION

Council Tax Band - C

Energy Performance Cert - D59

Tenure - Freehold

## VIEWING STRICTLY BY APPOINTMENT WITH SOLE AGENTS ADAMSONS BARTON KENDAL

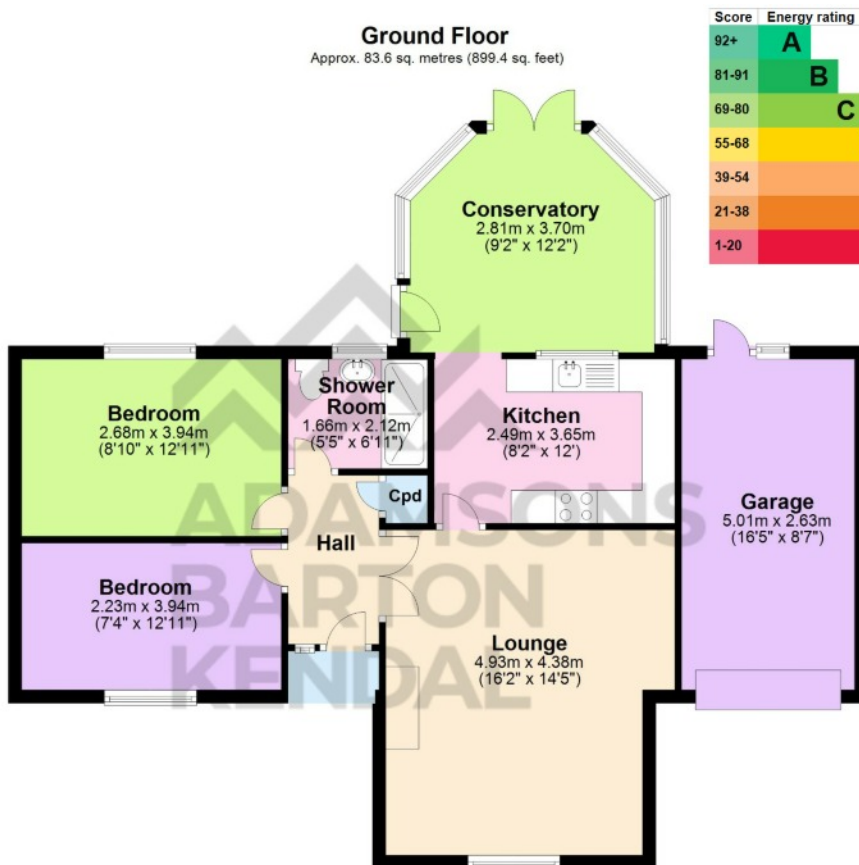

Total area: approx. 83.6 sq. metres (899.4 sq. feet)

Disclaimer - Whilst every attempt has been made to ensure the accuracy of the floor plan contained here, this plan is for illustrative purposes only and should only be used as such by any prospective purchaser.  
Plan produced using PlanUp.

w - [abkproperty.co.uk](http://abkproperty.co.uk)

e - [sales@abkproperty.co.uk](mailto:sales@abkproperty.co.uk)

Adamsons Barton Kendal for themselves and for the vendors or lessors of this property whose agents they are, give notice that (i) the particulars are set out as a general outline only for the guidance of intending purchasers or lessees, and do not constitute, nor constitute part of an offer or contract; (ii) all descriptions, dimensions, references to condition and necessary permission for use and occupation, and other details are given without responsibility and any intending purchasers or tenants should not rely on them as statements or representations of fact but must satisfy themselves by inspection or otherwise as to the correctness of each of them; (iii) no person in the employment of Adamsons Barton Kendal has any authority to make or give any representations or warranty in relation to this property.

Due to a change in the legislation as from 1<sup>st</sup> March 2004 we are required to check your identification. This is a legal requirement and applies to all Estate Agents: (i) proceeding to market any property; and (ii) should you make an offer on one of our properties and this offer becomes acceptable, before we can instruct Solicitors to proceed with the transaction. Suitable identification can be: Current signed Passport; New style Driving Licence with photograph; Inland Revenue Tax notification