



Property to rent

Boleyn Road, E6

PRICE £ 1,750.00



2 Bedroom



Kitchen



1 Reception



1 Bathroom



Balcony



Boleyn Road, E6

PRICE £ 1,750.00

Ideally located a short walk to Upton Park underground station, amenities, and various green spaces, is this well well-presented two-bedroom property, to rent. The property is very modern throughout and boasts a large living room, leading to a private balcony. Spacious kitchen, fully fitted with all appliances accordingly. Both bedrooms are doubles, and the bathroom is finished to a contemporary style. The property includes all large pieces of furniture is available from 24th February.







Letting Price



2 Bedroom



1 Bathroom



1 Reception



Council Tax Band



Balcony



72

EPC Band



FIRST FLOOR
636 sq.ft. (59.1 sq.m.) approx.

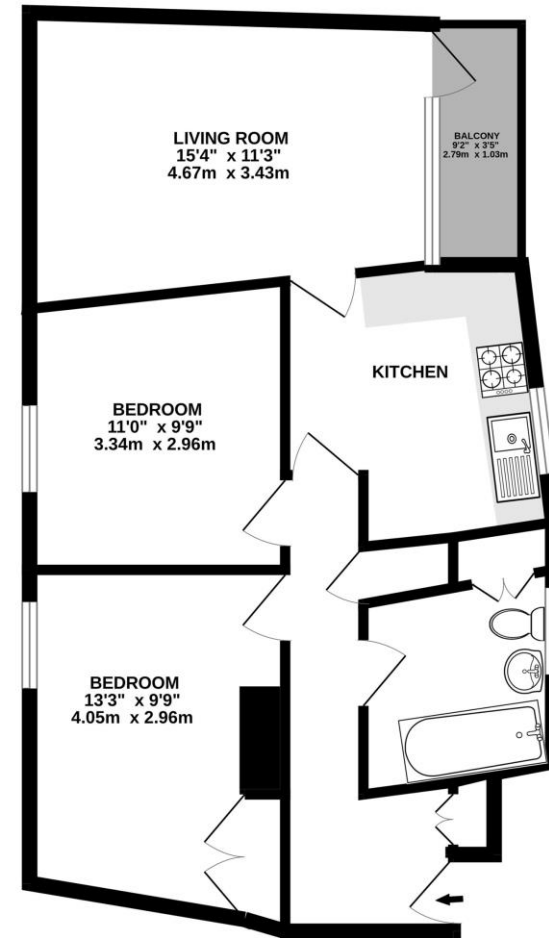

TOTAL FLOOR AREA : 636sq.ft. (59.1 sq.m.) approx.

Whilst every attempt has been made to ensure the accuracy of the floorplan contained here, measurements of doors, windows, rooms and any other items are approximate and no responsibility is taken for any error, omission or mis-statement. This plan is for illustrative purposes only and should be used as such by any prospective purchaser. The services, systems and appliances shown have not been tested and no guarantee as to their operability or efficiency can be given.

Made with Metropix ©2024

KENTISH TOWN | 189 Kentish Town Rd | London | NW5 2JU | T: 020 7284 1222 | hello@oliverstown.com

ASSOCIATED MAYFAIR | 121 Park Lane | London | W1K 7AG | T: 020 3368 8602 | hello@oliverstown.com