



Foxcovers Road, Bebington

£325,000



LESLEY HOOKS
ESTATE AGENTS





Stunningly presented and fully refurbished throughout, this exceptional three bedroom semi-detached home has been finished to an impressive standard and is ready to move straight into. Boasting uPVC double glazing and a newly installed combi central heating system, this is the one you have been waiting for! On the ground floor, the welcoming porch leads through to a bright and airy hallway, setting the tone for the quality that awaits. The spacious lounge is a real showstopper, complete with a stylish media wall — perfect for those cosy nights in. A second generous sitting room also benefits from its own media wall and features elegant double doors that open out into the conservatory, flooding the space with natural light and creating a wonderful indoor-outdoor feel. The newly fitted kitchen is simply smart, offering a sleek, modern finish with integrated fridge and washing machine — a real cook's delight! To the first floor, there are three good size bedrooms, all beautifully presented, together with a truly stylish three piece bathroom that wouldn't look out of place in a luxury hotel. Outside, to the front of the property there is a driveway providing off road parking leading to the garage. To the rear, the delightful garden is an absolute sun trap, enjoying a lovely southerly aspect — ideal for entertaining, relaxing or watching the little ones play. As if all that wasn't enough, the location is simply second to none. Within walking distance of well-regarded local primary, secondary and grammar schools, and with numerous shops, bus routes and Spital train station all within easy reach, this property ticks every single box. Homes of this quality, in this location, do not stay on the market for long — call us today to arrange your viewing. You are going to love it! Council tax band C. Freehold.



Porch
2'8" (0.81m) x 3'0" (0.91m)

Hallway
12'4" (3.76m) x 5'10" (1.78m)

Lounge
12'4" (3.76m) x 11'4" (3.45m)

Sitting Room
17'9" (5.41m) x 12'2" (3.71m)

Kitchen
10'0" (3.05m) x 7'6" (2.29m)

Bedroom One
12'5" (3.78m) x 11'7" (3.53m) Into Wardrobe Recess

Bedroom Two
12'4" (3.76m) x 11'7" (3.53m)

Bedroom Three
8'9" (2.67m) x 5'11" (1.8m)

Bathroom
7'8" (2.34m) x 5'10" (1.78m)







GROUND FLOOR
637 sq.ft. (59.2 sq.m.) approx.

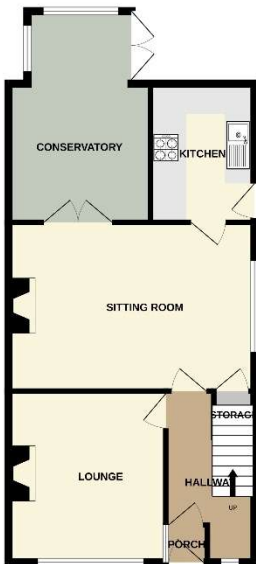

1ST FLOOR
434 sq.ft. (40.3 sq.m.) approx.



TOTAL FLOOR AREA: 1071 sq.ft. (99.5 sq.m.) approx.
Figures are based on measurements taken on site. The accuracy of these measurements cannot be guaranteed. The accuracy of these measurements is based on the information provided by the seller. The accuracy of these measurements is based on the information provided by the seller. The accuracy of these measurements is based on the information provided by the seller.

Energy Efficiency Rating		Current	Potential
Very energy efficient - lower running costs			
(92 Plus) A			
(81-91) B			
(69-80) C			72
(55-68) D			
(39-54) E		45	
(21-38) F			
(1-20) G			
Not energy efficient - higher running costs			
England & Wales		EU Directive 2002/91/EC	

Contact Us:

0151 644 6000

lesley@lesleyhooks.co.uk

6 Church Road, Bebington,

Wirral, Merseyside, CH63 7PH

Disclaimer: Whilst these details are thought to be correct, their accuracy cannot be guaranteed and do not form part of any contract. It should be noted that we have not tested any fixtures, fittings, equipment, apparatus or services, therefore we cannot verify that they are in working order of fit for purpose. Solicitors should be used to confirm that any moveable items described within these details are in fact part of the sale agreement. While we try to ensure measurements are correct they are not guaranteed and purchasers are advised to take their own measurements before ordering any fixtures and fittings. Please note: if you are buying a leasehold property, please ensure that all details and conditions of the lease are checked with your solicitor prior to you incurring any costs as additional fees could be incurred for items such as leasehold packs.