



**Connells**

Chiltern Road  
St. Albans



### Property Description

Situated in the highly sought-after Marshalswick area of St Albans, this beautifully renovated three-bedroom mid-terrace family home is offered chain free and finished to a high specification throughout, making it ready to move straight into.

The property has been thoughtfully redesigned to create a bright and modern living space, centred around a stunning open-plan kitchen, living and dining area-perfect for both family life and entertaining. The contemporary kitchen features quality fittings and ample storage, flowing seamlessly into the spacious living and dining areas with views over the rear garden. Upstairs, the home offers three well-proportioned bedrooms alongside a stylish family bathroom, while the ground floor also benefits from a convenient downstairs WC.

Externally, the property enjoys a private landscaped rear garden, ideal for relaxing or outdoor dining. To the front, there is off-road parking for two vehicles, adding to the home's practicality.

Perfectly located for families, the property sits within walking distance of several highly regarded schools including Sandringham School, Wheatfields Junior School, St John Fisher Roman Catholic Primary School, and Skyswood Primary School. For outdoor space, the popular Jersey Farm Woodland Park is just a short walk away, offering beautiful woodland walks and open green space. This is a fantastic opportunity to purchase a stylish, turn-key home in one of St Albans' most desirable family locations.



**Hall**

**Wc**

**Kitchen**

9' 2" max x 9' 2" max ( 2.79m max x 2.79m max )

**Lounge/Diner**

17' 7" max x 15' max ( 5.36m max x 4.57m max )

**Bedroom One**

13' max x 10' 6" max ( 3.96m max x 3.20m max )

**Bedroom Two**

13' 10" max x 9' 3" max ( 4.22m max x 2.82m max )

**Bedroom Three**

10' 2" max x 7' 4" max ( 3.10m max x 2.24m max )

**Bathroom**



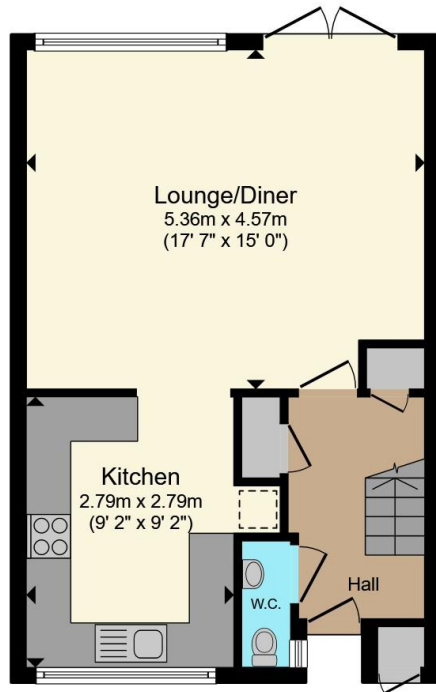

**Ground Floor**

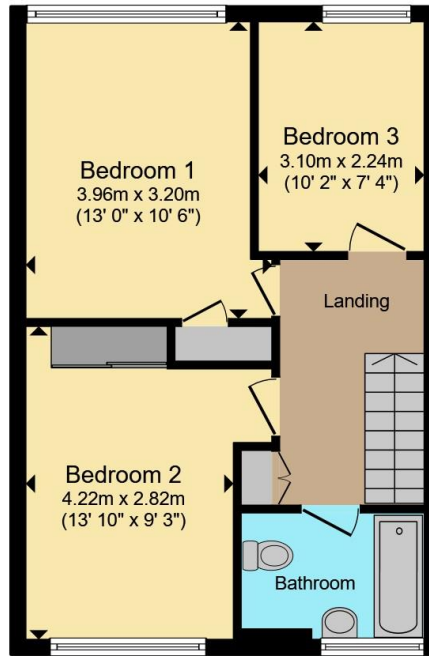

**First Floor**

Total floor area 88.4 m<sup>2</sup> (951 sq.ft.) approx

This floor plan is for illustrative purposes only. It is not drawn to scale. Any measurements, floor areas (including any total floor area), openings and orientation are approximate. No details are guaranteed, they cannot be relied upon for any purpose and they do not form part of any agreement. No liability is taken for any error, omission or misstatement. A party must rely upon its own inspection(s). Powered by www.propertybox.io



To view this property please contact Connells on

**T 01727 851 100**  
**E marshalswick@connells.co.uk**

5 Wycombe Place The Quadrant Marshalswick  
 ST ALBANS AL4 9RH

EPC Rating: C Council Tax  
 Band: D

**view this property online [connells.co.uk/Property/MWK306228](https://www.connells.co.uk/Property/MWK306228)**

Tenure: Freehold



1. MONEY LAUNDERING REGULATIONS Intending purchasers will be asked to produce identification documentation at a later stage and we would ask for your co-operation in order that there will be no delay in agreeing the sale. 2. These particulars do not constitute part or all of an offer or contract. 3. The measurements indicated are supplied for guidance only and as such must be considered incorrect. Potential buyers are advised to recheck measurements before committing to any expense. 4. We have not tested any apparatus, equipment, fixtures, fittings or services and it is in the buyers interest to check the working condition of any appliances.

Connells Residential is registered in England and Wales under company number 1489613, Registered Office is Cumbria House, 16-20 Hockliffe Street, Leighton Buzzard, Bedfordshire, LU7 1GN. VAT Registration Number is 500 2481 05.

**See all our properties at [www.connells.co.uk](https://www.connells.co.uk) | [www.rightmove.co.uk](https://www.rightmove.co.uk) | [www.zoopla.co.uk](https://www.zoopla.co.uk)**

Property Ref: MWK306228 - 0004