



House (EPC Rating: C)

18 BOLINGBROKE ROAD LONDON, W14 0AL

Per month

£2,600 Per

ALEXANDER STEER
Estate Agents



2 BEDROOM HOUSE LOCATED IN LONDON

A stunningly presented apartment located on the third floor of a well maintained period conversion, offers two spacious double bedrooms and an open plan lounge with wood floors throughout. The property offers a modern high spec finish and newly fitted tiled bathroom.

Bolingbroke Road is a quiet residential road in the heart of Brook Green offering easy access to an array of Grocery stores and local pubs and cafe's. The property is also a short walk to Hammersmith and Shepherds Bush Stations.



Bolingbroke Road

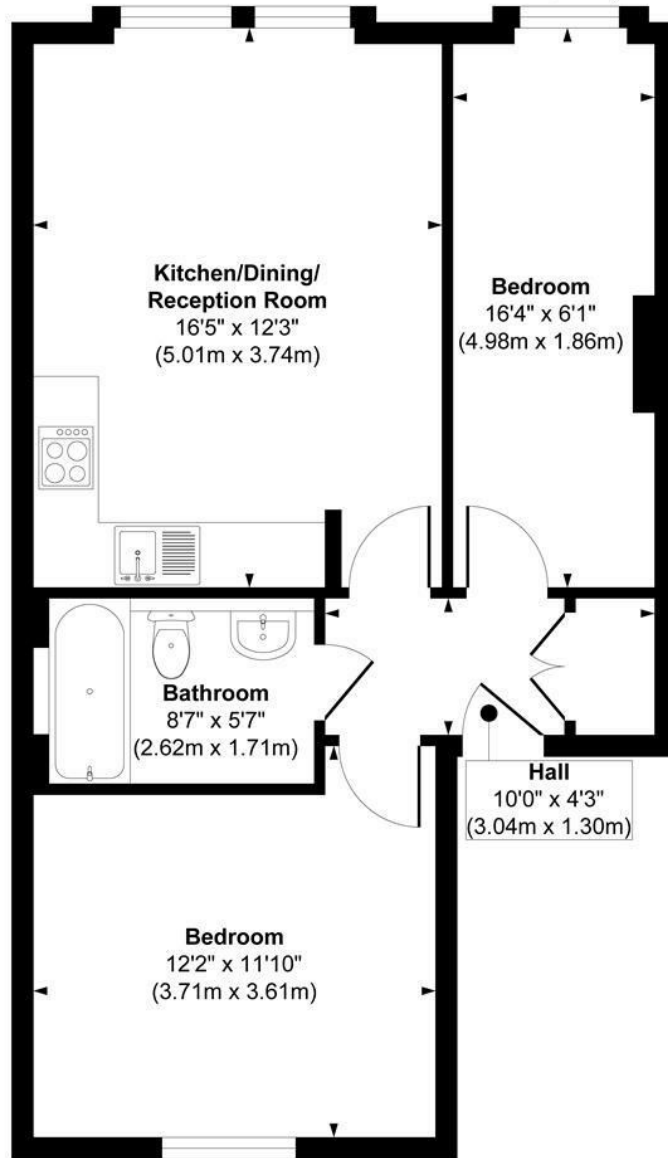

Second Floor

Approx. Gross Internal Floor Area 546 sq. ft / 50.74 sq. m

Illustration for identification purposes only, measurements are approximate, not to scale.
Produced by Elements Property

Council Tax Band

Energy Performance Graph

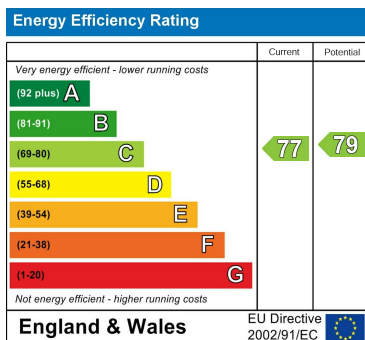

Call us on

0203 822 0111

hello@alexandersteer.co.uk

alexandersteer.co.uk



©ALEXANDERSTEERPROPERTY

Agents Note: Whilst every care has been taken to prepare these particulars, they are for guidance purposes only. All measurements are approximate and are for general guidance purposes only and whilst every care has been taken to ensure their accuracy, they should not be relied upon and potential buyers are advised to recheck the measurements.