



See More Online

KFB: Key Facts For Buyers

A Guide to This Property & the Local Area

Monday 09th February 2026

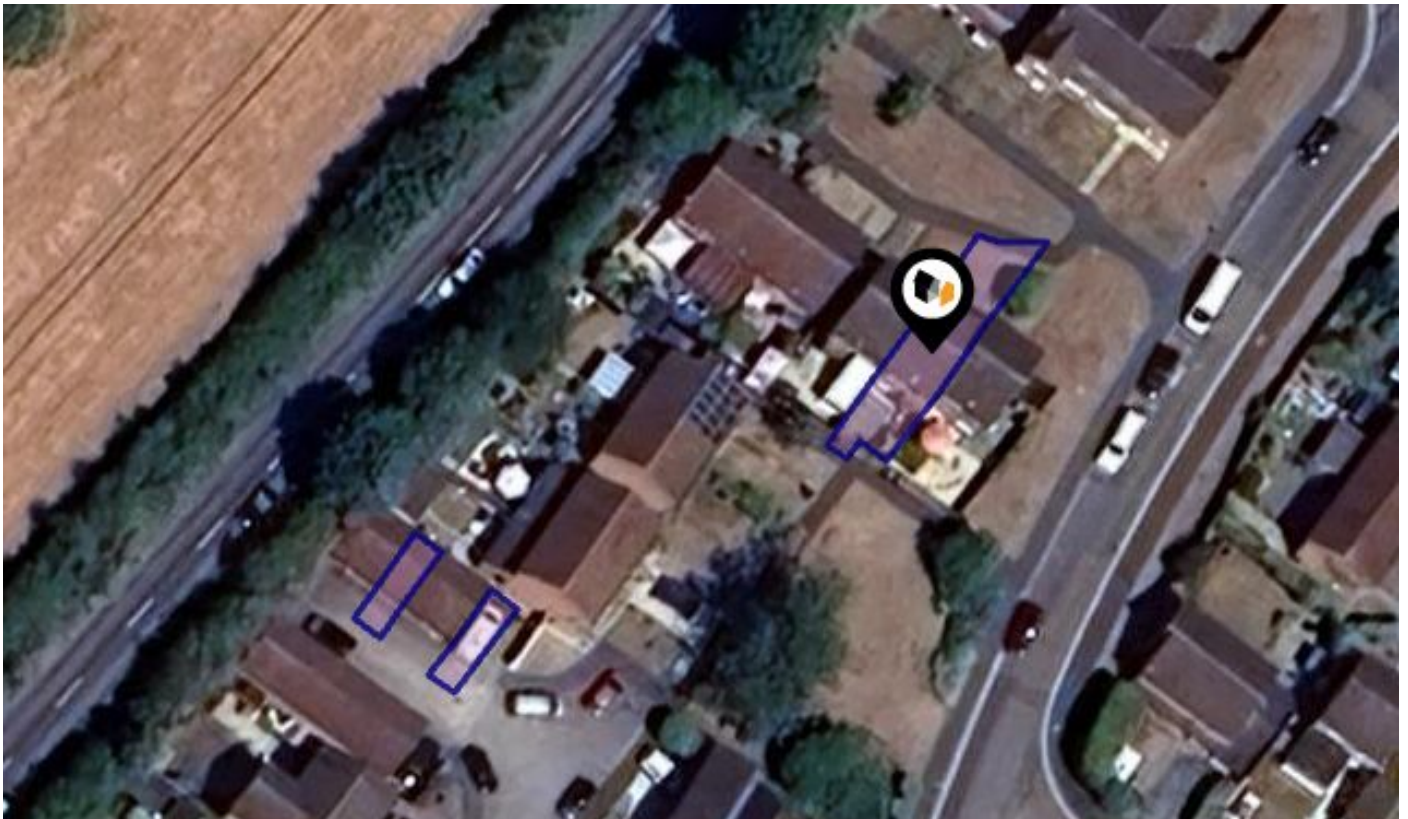

DRYDEN AVENUE, BICESTER, OX26

Avocado Property

07894820821

alistair@avocadopropertyagents.co.uk

www.avocadopropertyagents.co.uk



Powered by
aprift
Know any property instantly

Introduction

Our Comments



Seller's comments...

We have loved living here for the past four years. Starting off as our first family home It has seen all of our children grow from babies to school age and allowed us to create magical memories but now is the time for our next chapter. This has been a wonderful family home for us, offering a comfortable and welcoming space in a quiet, friendly area of Bicester. The house provides generous living space, with well-proportioned bedrooms and a layout that works perfectly for both everyday living and entertaining. We've especially loved the peaceful surroundings while still being close to local schools, shops, and transport links. It's a home that feels calm, safe, and easy to live in, and we will be sad to leave, but we hope the next owners will enjoy it just as much as we have.

Agent's comments...

A three bedroom home overlooking a green, located on the popular Shakespeare Estate and within close proximity to Kings Meadow Primary School, which is rated Good by Ofsted.

The property offers an open plan lounge/diner providing a flexible living and dining space. The fitted kitchen is positioned to the rear of the house and offers practical storage and worktop space.

Upstairs, there are three bedrooms served by a family bathroom.

Outside, the home benefits from pleasant views over a green to the front. Parking is provided via an allocated space and a garage located in a nearby block.

An ideal opportunity for first-time buyers, families or investors looking for a well-located home close to local amenities and schooling.

Property Overview

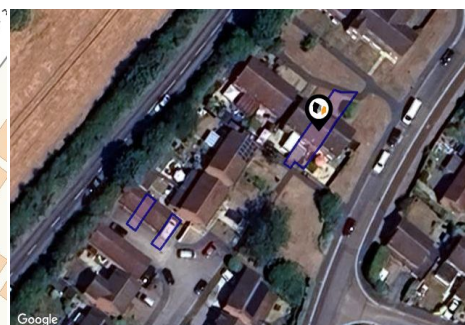
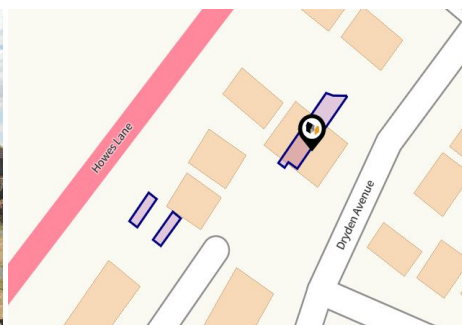

Property

Type:	Terraced	Tenure:	Freehold
Bedrooms:	3		
Floor Area:	721 ft ² / 67 m ²		
Plot Area:	0.05 acres		
Year Built :	1976-1982		
Council Tax :	Band C		
Annual Estimate:	£2,190		
Title Number:	ON168320		

Local Area

Local Authority:	Oxfordshire
Conservation Area:	No
Flood Risk:	
• Rivers & Seas	Very low
• Surface Water	Very low

Estimated Broadband Speeds

(Standard - Superfast - Ultrafast)

6	57	1000
mb/s	mb/s	mb/s

Mobile Coverage:

(based on calls indoors)



Satellite/Fibre TV Availability:







DRYDEN AVENUE, BICESTER, OX26

GROUND FLOOR

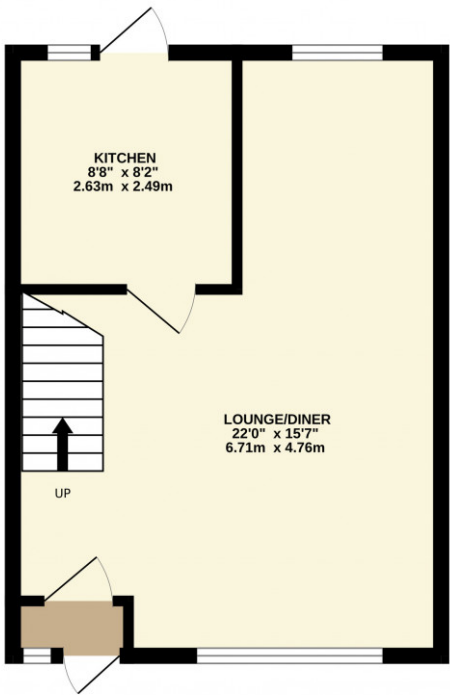

1ST FLOOR

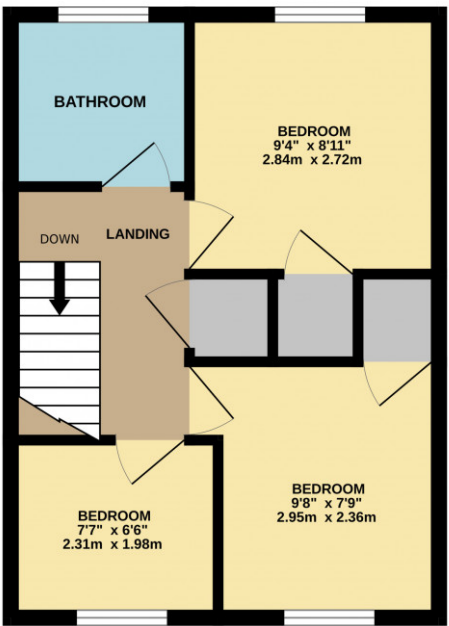

Whilst every attempt has been made to ensure the accuracy of the floorplan contained here, measurements of doors, windows, rooms and any other items are approximate and no responsibility is taken for any error, omission or mis-statement. This plan is for illustrative purposes only and should be used as such by any prospective purchaser. The services, systems and appliances shown have not been tested and no guarantee as to their operability or efficiency can be given.
Made with Metropix ©2026

Property EPC - Certificate

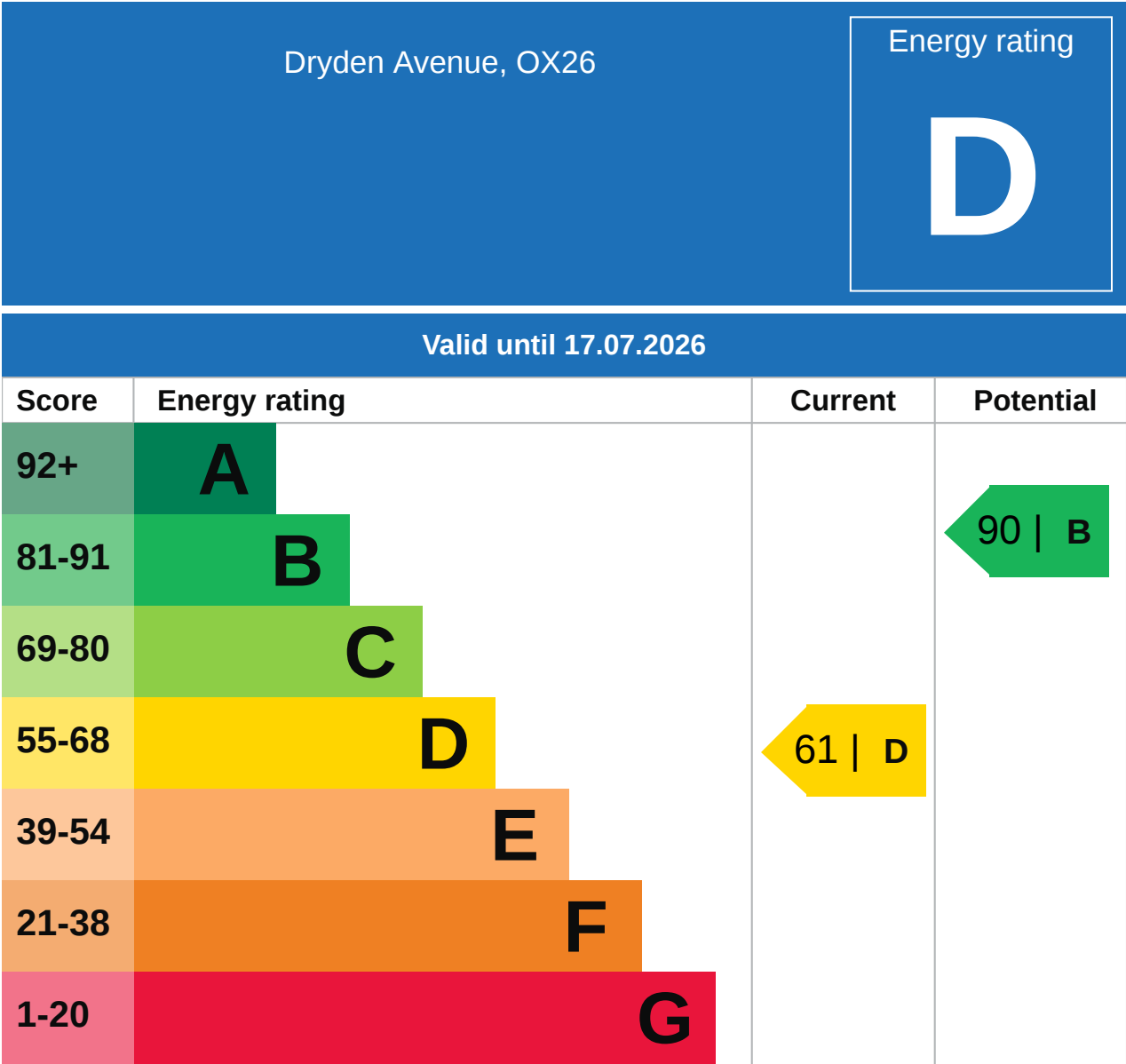

Property

EPC - Additional Data



Additional EPC Data

Property Type:	House
Build Form:	Mid-Terrace
Transaction Type:	Marketed sale
Energy Tariff:	Single
Main Fuel:	Mains gas (not community)
Main Gas:	Yes
Glazing Type:	Double glazing installed during or after 2002
Previous Extension:	0
Open Fireplace:	0
Ventilation:	Natural
Walls:	Cavity wall, as built, partial insulation (assumed)
Walls Energy:	Average
Roof:	Pitched, 75 mm loft insulation
Roof Energy:	Average
Main Heating:	Boiler and radiators, mains gas
Main Heating Controls:	Programmer and room thermostat
Hot Water System:	From main system
Hot Water Energy Efficiency:	Average
Lighting:	Low energy lighting in 33% of fixed outlets
Floors:	Solid, no insulation (assumed)
Total Floor Area:	67 m ²

Market

House Price Statistics



10 Year History of Average House Prices by Property Type in OX26

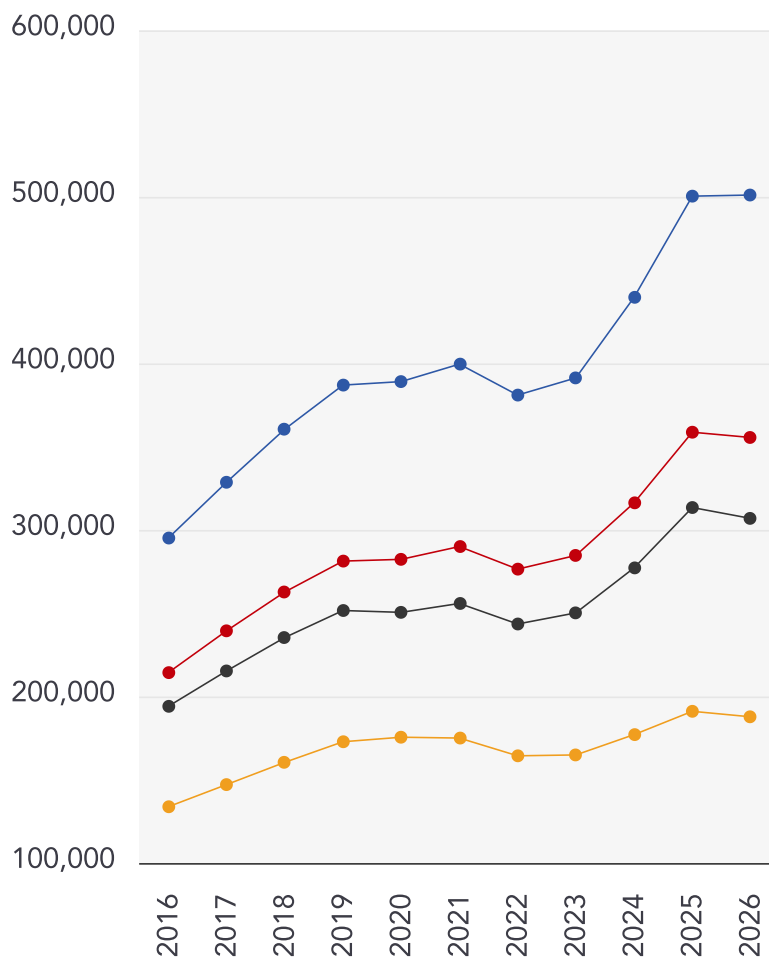

Detached

+69.78%

Semi-Detached

+65.88%

Terraced

+58.14%

Flat

+40.36%

Maps

Coal Mining



This map displays nearby coal mine entrances and their classifications.

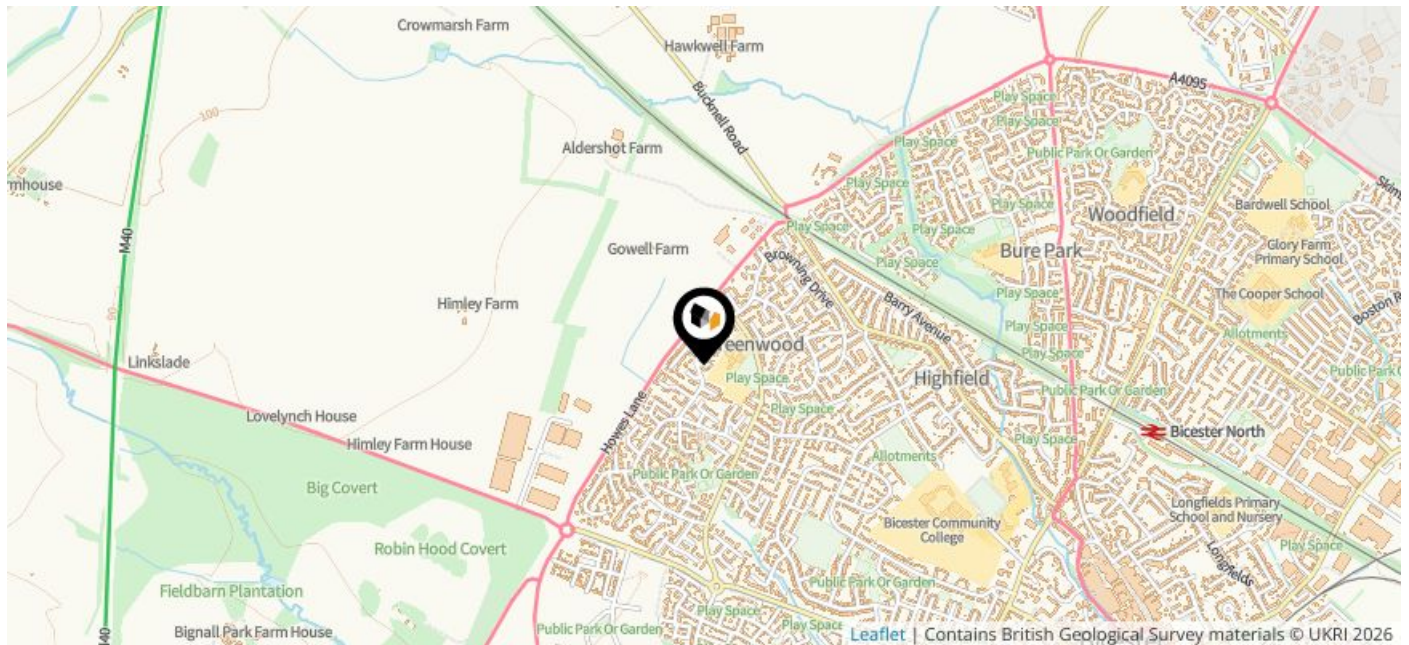

Mine Entry

- ✕ Adit
- ✕ Gutter Pit
- ✕ Shaft

The Coal Authority has records of over 175,000 mine entries within the UK captured in the National Coal Mining database, derived from sources including abandonment plans, geological and topographical plans.

Coal mining activity is recorded as far back as the 13th century, but prior to 1872 there was no requirement to deposit abandonment plans. It is therefore believed there may be many unrecorded mine entries of which the Authority has no information or knowledge. These entries do not, therefore, appear within the Authority's national dataset as shown on this map.

Maps

Conservation Areas



This map displays nearby official conservation areas. Every local authority in England has at least one conservation area. Most are designated by the Council as the local planning authority, though Historic England and the Secretary of State also have the power to create them.

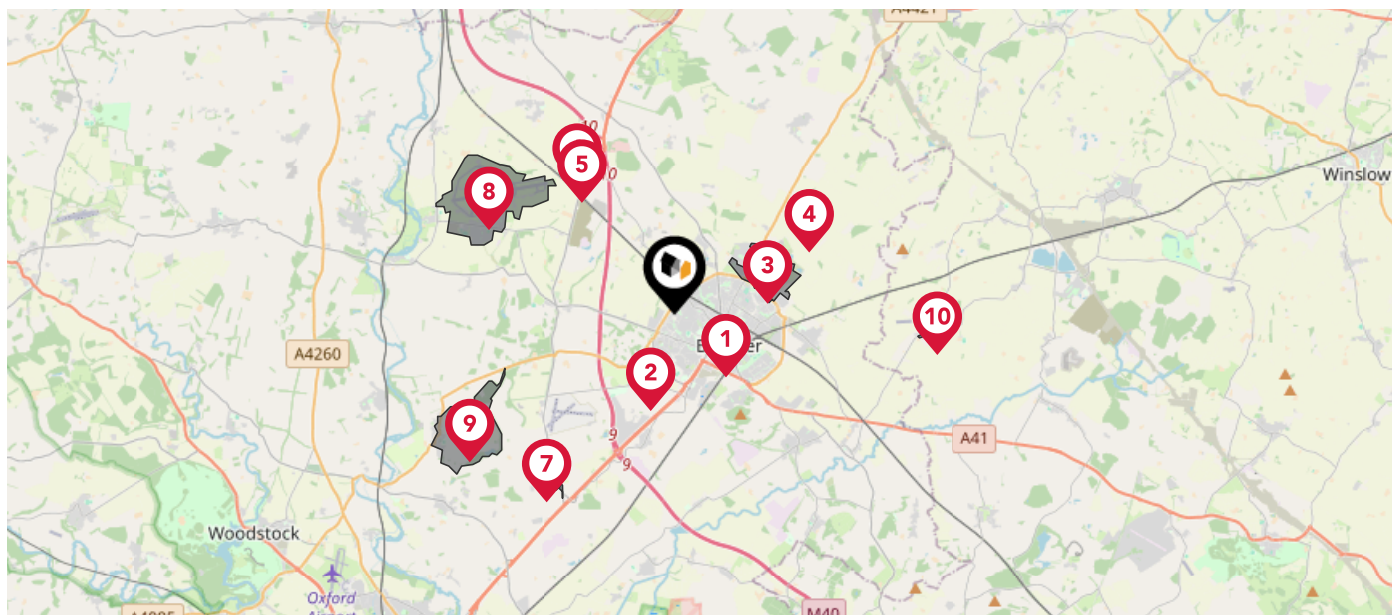

Nearby Conservation Areas



Bicester



Chesterton



RAF Bicester



Stratton Audley



Ardley



Fewcott



Weston on the Green



RAF Upper Heyford



Kirtlington



Marsh Gibbon

Maps







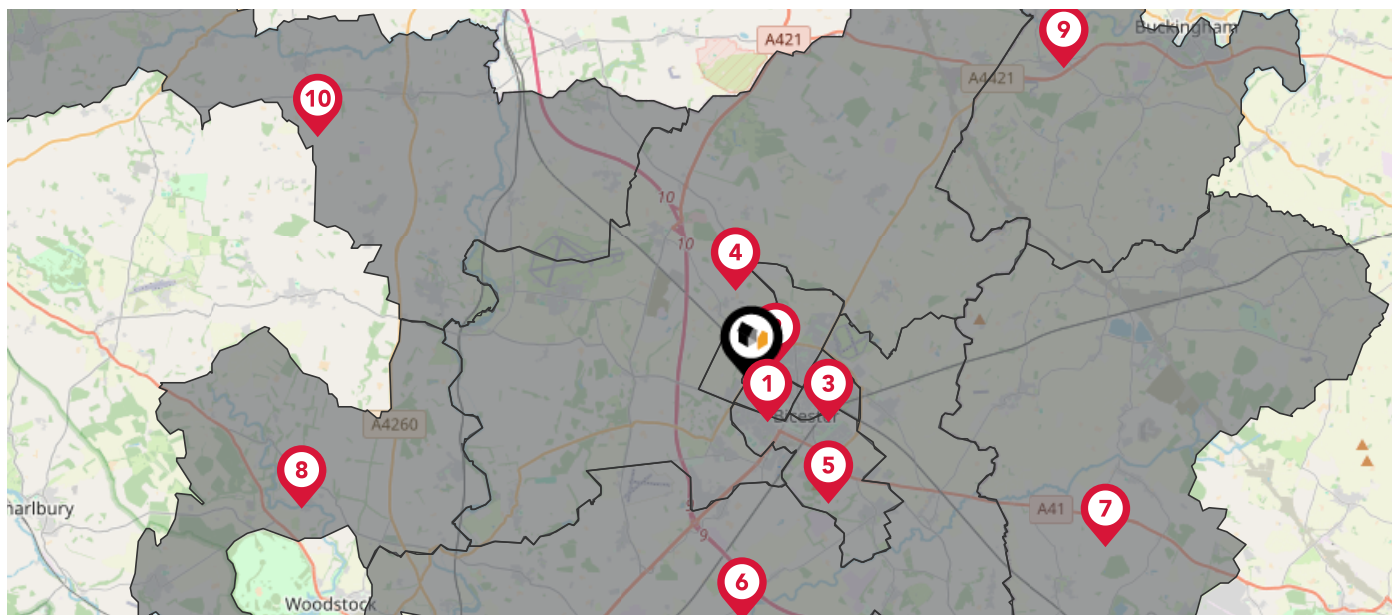



Council Wards



The UK is divided into wards that are used for local elections to elect local government councillors. Sometimes these are known as 'electoral divisions'. Population counts can vary substantially between wards, but the national average is about 5,500



Nearby Council Wards

-  1 Bicester West Ward
-  2 Bicester North & Caversfield Ward
-  3 Bicester East Ward
-  4 Fringford & Heyfords Ward
-  5 Bicester South & Ambrosden Ward
-  6 Launton & Otmoor Ward
-  7 Grendon Underwood Ward
-  8 Stonesfield and Tackley Ward
-  9 Buckingham West Ward
-  10 Deddington Ward

Maps

Rail Noise



This map displays the noise levels from nearby network rail and HS1 railway routes that affect this property...

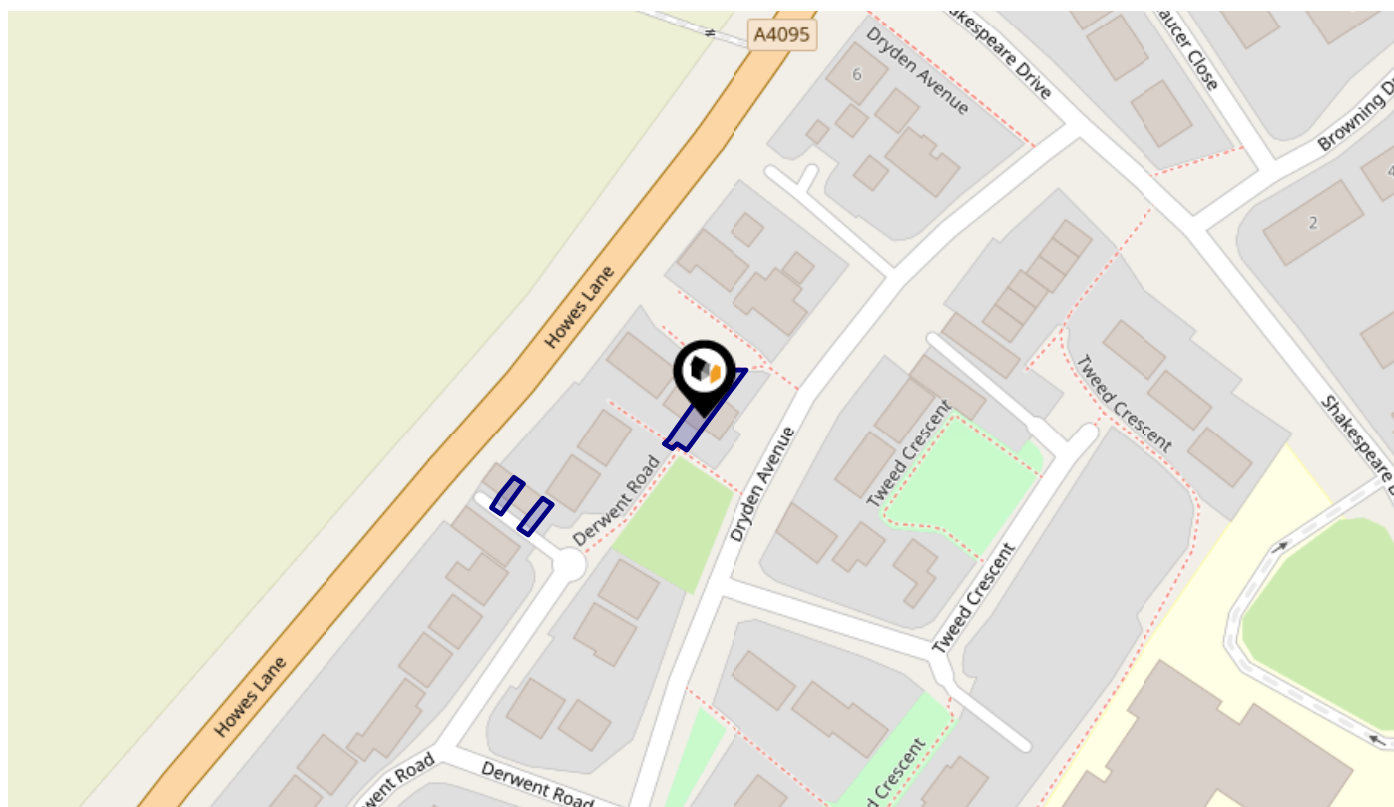

Rail Noise Data

This data indicates the level of noise according to the strategic noise mapping of rail sources within areas with a population of at least 100,000 people (agglomerations) and along Network Rail and HS1 traffic routes.

The data indicates the annual average noise levels for the 16-hour period between 0700 - 2300.

Noise levels are modelled on a 10m grid at a receptor height of 4m above ground, polygons are then produced by merging neighbouring cells within the following noise classes:

5		75.0+ dB	
4		70.0-74.9 dB	
3		65.0-69.9 dB	
2		60.0-64.9 dB	
1		55.0-59.9 dB	

Flood Risk

Rivers & Seas - Flood Risk



This map shows the chance of flooding from rivers and / or the sea, taking into account flood defences and their condition.

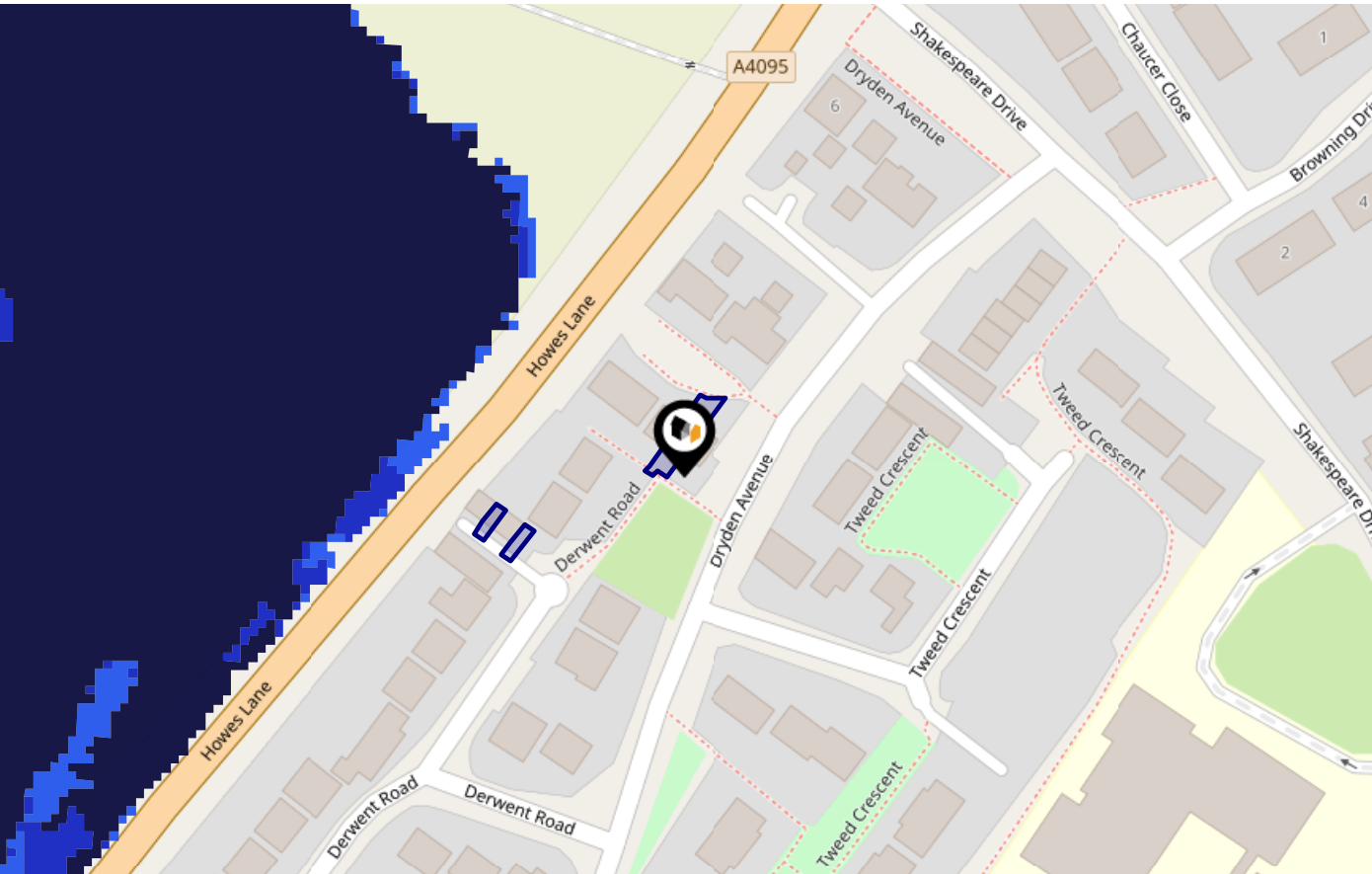

Risk Rating: Very low

The map does not contain sufficient information for it to be used to determine flood risk to individual properties, but it does give you an indication of whether your area may be affected by surface water flooding at this risk level.

- High Risk** - an area which has a chance of flooding of greater than 1 in 30 (3.3%) in any one year.
- Medium Risk** - an area which has a chance of flooding of greater than 1 in 100 (1.0%) in any one year.
- Low Risk** - an area which has a chance of flooding of greater than 1 in 1000 (0.1%) in any one year.
- Very Low Risk** - an area in which the risk is below 1 in 1000 (0.1%) in any one year.

Chance of flooding to the following depths at this property:

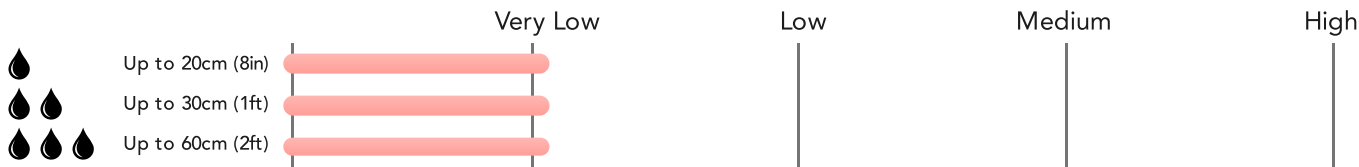

Flood Risk

Rivers & Seas - Climate Change



This map shows the future chance of flooding from rivers and / or the sea **between 2036 and 2069**, taking into account flood defences and their condition. The government climate change models cannot predict exactly when the chance of flooding will go up. It could happen at any time during the time period.

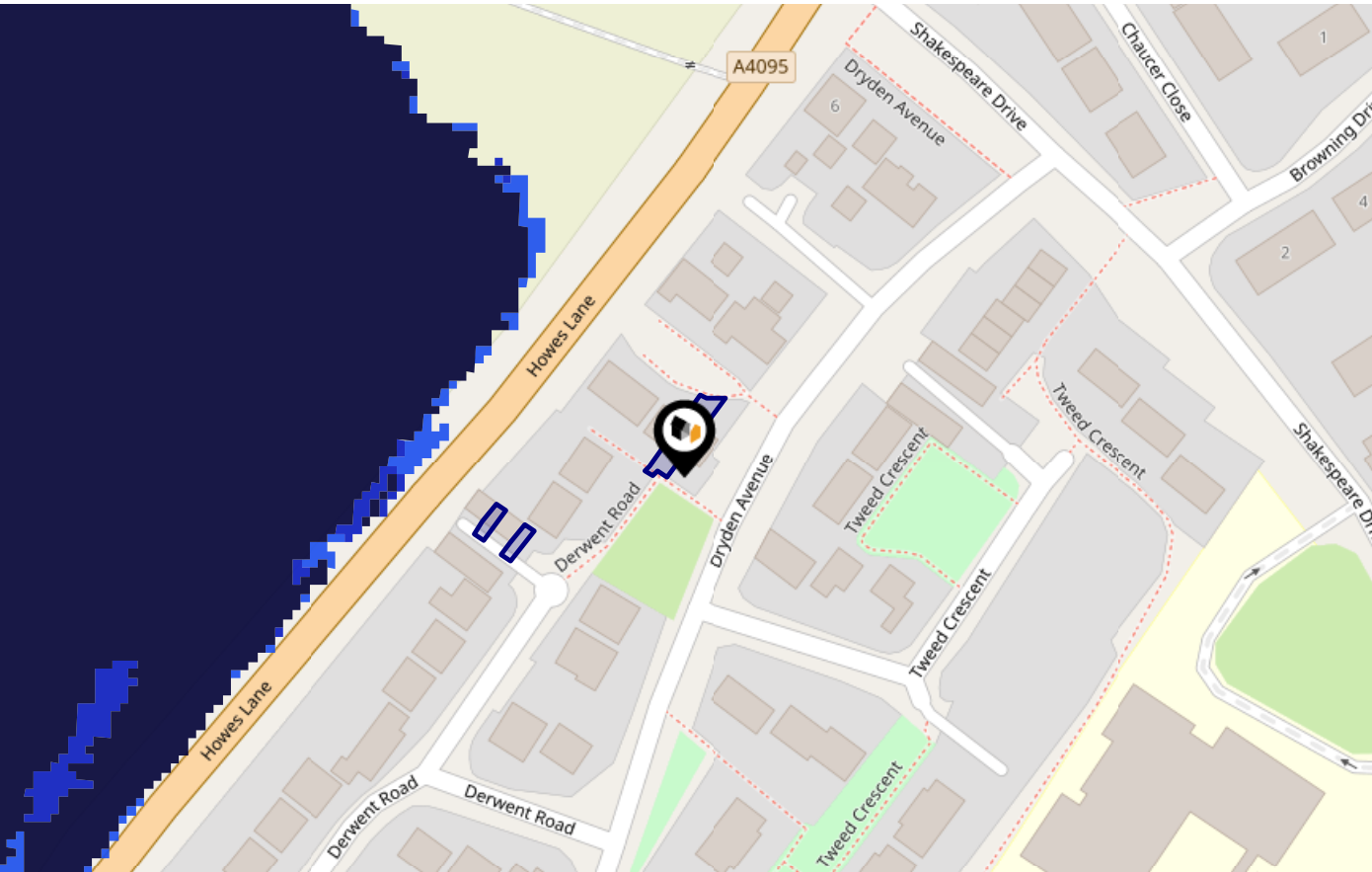

Risk Rating: Very low

The map does not contain sufficient information for it to be used to determine flood risk to individual properties, but it does give you an indication of whether your area may be affected by surface water flooding at this risk level.

- High Risk** - an area which has a chance of flooding of greater than 1 in 30 (3.3%) in any one year.
- Medium Risk** - an area which has a chance of flooding of greater than 1 in 100 (1.0%) in any one year.
- Low Risk** - an area which has a chance of flooding of greater than 1 in 1000 (0.1%) in any one year.
- Very Low Risk** - an area in which the risk is below 1 in 1000 (0.1%) in any one year.

Chance of flooding to the following depths at this property:

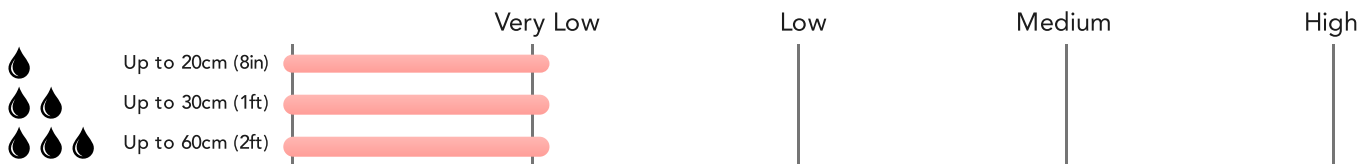

Flood Risk

Surface Water - Flood Risk



This map shows the chance of flooding where rainwater has nowhere to drain. This kind of flooding can occur far from rivers or seas.

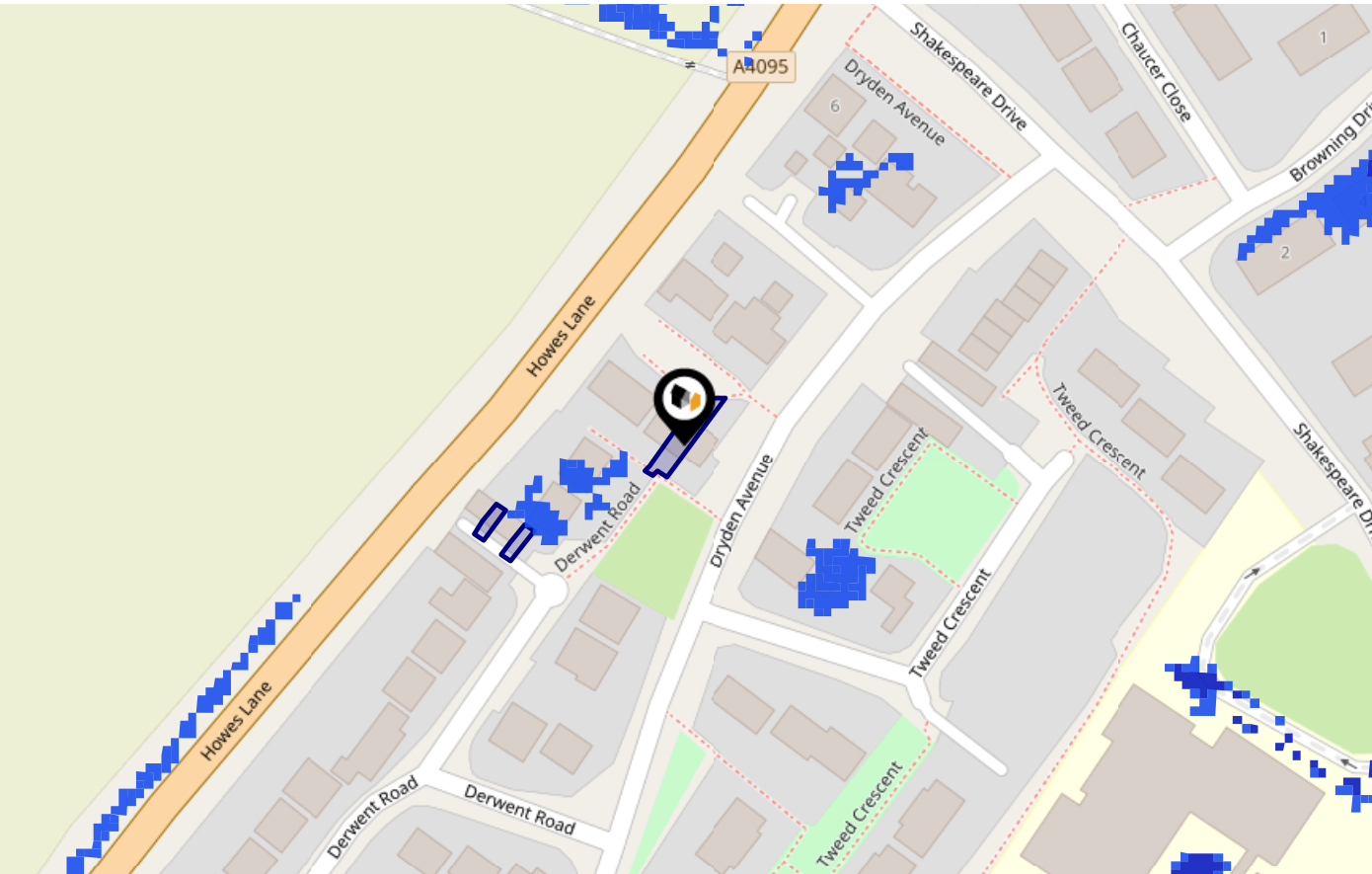

Risk Rating: Very low

The map does not contain sufficient information for it to be used to determine flood risk to individual properties, but it does give you an indication of whether your area may be affected by surface water flooding at this risk level.

- High Risk** - an area which has a chance of flooding of greater than 1 in 30 (3.3%) in any one year.
- Medium Risk** - an area which has a chance of flooding of greater than 1 in 100 (1.0%) in any one year.
- Low Risk** - an area which has a chance of flooding of greater than 1 in 1000 (0.1%) in any one year.
- Very Low Risk** - an area in which the risk is below 1 in 1000 (0.1%) in any one year.

Chance of flooding to the following depths at this property:

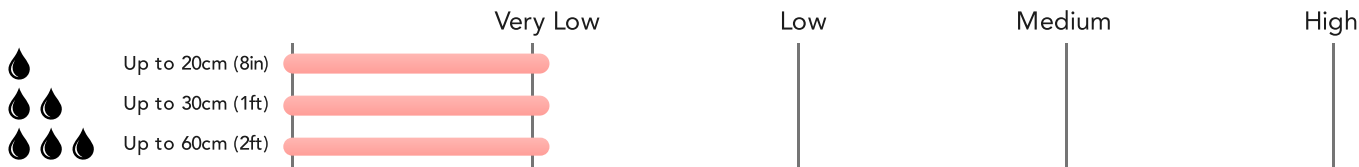

Flood Risk

Surface Water - Climate Change



This map shows the future chance of flooding **between 2040 and 2060** where rainwater has nowhere to drain. This kind of flooding can occur far from rivers or seas. The government climate change models cannot predict exactly when the chance of flooding will go up. It could happen at any time during the time period.

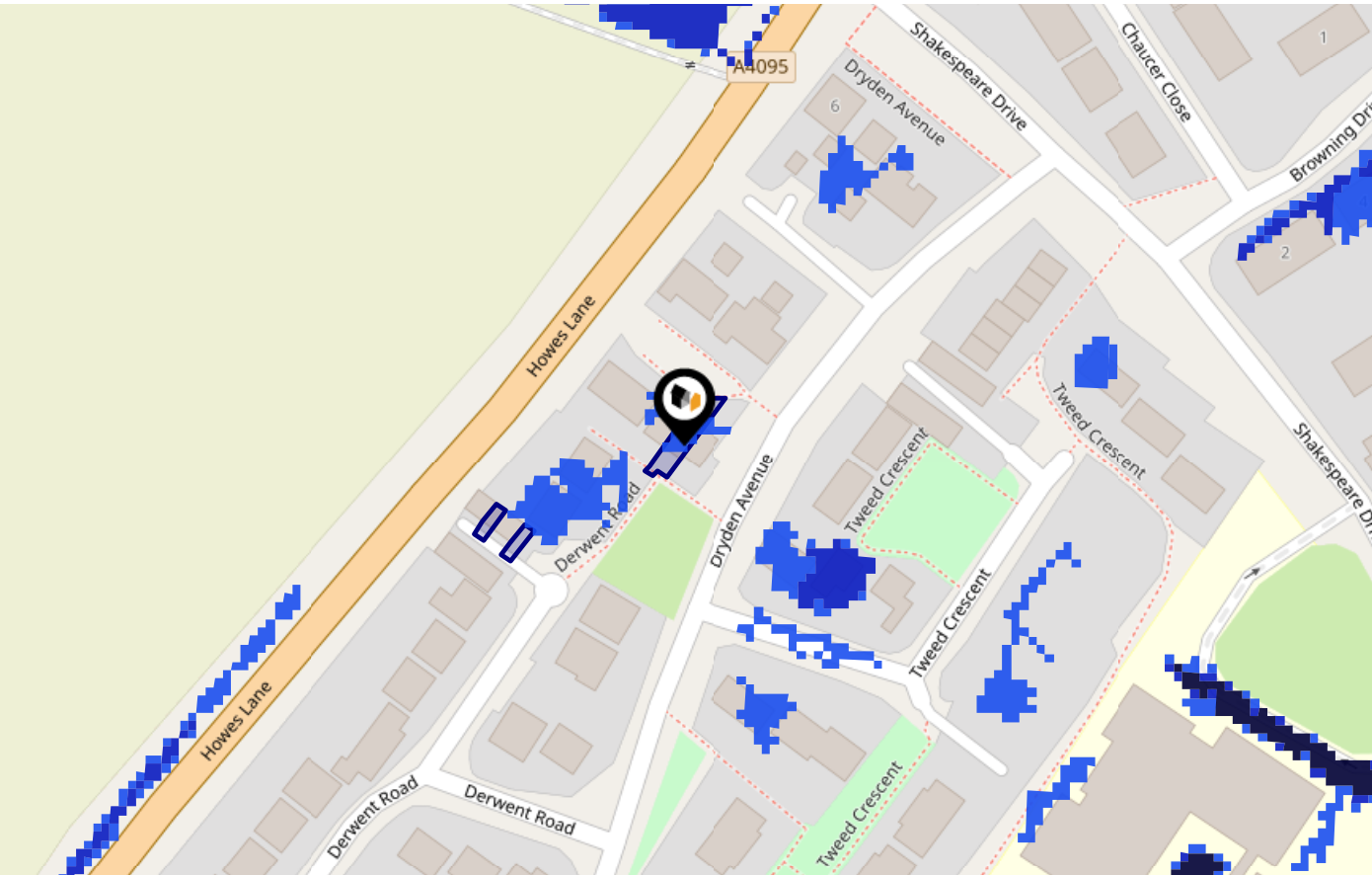

Risk Rating: Low

The map does not contain sufficient information for it to be used to determine flood risk to individual properties, but it does give you an indication of whether your area may be affected by surface water flooding at this risk level.

- High Risk** - an area which has a chance of flooding of greater than 1 in 30 (3.3%) in any one year.
- Medium Risk** - an area which has a chance of flooding of greater than 1 in 100 (1.0%) in any one year.
- Low Risk** - an area which has a chance of flooding of greater than 1 in 1000 (0.1%) in any one year.
- Very Low Risk** - an area in which the risk is below 1 in 1000 (0.1%) in any one year.

Chance of flooding to the following depths at this property:

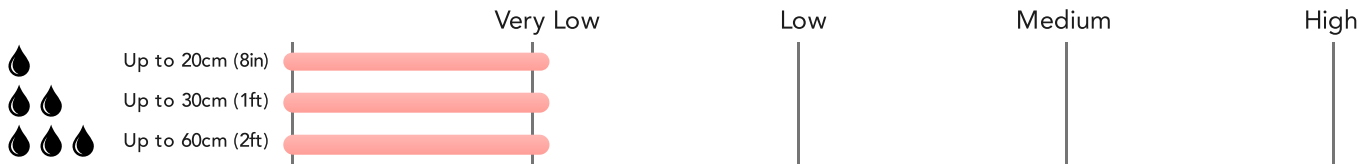

Maps

Green Belt



This map displays nearby areas that have been designated as Green Belt...

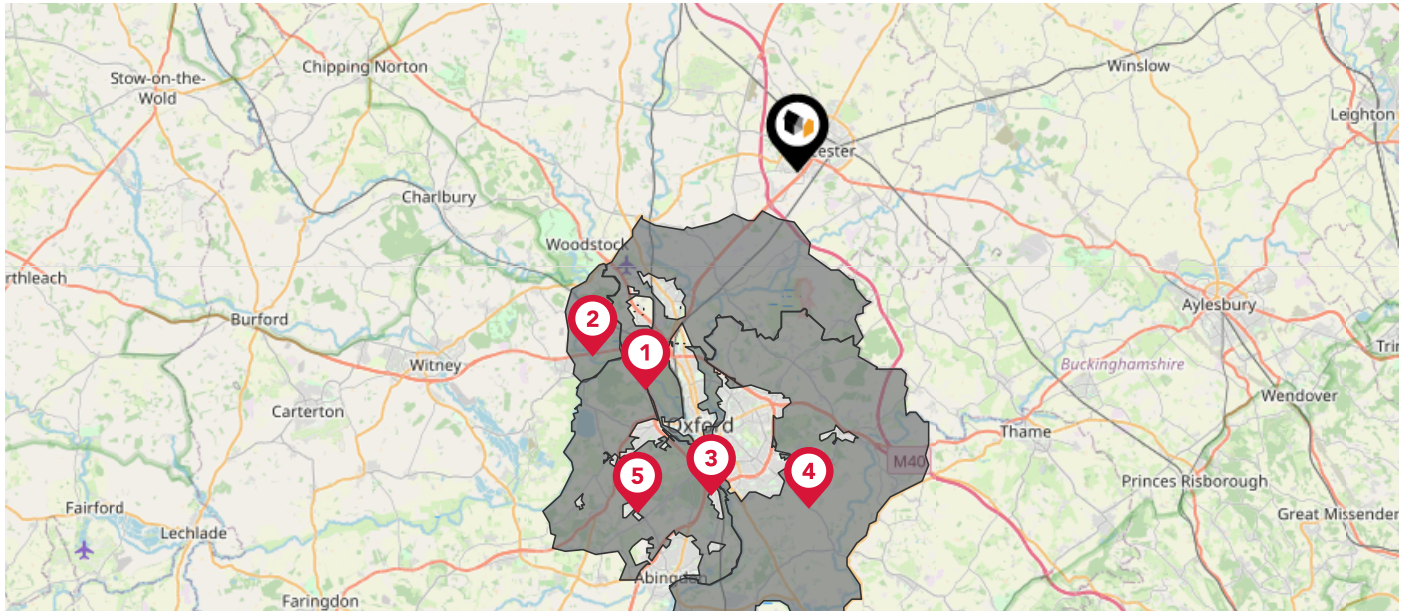

Nearby Green Belt Land



Oxford Green Belt - Cherwell



Oxford Green Belt - West Oxfordshire



Oxford Green Belt - Oxford



Oxford Green Belt - South Oxfordshire



Oxford Green Belt - Vale of White Horse

Maps

Landfill Sites



This map displays the location of known landfill sites. Historic sites are where there is no environmental permit in force. Active sites are currently authorised by the Environment Agency under Environmental Permitting Regulations.



Nearby Landfill Sites

1	Gowell Farm-Bicester, Oxfordshire	Historic Landfill
2	Bucknell Lodge Farm M40-Middleton Stoney, Bicester, Oxfordshire	Historic Landfill
3	London Road-Bicester, Oxfordshire	Historic Landfill
4	Ardley Quarry Inert Area-Ardley, Bicester, Oxfordshire	Historic Landfill
5	Ardley Fields Farm 2-Ardley, Bicester, Oxfordshire	Historic Landfill
6	Disused Tip at Elm Farm Quarry-Stratton Audley, Oxfordshire	Historic Landfill
7	No name provided by source	Active Landfill
8	EA/EPR/VP3999EL/V003 - Mr T Williams	Active Landfill
9	Ardley Wood-Ardley, Oxfordshire	Historic Landfill
10	Ardley Wood-Ardley, Oxfordshire	Historic Landfill









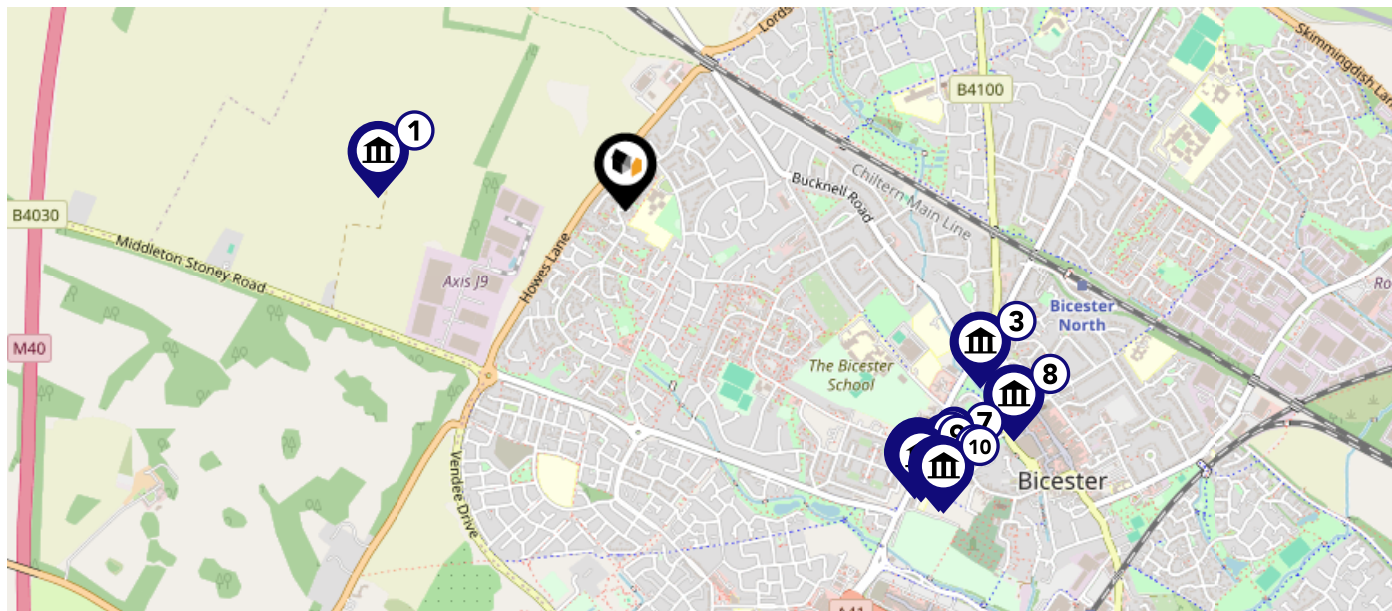

Maps

Listed Buildings



This map displays nearby listed buildings and protected structures, as well as their listed tier and distance from the target property...



Listed Buildings in the local district	Grade	Distance
 1046883 - 2 Barns Approximately 700 Metres North East Of Hinley Farmhouse, Chesterton (not Included)	Grade II	0.5 miles
 1300945 - 20, Kings End	Grade II	0.9 miles
 1283136 - 5 And 7, Field Street	Grade II	0.9 miles
 1046490 - 22 And 24, Kings End	Grade II	0.9 miles
 1369764 - The Fox Inn	Grade II	0.9 miles
 1200065 - Stable Approximately 5 Metres To South West Of Home Farmhouse	Grade II	1.0 miles
 1046489 - Bicester House	Grade II	1.0 miles
 1300691 - 75, Sheep Street	Grade II	1.0 miles
 1200078 - Oxford House	Grade II	1.0 miles
 1046491 - Home Farmhouse	Grade II	1.0 miles

Area Schools



		Nursery	Primary	Secondary	College	Private
1	King's Meadow Primary School Ofsted Rating: Good Pupils: 445 Distance:0.15	<input type="checkbox"/>	<input checked="" type="checkbox"/>	<input type="checkbox"/>	<input type="checkbox"/>	<input type="checkbox"/>
2	Bure Park Primary School Ofsted Rating: Good Pupils: 415 Distance:0.7	<input type="checkbox"/>	<input checked="" type="checkbox"/>	<input type="checkbox"/>	<input type="checkbox"/>	<input type="checkbox"/>
3	The Bicester School Ofsted Rating: Good Pupils: 1239 Distance:0.73	<input type="checkbox"/>	<input type="checkbox"/>	<input checked="" type="checkbox"/>	<input type="checkbox"/>	<input type="checkbox"/>
4	Brookside Primary School Ofsted Rating: Good Pupils: 320 Distance:0.76	<input type="checkbox"/>	<input checked="" type="checkbox"/>	<input type="checkbox"/>	<input type="checkbox"/>	<input type="checkbox"/>
5	St Mary's Catholic Primary School, Bicester Ofsted Rating: Good Pupils: 229 Distance:0.82	<input type="checkbox"/>	<input checked="" type="checkbox"/>	<input type="checkbox"/>	<input type="checkbox"/>	<input type="checkbox"/>
6	Gagle Brook Primary School Ofsted Rating: Good Pupils: 164 Distance:0.96	<input type="checkbox"/>	<input checked="" type="checkbox"/>	<input type="checkbox"/>	<input type="checkbox"/>	<input type="checkbox"/>
7	Southwold Primary School Ofsted Rating: Good Pupils: 350 Distance:1.05	<input type="checkbox"/>	<input checked="" type="checkbox"/>	<input type="checkbox"/>	<input type="checkbox"/>	<input type="checkbox"/>
8	St Edburg's Church of England (VA) School Ofsted Rating: Good Pupils: 489 Distance:1.08	<input type="checkbox"/>	<input checked="" type="checkbox"/>	<input type="checkbox"/>	<input type="checkbox"/>	<input type="checkbox"/>

Area Schools

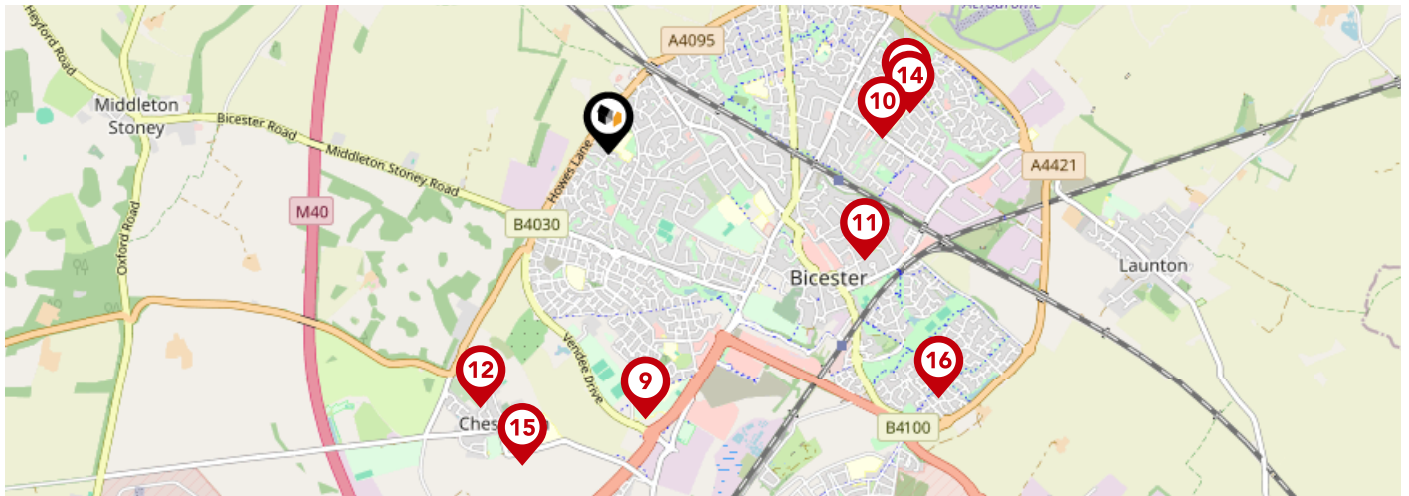

		Nursery	Primary	Secondary	College	Private
	Whitelands Academy Ofsted Rating: Good Pupils: 467 Distance:1.22	<input type="checkbox"/>	<input type="checkbox"/>	<input checked="" type="checkbox"/>	<input type="checkbox"/>	<input type="checkbox"/>
	The Cooper School Ofsted Rating: Requires improvement Pupils: 1272 Distance:1.25	<input type="checkbox"/>	<input type="checkbox"/>	<input checked="" type="checkbox"/>	<input type="checkbox"/>	<input type="checkbox"/>
	Longfields Primary and Nursery School Ofsted Rating: Good Pupils: 388 Distance:1.27	<input type="checkbox"/>	<input checked="" type="checkbox"/>	<input type="checkbox"/>	<input type="checkbox"/>	<input type="checkbox"/>
	Chesterton Church of England Voluntary Aided Primary School Ofsted Rating: Good Pupils: 195 Distance:1.31	<input type="checkbox"/>	<input checked="" type="checkbox"/>	<input type="checkbox"/>	<input type="checkbox"/>	<input type="checkbox"/>
	Bardwell School Ofsted Rating: Good Pupils: 113 Distance:1.38	<input type="checkbox"/>	<input type="checkbox"/>	<input checked="" type="checkbox"/>	<input type="checkbox"/>	<input type="checkbox"/>
	Glory Farm Primary School Ofsted Rating: Good Pupils: 344 Distance:1.39	<input type="checkbox"/>	<input checked="" type="checkbox"/>	<input type="checkbox"/>	<input type="checkbox"/>	<input type="checkbox"/>
	Bruern Abbey School Ofsted Rating: Not Rated Pupils: 201 Distance:1.48	<input type="checkbox"/>	<input type="checkbox"/>	<input checked="" type="checkbox"/>	<input type="checkbox"/>	<input type="checkbox"/>
	Langford Village Community Primary School Ofsted Rating: Good Pupils: 421 Distance:1.87	<input type="checkbox"/>	<input checked="" type="checkbox"/>	<input type="checkbox"/>	<input type="checkbox"/>	<input type="checkbox"/>

Local Area

Masts & Pylons

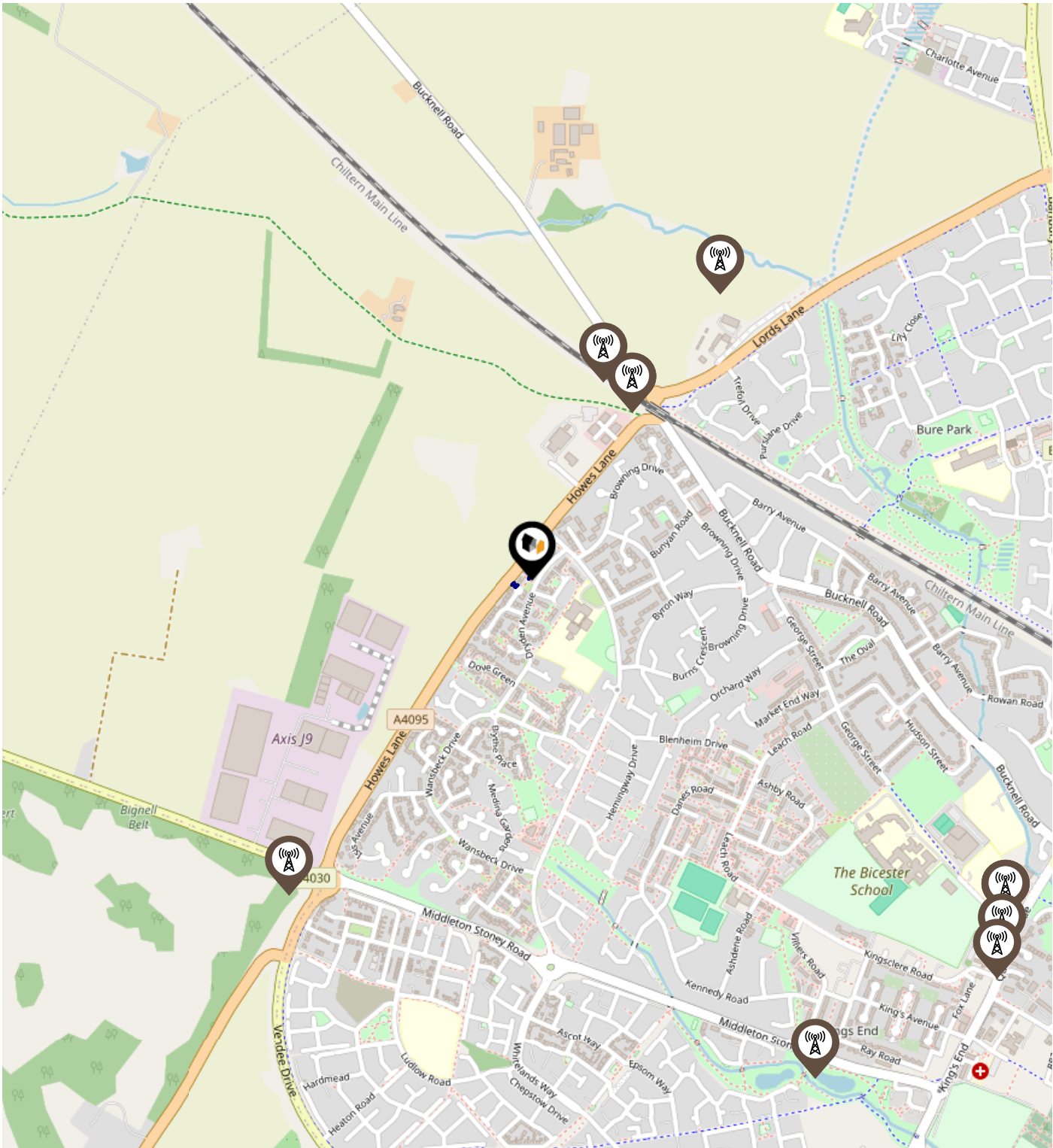

Key:

- Power Pylons
- Communication Masts

Environment

Radon Gas



What is Radon?

Radon is a natural radioactive gas, which enters buildings from the ground. Exposure to high concentrations increases the risk of lung cancer. The UK Health Security Agency (UKHSA) recommends that radon levels should be reduced in homes where the annual average is at or above 200 becquerels per cubic metre (200 Bq/m³).

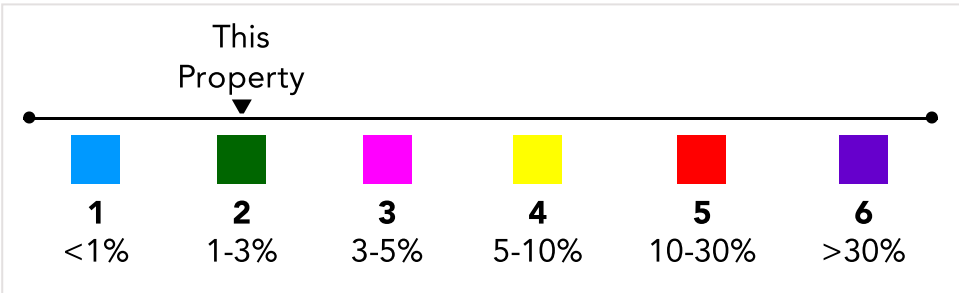
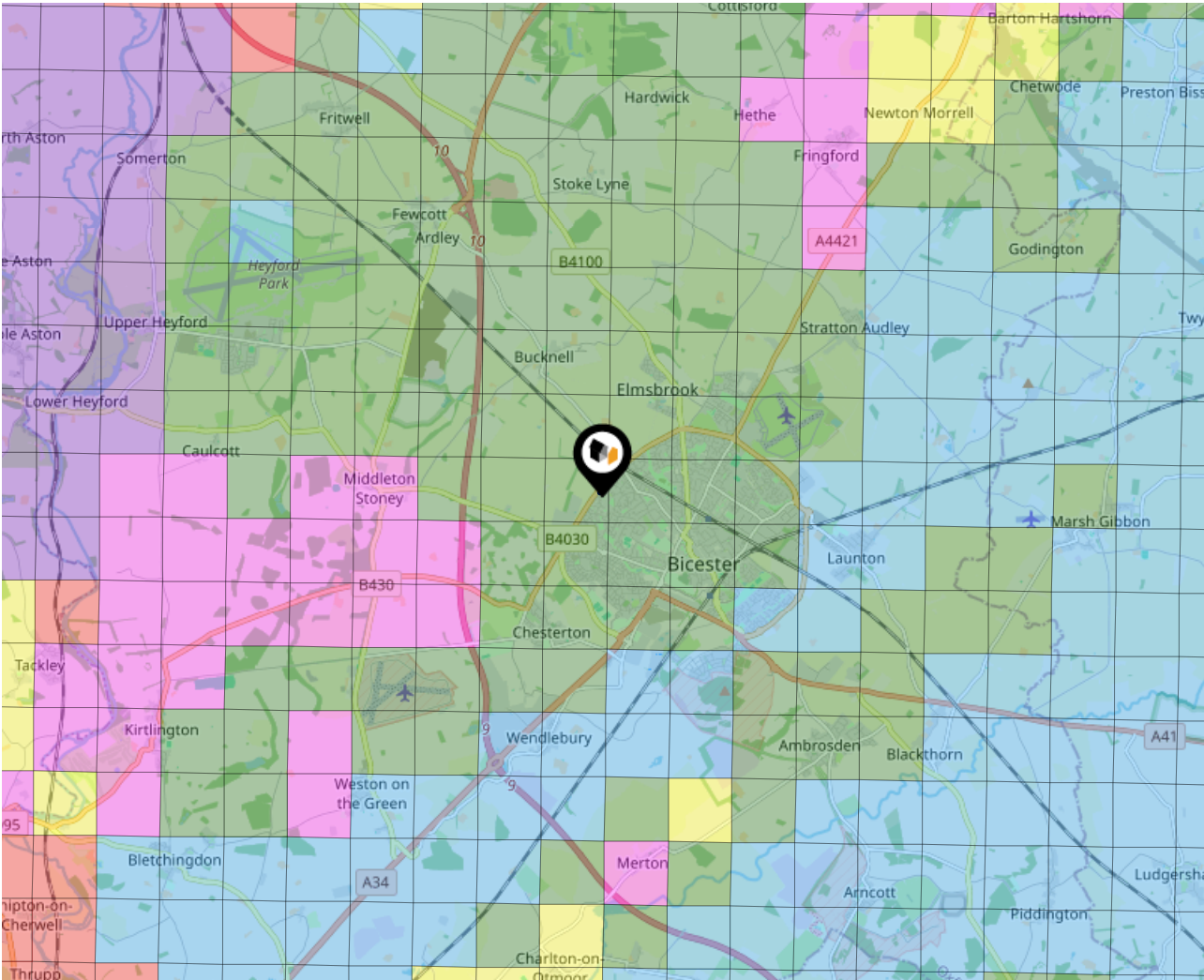

Local Area Road Noise

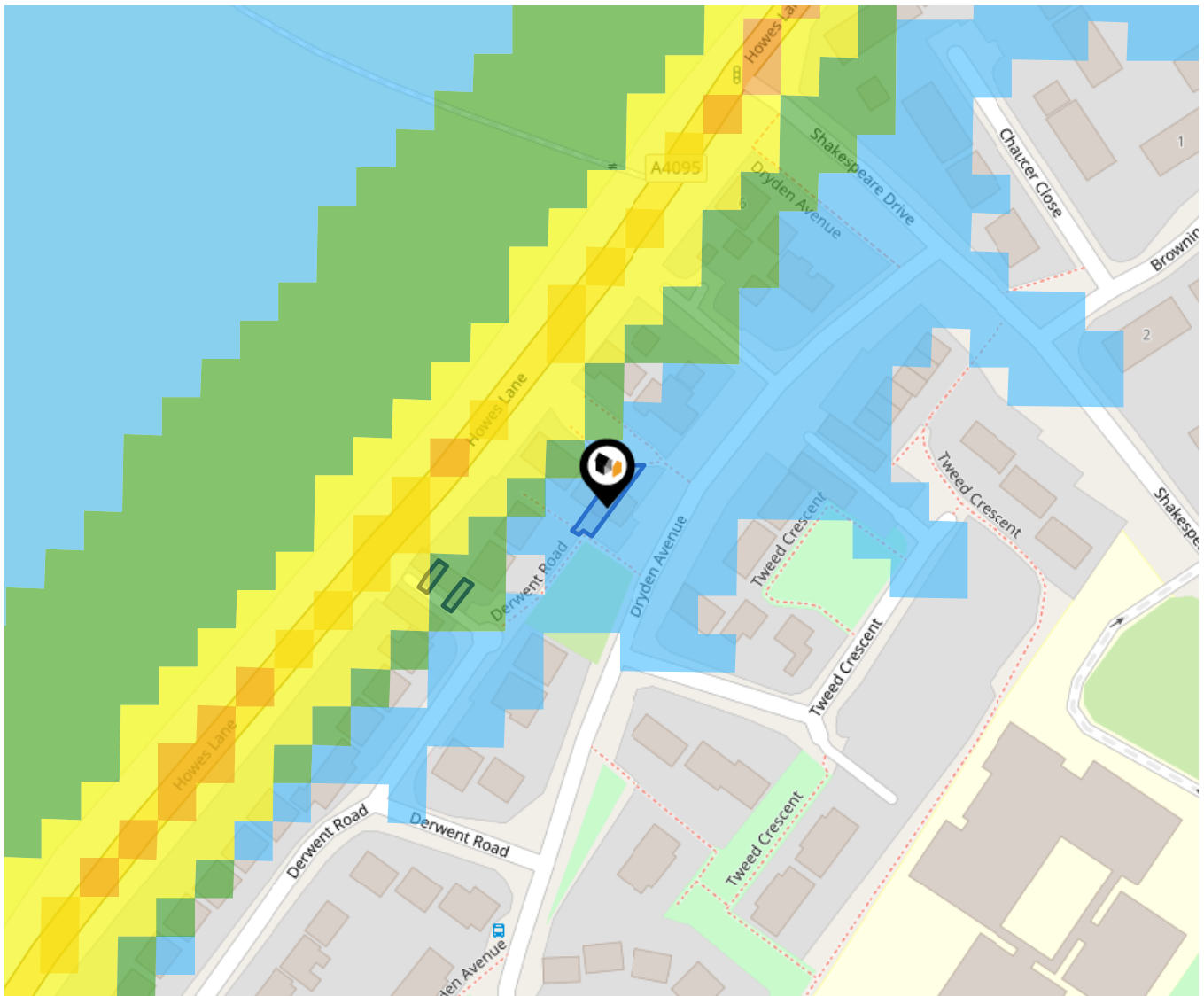

This data indicates the level of noise according to the strategic noise mapping of road sources within areas with a population of at least 100,000 people (agglomerations) and along major traffic routes. This indicates a 24 hour annual average noise level with separate weightings for the evening and night periods.

Noise levels are modelled on a 10m grid at a receptor height of 4m above ground, polygons are then produced by merging neighbouring cells within the following noise classes:

- 75.0+ dB
- 70.0-74.9 dB
- 65.0-69.9 dB
- 60.0-64.9 dB
- 55.0-59.9 dB

Ground Composition for this Address (Surrounding square kilometer zone around property)

Carbon Content:	HIGH	Soil Texture:	LOAM
Parent Material Grain:	ARGILLIC - ARENACEOUS	Soil Depth:	INTERMEDIATE-SHALLOW
Soil Group:	HEAVY TO MEDIUM		

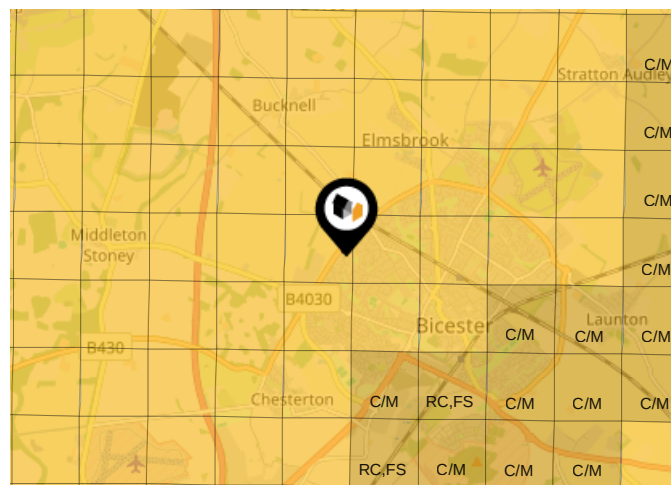

Primary Classifications (Most Common Clay Types)

C/M	Claystone / Mudstone
FPC,S	Floodplain Clay, Sand / Gravel
FC,S	Fluvial Clays & Silts
FC,S,G	Fluvial Clays, Silts, Sands & Gravel
PM/EC	Prequaternary Marine / Estuarine Clay / Silt
QM/EC	Quaternary Marine / Estuarine Clay / Silt
RC	Residual Clay
RC/LL	Residual Clay & Loamy Loess
RC,S	River Clay & Silt
RC,FS	Riverine Clay & Floodplain Sands and Gravel
RC,FL	Riverine Clay & Fluvial Sands and Gravel
TC	Terrace Clay
TC/LL	Terrace Clay & Loamy Loess

Area

Transport (National)

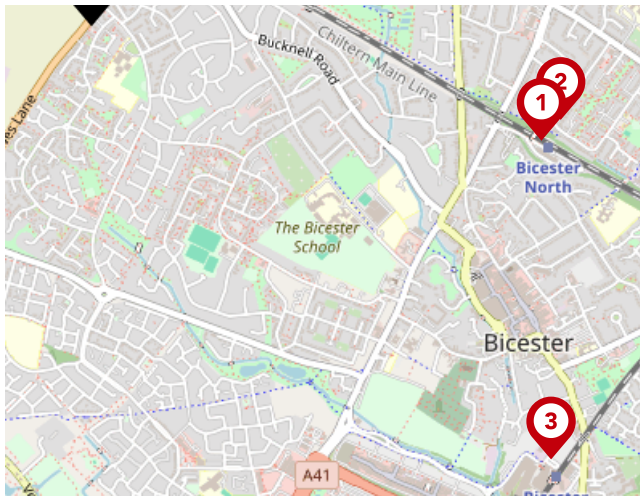

National Rail Stations

Pin	Name	Distance
1	Bicester North Rail Station	1.06 miles
2	Bicester North Rail Station	1.09 miles
3	Bicester Village Rail Station	1.45 miles

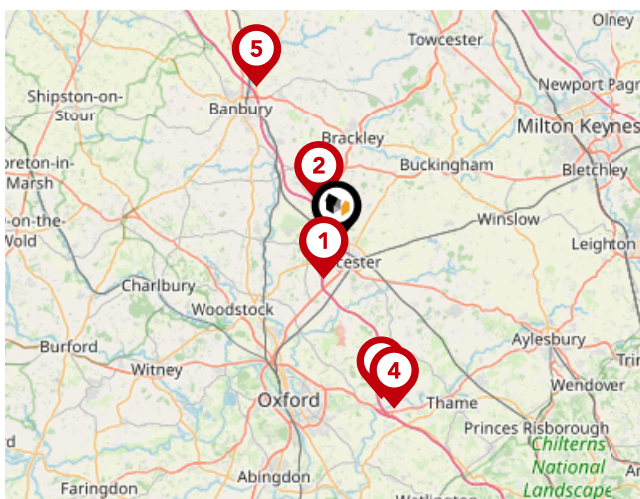

Trunk Roads/Motorways

Pin	Name	Distance
1	M40 J9	2.83 miles
2	M40 J10	3.17 miles
3	M40 J8A	11.9 miles
4	M40 J8	12.8 miles
5	M40 J11	12.89 miles

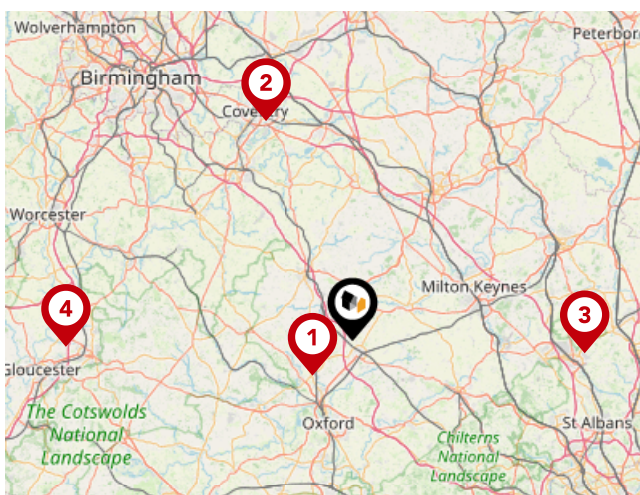

Airports/Helipads

Pin	Name	Distance
1	Kidlington	7.82 miles
2	Baginton	34.33 miles
3	Luton Airport	34.08 miles
4	Staverton	41.99 miles

Area

Transport (Local)



Bus Stops/Stations

Pin	Name	Distance
1	Dryden Avenue	0.1 miles
2	Shakespeare Drive	0.09 miles
3	Swift Close	0.15 miles
4	Bunyan Road	0.2 miles
5	Bunyan Road	0.21 miles

Avocado Property

About Us



Avocado Property

We are proud to be different, we want to create a legacy as the business that positively disrupted the industry and challenged the estate agent status quo.

Our clients all get direct access to business partners who live locally and are part of their local community. We work with local businesses to help promote their companies free of charge and we give back to teachers, nurses and armed forces servicemen/women.

We are passionate about changing the industry, passionate about helping people move on to the next chapter in their lives and passionate about property.

Avocado Property Testimonials



Testimonial 1



I was on the market with a local agent for nearly 10 weeks, I was recommended Alistair by a work colleague, He sold my property close to the asking price in less then 2 weeks. If you want a personal professional service, Alistair is definitely the guy to call, would highly recommended - Christine Corcoran

Testimonial 2



We decided to sell our property and chose to use Alistair and Avocado as they offered a different type of approach to selling. Alistair provided a far more personal and hands on service than we had experienced with high street agents previously. He steered us through a difficult chain and gave us sound advice on a daily basis, with real time facts. We would highly recommend him for his commitment throughout the journey - Maggi Wells

Testimonial 3



We moved our house sale from a high street estate agent to Alistair after he was highly recommended. We decided to move agent as we felt our house was not being seen as much as had hoped for. Alistair was great through the whole process. We couldn't recommend him any more, he made what could be a very stressful time very easy. Thank you - Emily Parker

Testimonial 4



We have recently bought a property through Alistair. His service was a breath of fresh air in comparison to many of the high street brands that we had bought and sold properties through in the past. He was efficient, reliable and trustworthy. We would recommend him without hesitation. - Holly



/avocadoproperty



/avocado_property

Avocado Property

Data Quality

We are committed to comprehensive property data being made available upfront to make the home buying and selling process quicker, easier and cheaper. This is why we have partnered with Sprift, the UK's leading supplier of property-specific data.



Contains public sector information licensed under the Open Government License v3.0

The information contained within this report is for general information purposes only.

Sprift Technologies Ltd aggregate this data from a wide variety of sources and while we endeavour to keep the information up to date and correct, we make no representations or warranties of any kind, express or implied, about the completeness, accuracy, reliability, of the information or related graphics contained within this report for any purpose.

Any reliance you place on such information is therefore strictly at your own risk. In no event will we be liable for any loss or damage including without limitation, indirect or consequential loss or damage, or any loss or damage whatsoever arising from loss of data or profits arising out of, or in connection with, the use of this report.



Avocado Property

07894820821

alistair@avocadopropertyagents.co.uk

www.avocadopropertyagents.co.uk

