



Connells

Broadwater Crescent
Welwyn Garden City



Property Description

A well-presented three bedroom end of terrace home situated in the highly sought-after Broadwater area of Welwyn Garden City, ideally positioned close to local amenities, schools and transport links.

The ground floor offers a bright and spacious lounge, along with a modern kitchen/diner providing an excellent space for both everyday living and entertaining. A convenient downstairs WC completes the ground floor accommodation.

Upstairs, the property boasts three well-proportioned bedrooms and a family bathroom, offering comfortable living for growing families.

Externally, the property benefits from a private rear garden, perfect for outdoor dining and relaxing and off street parking. As an end of terrace home, the property also enjoys additional privacy and potential for side access.

An ideal purchase for first-time buyers, families or investors.



Kitchen

11' 8" x 11' 7" (3.56m x 3.53m)

Lounge

13' 11" x 11' 8" (4.24m x 3.56m)

Bedroom 1

15' x 8' 11" (4.57m x 2.72m)

Bedroom 2

11' 1" x 10' 8" (3.38m x 3.25m)

Bedroom 3

9' 5" x 8' 9" (2.87m x 2.67m)

Bathroom

6' 7" x 5' 7" (2.01m x 1.70m)







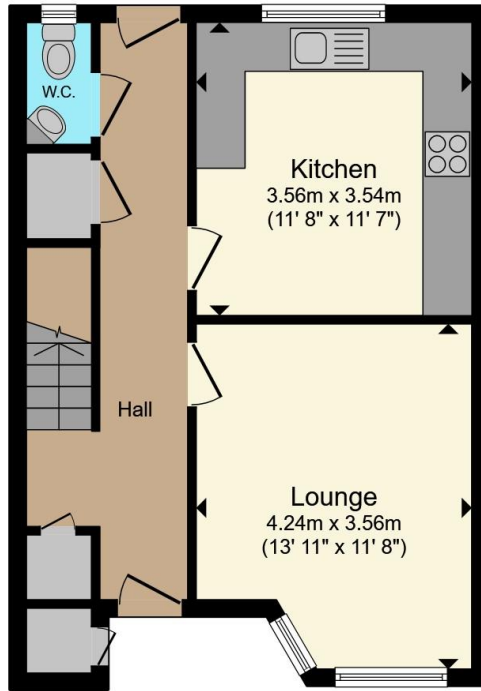

Ground Floor

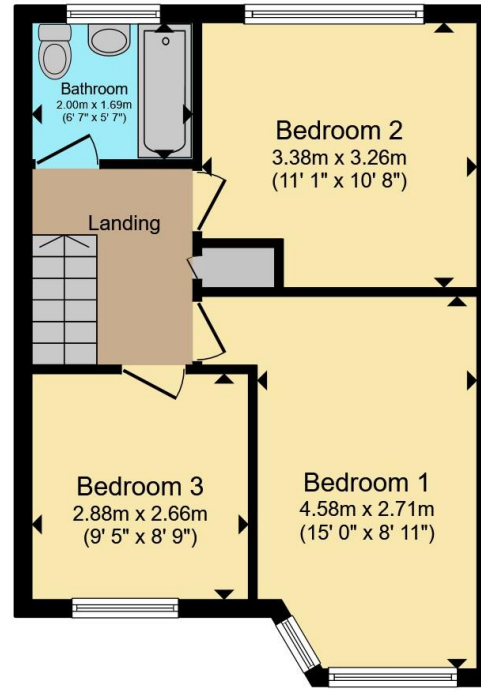

First Floor

Total floor area 81.8 m² (880 sq.ft.) approx

This floor plan is for illustrative purposes only. It is not drawn to scale. Any measurements, floor areas (including any total floor area), openings and orientation are approximate. No details are guaranteed, they cannot be relied upon for any purpose and they do not form part of any agreement. No liability is taken for any error, omission or misstatement. A party must rely upon its own inspection(s). Powered by www.propertybox.io



To view this property please contact Connells on

T 01707 322 903
E welwyncardencity@connells.co.uk

38 Wigmores North
 WELWYN GARDEN CITY AL8 6PH

EPC Rating: C Council Tax
 Band: C

Tenure: Freehold

view this property online connells.co.uk/Property/WWY307277



1. MONEY LAUNDERING REGULATIONS Intending purchasers will be asked to produce identification documentation at a later stage and we would ask for your co-operation in order that there will be no delay in agreeing the sale. 2. These particulars do not constitute part or all of an offer or contract. 3. The measurements indicated are supplied for guidance only and as such must be considered incorrect. Potential buyers are advised to recheck measurements before committing to any expense. 4. We have not tested any apparatus, equipment, fixtures, fittings or services and it is in the buyers interest to check the working condition of any appliances.

Connells Residential is registered in England and Wales under company number 1489613, Registered Office is Cumbria House, 16-20 Hockliffe Street, Leighton Buzzard, Bedfordshire, LU7 1GN. VAT Registration Number is 500 2481 05.

See all our properties at www.connells.co.uk | www.rightmove.co.uk | www.zoopla.co.uk

Property Ref: WWY307277 - 0004