

Peterborough
Telephone: 01733 560 650
Email: Sales@RegalPark.co.uk
RegalPark.co.uk

7 Office Village, Cygnet Park, Peterborough, PE7 8GX



Swale Avenue, Gunthorpe, Peterborough, PE4 7GT
Offers in excess of £200,000
Freehold

IDEAL FIRST TIME OR INVESTMENT PURCHASE* *RE-FITTED KITCHEN* *RE-FITTED SHOWER ROOM* *LONG DRIVEWAY & SINGLE GARAGE

Regal Park are pleased to offer this well presented 2 Bedroom End Terrace House in the popular location of Gunthorpe. The property is situated close to local amenities and is within easy access to A15/A16/A47. The property comprises; Entrance Hall, Lounge, Re-Fitted Kitchen/Dining Room, 2 Bedrooms and a Re-Fitted Shower Room.

There is a long Driveway to the side providing off road parking, leading to a Single Garage.

Enclosed rear garden.

Viewings Highly Recommended.

EPC: C



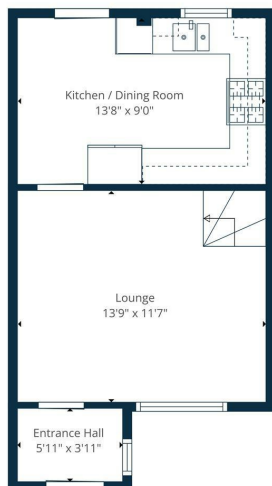

These Floor Plans Are Provided For Illustrative And Marketing Purposes Only.



These Floor Plans Are Provided For Illustrative And Marketing Purposes Only.

Entrance Hall

Lounge

13'9" x 11'7" (4.19m x 3.53m)

Kitchen/Dining Room

13'8" x 9'0" (4.17m x 2.74m)

Stairs and Landing

Bedroom 1

13'9" x 8'2" (4.19m x 2.49m)

Bedroom 2

7'4" x 10'10" (2.24m x 3.30m)

Shower Room

Offer Procedure and Mortgage Assistance

In compliance with The Estate Agents (Undesirable Practices) Order 1991, we are under an obligation to check into a Purchaser's financial situation before recommending an offer to a Vendor.

Therefore, prior to any offers being accepted, you will be required to make an appointment in order for us to financially qualify your offer.

If you are making a cash offer, which is not subject to the sale of a property, written confirmation of the availability of the cash will be required before your offer can be qualified.

With so many mortgage schemes available and so many lenders trying to tempt you, how do you know what is the right scheme for you?

Our recommended Mortgage Company will be pleased to

provide you with mortgage advice and recommendations unique to your individual circumstances and they will guide you through the process.

For further details, please call our office on 01733 560650.

Your home may be repossessed if you do not keep up repayments on your mortgage.