



- FOUR BEDROOMS
- TERRACED HOUSE
- TWO BATHROOMS
- ONE RECEPTION

28 Pethick Road, Wick, Littlehampton, BN17 7TJ

£340,000

W Welch Estate Agents are pleased to offer for sale this 4 bedroom stunning terraced house built in the last 5 years, still having its NHBC building certificate. The property boasts good size spacious rooms and is situated on the Toddington development with-in a 10 min drive to Littlehampton seafront and the beautiful Arundel village/south downs country side. The accommodation comprises 4 double bedrooms one with ensuite, Living area, cloakroom/wc, kitchen/diner, family bathroom/wc. Externally the property has ample parking and a low maintenance garden. Call now on Tel: 01903 898000 to arrange a viewing.

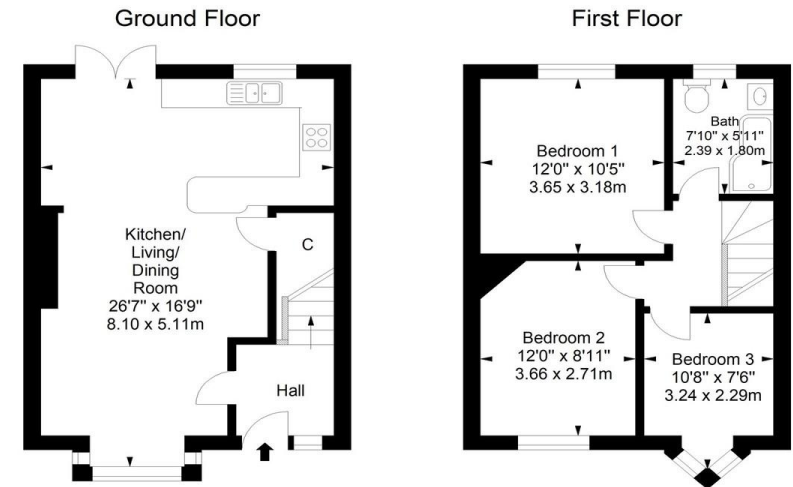

Approximate gross internal floor area 77.5 sq m/ 834.2 sq ft
 Whilst every care has been taken to ensure accuracy, dimensions are approximate and for illustrative purposes only.
 All rights reserved.



%epcGraph_c_1_334%

3 Marston Road, Worthing, West
 Sussex, BN14 8BD

www.w-welchestateagents.co.uk
 01903 898000
sales@w-welchestateagents.co.uk

Agents Note: Whilst every care has been taken to prepare these particulars, they are for guidance purposes only. All measurements are approximate and for general guidance purposes only and whilst every care has been taken to ensure their accuracy, they should not be relied upon and potential buyers/tenants are advised to recheck the measurements