



Well presented 1930's ground floor Tyneside flat with generous kitchen, South-West facing gardens and garage! Located close to Jesmond Dene, within Jesmond Vale. a perfect location for a variety of buyers within walking distance to the shops cafés and restaurants of Jesmond as well as Newcastle City Centre.

The accommodation briefly comprises: entrance hall with stripped wood flooring and large under-stairs storage cupboard; sitting room with fitted alcove storage and stripped wood flooring and direct access to the rear garden; kitchen with fitted units, hardwood work surfaces, Belfast sink, utility storage cupboard, dual windows and spotlighting; wine cellar and storage; shower room, fully tiled with three-piece suite; two bedrooms, bedroom one/living room with bay window.

Externally, well stocked front garden, a mature very private South-West facing rear garden with a raised decked sun terrace taking advantage of the evening sun, steps down to an enclosed garden, garden can be fully lit for night-time entertainment, shed/wood store and detached garage/workshop with power, lighting and an up and over door. Access to rear lane. A great purchase for a range of potential buyers, early viewings are advised.

1930's 'Tyneside' Flat | Well Presented | Two Bedrooms | 888 Sq ft (82.5m²) | Sitting Room | Kitchen | Shower Room | South-West Facing Garden | Garage | Great Location | Close to Jesmond Dene | Leasehold - Tyneside Lease with Peppercorn Rent | Council Tax and A | EPC: C



GROUND FLOOR
750 sq.ft. (69.7 sq.m.) approx.

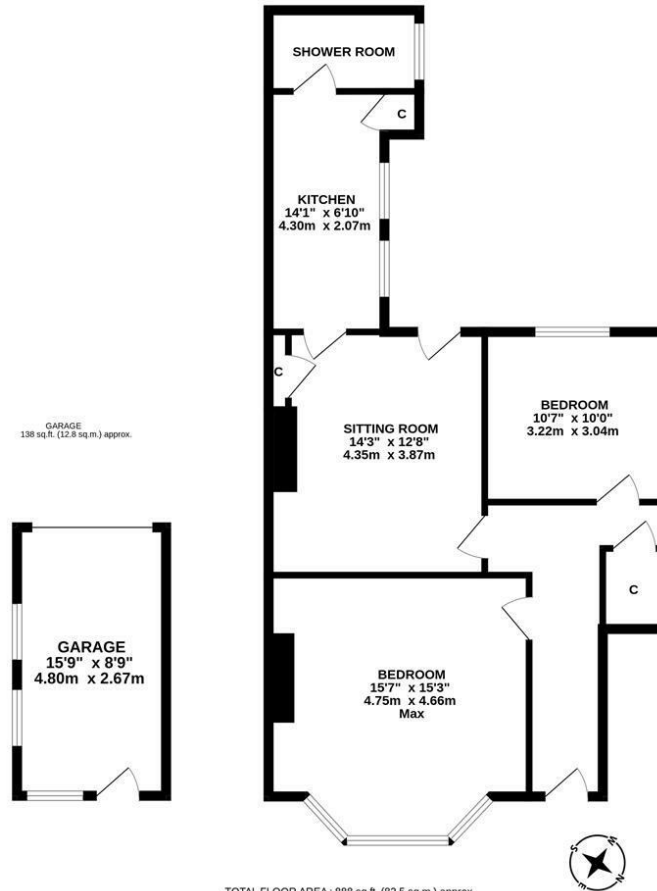

TOTAL FLOOR AREA: 888 sq.ft. (82.5 sq.m.) approx.

Whilst every attempt has been made to ensure the accuracy of the floorplans contained here, measurements of doors, windows, rooms and any other items are approximate and no responsibility is taken for any error, omission or mis-statement. This plan is for illustrative purposes only and should be used as such by any prospective purchaser. The services, systems and appliances shown have not been tested and no guarantee as to their operability or efficiency can be given.
Made with Metropix ©2020



Offers Over £225,000

IMPORTANT NOTE: These particulars and the descriptions and measurements herein do not constitute representation and whilst every effort has been made to ensure accuracy, this cannot be guaranteed.

