



BEAUFORT GREEN

Eardley Crescent, SW5

£575,000



A generous, two double bedroom apartment in this attractive period conversion. The property has separate kitchen living room and storage throughout. The property is located moments away from Earls Court Station and the Fulham Road.





BEAUFORT GREEN

BEAUFORT GREEN

Eardley Crescent, SW5

Approximate Gross Internal Area
58.14 sq m / 626 sq ft
(CH = Ceiling Heights)

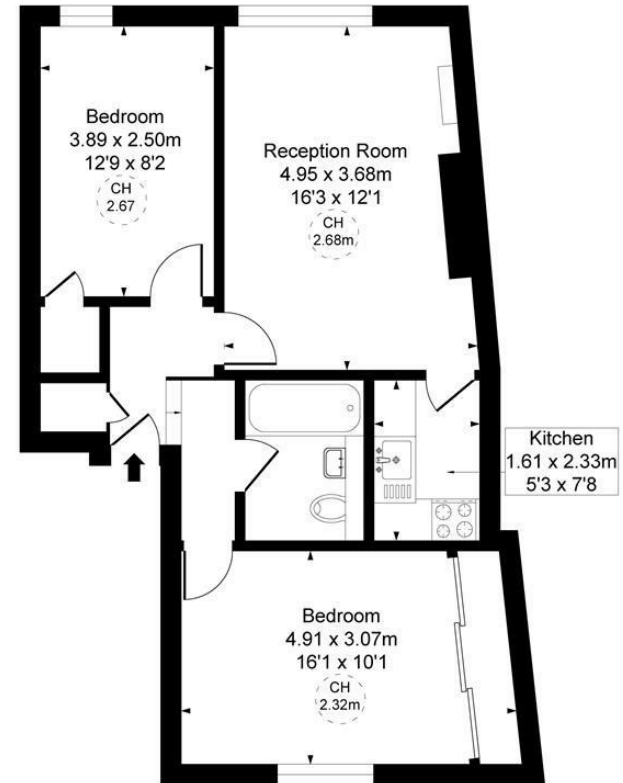

Second Floor

At a Glance.

- Two Double Bedrooms
- Ample Storage
- Period Conversion
- Share of Freehold
- Separate Kitchen
- Moments from Earls Court Station

This plan is not to scale. It is for guidance and not for valuation purposes.
All measurements and areas are approximate only, and have been prepared in accordance with the current edition of the RICS Code of Measuring Practice.

BEAUFORT GREEN

02074594100

charlie@beaufortgreen.co.uk

263 New Kings Road
London
SW16 1DB