

STONE



Furze field Road RH2

£2,350,000

“At Stone, we’re passionate about the unique and awe-inspiring architectural elements that transform houses into dream homes.”

————— *The Stone Family*



Step into Furzefield Road, a home that beautifully marries timeless character with the ease and elegance of contemporary family living. Set behind a generous frontage, this six-bedroom, four-bathroom residence unfolds as a sanctuary of light and space, where a calm, neutral palette flows effortlessly from room to room. The result is a quietly sophisticated backdrop—both soothing and versatile—allowing future owners to layer their own aesthetic and personality with ease.

From the moment you arrive, the home's warm welcome is clear. A wide driveway and single garage provide everyday practicality, while a charming historic well offers a gentle nod to the past. Aside from the original front door, the house has been thoughtfully rebuilt, combining modern construction with the promise of a home designed for long-term family living.

Inside, the atmosphere is one of relaxed refinement. Two beautifully proportioned reception rooms create a natural rhythm to the ground floor, lending themselves equally to cosy evenings by soft lamplight or to elegant entertaining with friends. There is a sense of flow and flexibility throughout, enhanced by the gentle light that moves across the interiors during the day. The kitchen-dining space forms the true heart of the home—warm, inviting and designed for connection. Wood-style cabinetry introduces texture and depth, while the generous proportions encourage everything from leisurely Sunday brunches to lively midweek suppers and celebrations that spill long into the evening. Outside, the garden offers a private and peaceful escape, perfect for long summer afternoons, alfresco dining and children's play.



An additional office or study provides an essential yet stylish solution for modern life, offering a quiet retreat for home working, creative projects or simply a place to pause. Throughout, the house balances beauty with function, creating spaces that feel both composed and deeply liveable.

Upstairs, the principal suite is a haven of calm. Soft and restorative in mood, it features a built-in vanity that evokes the serenity of a boutique spa, creating a space that feels both indulgent and deeply relaxing. The adjoining dressing room and ensuite bathroom further enhance the sense of quiet luxury, while extensive built-in storage throughout the home ensures daily life remains beautifully organised. The first floor continues to impress, offering three additional well-proportioned bedrooms, each filled with natural light and thoughtfully designed for comfort. One of these enjoys the added privacy of its own ensuite, making it ideal for guests or older children, while a stylish family bathroom serves the remaining rooms with ease.

Moving to the second floor, two further bedrooms provide a wonderfully versatile retreat. Currently arranged as a vibrant teenagers' haven, this level features a relaxed seating area alongside a contemporary shower room—an inviting and independent space that could equally lend itself to guest accommodation, a creative studio, or a peaceful escape from the bustle of family life. Some areas present an opportunity for gentle updating—an appealing prospect for those wishing to introduce contemporary touches or curate a more personal design vision without the need for major works.







Furzefield Road offers the best of Reigate: a tranquil, sought-after location that is nevertheless close to local amenities, schools, and transport links. Here is a house where life flows effortlessly, where every detail—from generous reception rooms to the calming, neutral palette—speaks of considered design and family-focused living.

A short stroll brings you to Reigate's historic high street, lined with boutique shops, artisan cafés, and celebrated restaurants. Reigate Station is within easy walking distance, offering direct links to London Bridge and Victoria, making this home an excellent choice for commuters. For those heading further afield, the nearby M25 and Gatwick Airport ensure quick access to road and air networks.

This part of Reigate, with its quiet leafy roads and striking Victorian architecture, blends heritage and modern convenience beautifully. Life here moves at just the right pace: unhurried, connected, and steeped in character.







The Details

- A substantial detached home with contemporary interiors
- Situated on a prestigious road, the home enjoys an enviable and distinguished setting
- The property boasts an exceptionally large plot, offering exceptional space and potential
- A generous private South facing garden, with established planting offering a private setting
- Ample parking on a large private driveway, with garage
- Within walking distance of the area's Outstanding independent schools, Dunottar, Reigate Grammar and St Mary's
- A short walk to Lesbourne Road's offering of coffee shops, independent businesses and amenities
- Under 10 minute drive to either Reigate or Redhill's train stations, with swift links into London, Gatwick Airport and the coast

Size
Approx 4210.00 sq ft

Energy Performance Certificate (EPC)
Rating C

Council Tax Band
F

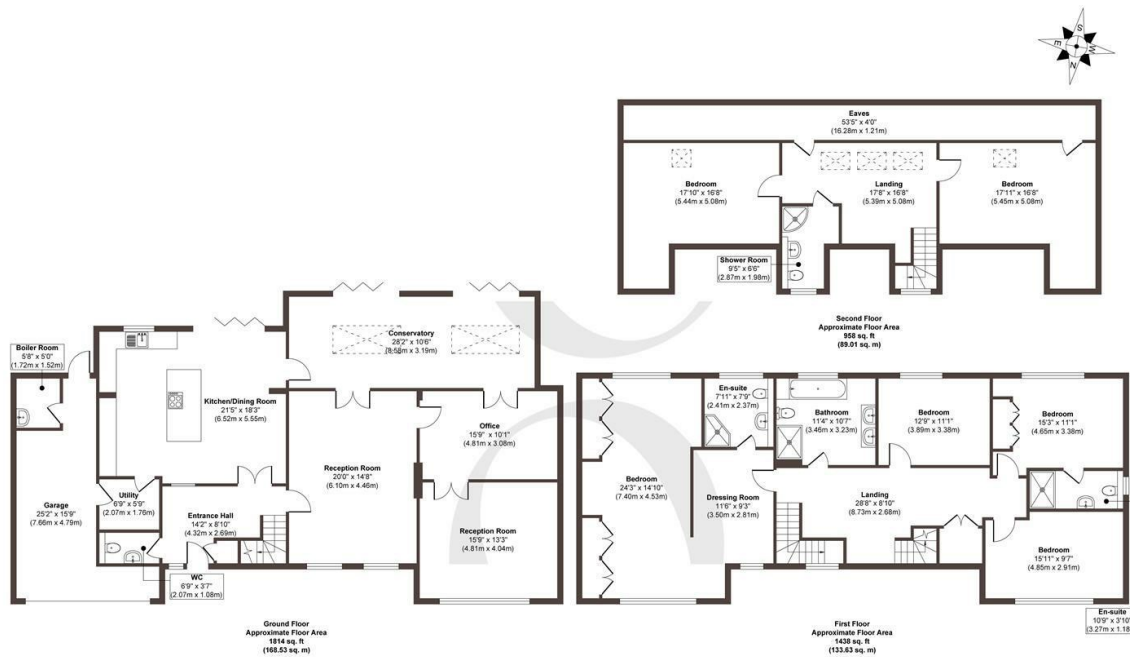

Approx. Gross Internal Floor Area 4210 sq. ft / 391.17 sq. m (Including Eaves)

Illustration for identification purposes only, measurements are approximate, not to scale.

Produced by Elements Property
A DIVISION OF ELEMENTS PROPERTY

STONE



STONE

Let's Talk

01737 301 557

hello@stoneestateagents.co.uk

stoneestateagents.co.uk

The particulars above are a guide, not an offer or contract. Descriptions photographs and plans are not statements or representations of fact. Measurements are approximate and not to scale. Prospective purchasers must verify the accuracy of the information within the particulars. Stone does not give any representations or warranties; nor represent the Seller legally. Stone has no liability, for any costs, losses or expenses incurred by the Seller or a prospective buyer relating to the sales and buying transaction. Our Sales Disclaimer, trading names and privacy policy on how your data is processed and used is found in full on our website in our Privacy Statement.

© Stone Estate Agents 2023 All rights Reserved