



Gay Close, NW2

Leasehold - £600,000

A well-presented two double bedroom garden flat situated in the sought-after Gay Close, NW2.

This charming property features a spacious reception area with beautiful parquet flooring, complemented by carpets in both generously sized bedrooms for added comfort. The separate, fully equipped kitchen offers ample storage and workspace, while the fully tiled bathroom is accompanied by an additional independent WC for convenience.

Further benefits include double glazing throughout, access to a private garden, ideal for relaxing or entertaining. Perfectly positioned close to the local amenities and excellent transport links of Willesden Green (Jubilee Line, Zone 2), the property also enjoys easy access to the open green spaces of Gladstone Park.

Offered chain free, this property represents an excellent opportunity for both first-time buyers and investors alike.



020 8459 1133

enquiries@cameronsstiff.co.uk

cameronsstiff.co.uk





Gay Close, London, NW2

Approximate Area = 873 sq ft / 81.1 sq m

For identification only - Not to scale

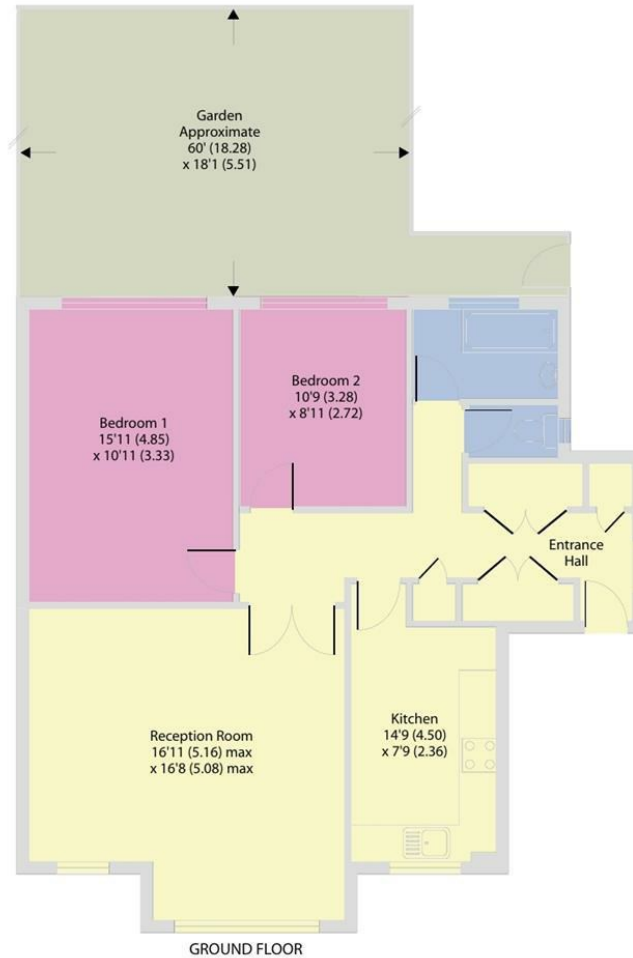

Floor plan produced in accordance with RICS Property Measurement 2nd Edition, Incorporating International Property Measurement Standards (IPMS2 Residential). © nchecon 2026. Produced for Camerons Stiff & Co. REF: 497472

EPC: C

Ref: 15071444

