

£345,000

Southwick Avenue, Portchester, PO16 8JE



- Three Bedrooms
- Entrance Hallway
- 21' x 18' L-Shaped Lounge/Dining Room
- Kitchen
- Ground Floor Bathroom
- Gas Central Heating
- Double Glazed Windows
- Off Street Parking & Garage/Workshop
- Established West Facing Rear Garden
- NO CHAIN AHEAD

Portchester Office

92 West Street Portchester Hampshire PO16 9UQ

Tel: 02392 327 070 | E: tiffany.porchester@fenwicks-estates.co.uk

www.fenwicks-estates.co.uk

Property Reference: P2919

Council Tax Band: D

Awaiting EPC

Floor Plans (For illustrative purposes and not drawn exactly to scale)

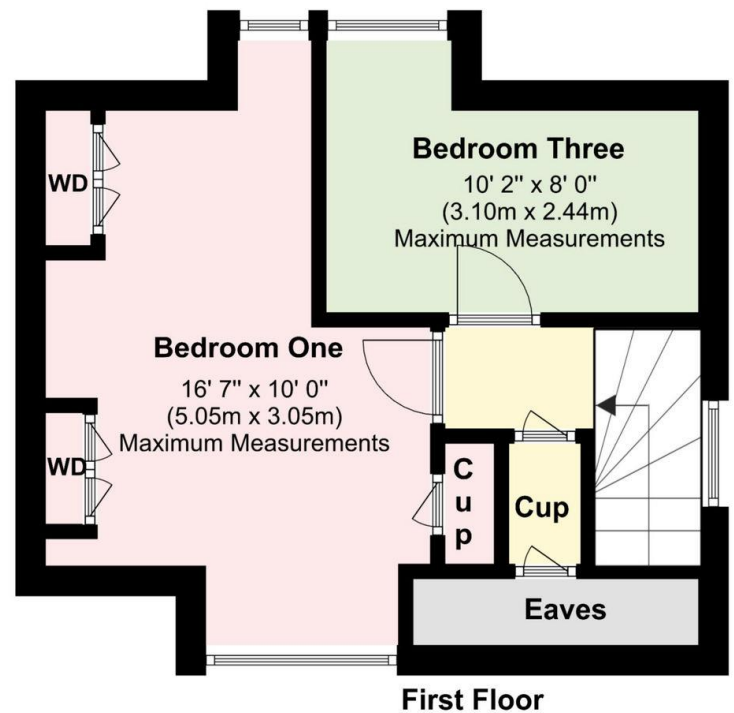

Portchester Office

92 West Street Portchester Hampshire PO16 9UQ

Tel: 02392 327 070 | E: tiffany.porchester@fenwicks-estates.co.uk

www.fenwicks-estates.co.uk



The Accommodation Comprises:-

Double opening wooden doors leading to the entrance porch with further glazed internal door to:

Entrance Hall:-

Return staircase leading to the first floor, radiator, flat ceiling. Glazed doors to:

Lounge/Dining Room:-

21' 3" x 18' 5" (6.47m x 5.61m) Maximum Measurements

UPVC double glazed window and sliding patio door overlooking and accessing the West facing rear garden, feature fireplace with gas fire inset, three radiators, TV aerial point, space for a table and chairs if required, textured ceiling, further glazed door to the garden. Brick archway to:



Kitchen:-

10' 6" Plus Recess x 8' 3" (3.20m x 2.51m)

Opaque UPVC double glazed windows to the side elevation, the kitchen is fitted with a range of base and eye level storage units with roll top work surfaces, one and a half bowl single drainer sink unit inset with a mixer tap and part of walls, built-in oven and grill, electric hob with extractor above, space and plumbing for washing machine and slim line dishwasher, recess for fridge/freezer, replacement wall mounted gas central heating boiler and radiator.



Portchester Office

92 West Street Portchester Hampshire PO16 9UQ

Tel: 02392 327 070 | E: tiffany.porchester@fenwicks-estates.co.uk

www.fenwicks-estates.co.uk



Bedroom Two:-
12' 4" Into Bay x 10' 3" (3.76m x 3.12m) Maximum Measurements

Double glazed half bay window to the front elevation, radiator and textured ceiling



Bathroom:-
7' 2" x 5' 4" (2.18m x 1.62m) Maximum Measurements

Opaque UPVC double glazed window to the front elevation, white suite comprising panelled bath with Triton electric shower and screen, close coupled WC, circular wash hand basin with mixer tap and vanity storage below, part tiled walls, radiator and flat ceiling with spotlights inset.



First Floor Landing:-

UPVC double glazed window to the side elevation, built in storage cupboard, flat/sloping ceiling with access to the remainder of the loft and doors to:

Bedroom One:-
16' 7" x 10' 0" (5.05m x 3.05m) Maximum Measurements

A dual aspect room with UPVC double glazed windows to the front and rear elevations, radiator, built in wardrobes and storage cupboard, wood effect laminate flooring and flat/sloping ceiling.



Portchester Office

92 West Street Portchester Hampshire PO16 9UQ

Tel: 02392 327 070 | E: tiffany.porchester@fenwicks-estates.co.uk

www.fenwicks-estates.co.uk

Bedroom Three:-

10' 2" x 8' 0" (3.10m x 2.44m) Maximum Measurements

UPVC double glazed window to the rear elevation radiator and flat/sloping ceiling.



Rear Garden:-

To the rear of the property there is an established enclosed west facing garden with a patio area for entertaining purposes, the remainder mainly laid to lawn with a selection of trees and shrubs.



Outside:-

The front garden is laid to lawn with mature shrubs and bushes, there is off street parking and side access leading to the garage/workshop with up and over door. Side courtesy door to the garden.



Portchester Office

92 West Street Portchester Hampshire PO16 9UQ

Tel: 02392 327 070 | E: tiffany.porchester@fenwicks-estates.co.uk

www.fenwicks-estates.co.uk



Disclaimer: These particulars are set out as a general outline in accordance with the Consumer Protection from Unfair Trading Regulations 2008 (CPR's) and Business Protection from Misleading Marketing Regulations 2008 (BPR's) only for the guidance of intending purchasers or lessees, and do not constitute any part of an offer or contract. Details are given without any responsibility, and any intending purchasers, lessees or third parties should not rely on them as statements or representations of fact, but must satisfy themselves by inspection or otherwise as to the correctness of each of them.

We have not carried out a structural survey and the services, appliances and specific fittings have not been tested. All photographs, measurements, floor plans and distances referred to are given as a guide only and should not be relied upon for the purchase of carpets or any other fixtures or fittings. Gardens, roof terraces, balconies and communal gardens as well as tenure and lease details cannot have their accuracy guaranteed for intending purchasers. Lease details, service ground rent (where applicable) are given as a guide only and should be checked and confirmed by your solicitor prior to exchange of contracts.

No person in the employment of Fenwicks Estates Ltd has any authority to make any representation or warranty whatever in relation to this property. Purchase prices, rents or other prices quoted are correct at the date of publication and, unless otherwise stated, exclusive of VAT.

Data Protection: We retain the copyright in all advertising material used to market this Property.

Money Laundering Regulations 2017: Intending purchasers will be required to produce identification documentation once an offer is accepted

Your home is at risk if you do not keep up repayments on mortgage or other secured loans.

Portchester Office

92 West Street Portchester Hampshire PO16 9UQ

Tel: 02392 327 070 | E: tiffany.porchester@fenwicks-estates.co.uk

www.fenwicks-estates.co.uk

