



Abercorn Place

St John's Wood, NW8

£2,850 per month
(£657.69 per week)

A large two bedroom apartment set on the second floor of a period converted house, ideally located just off of the sought after Abbey Road and within close proximity to St John's Wood and Maida Vale stations.

CHESTERTONS



Abercorn Place

St John's Wood, NW8

- Second Floor Flat
- 2 Bedrooms, 1 Bathroom
- Spacious, Gas Heating
- Close to Maida Vale and St John's Wood



A large two bedroom apartment set on the second floor of a period converted house, ideally located just off of the sought after Abbey Road and within close proximity to St John's Wood and Maida Vale stations.

The property comprises a large principle bedroom, a further smaller bedroom, spacious south facing reception room, fitted kitchen and full sized bathroom.

The property is offered unfurnished.

Minimum Term: 12 months
Deposit Required: £3,288.46
Local Authority: City Of Westminster
Council Tax Band: E
EPC Rating: C
Unfurnished

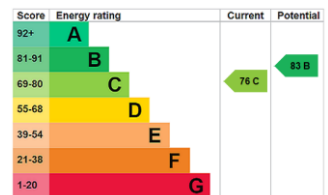

Chestertons St John's Wood Lettings

105 St. John's Wood Terrace
 London
 NW8 6PL
 stjohslettingsusers@chestertons.co.uk
 02030408622
 chestertons.co.uk

Additional tenant charges apply (fees apply to non-AST tenancies only)
 Tenancy Agreement Fee: £300
 References per Tenant/Guarantor: £60
 Inventory check (approx. £100 – £250 inc. VAT)
 chestertons.co.uk/property-to-rent/applicable-fees

Abercorn Place, NW8 9DR

Approx Gross Internal Area = 60.4 sq m / 650 sq ft

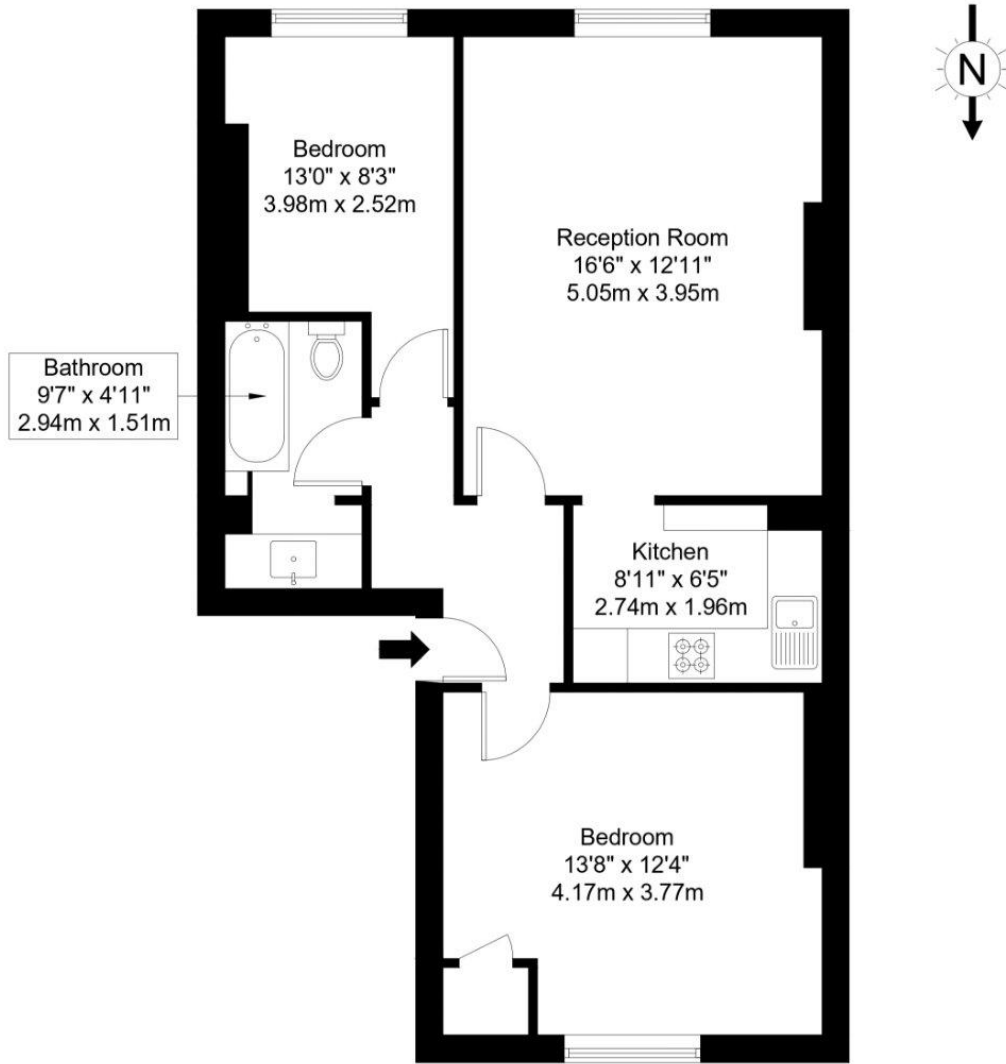

Second Floor

Ref :

Copyright **BLEU
PLAN**

The Floor plan is not to scale and measurements and areas shown are approximate and therefore should be used for illustrative purposes only. The plan has been prepared in accordance with the RICS code of Measuring Practice and whilst we have confidence in the information produced it must not be relied on. Maximum lengths and widths are represented on the floor plan. If there is any aspect of particular importance, you should carry out or commission your own inspection of the property.
Copyright @ BleuPlan

Chesterton UK Services Limited trading as Chestertons for themselves and for the vendor of this property whose agents they are, give notice that (i) these particulars do not constitute any part of an offer or contract, (ii) all statements contained within these particulars are made without responsibility on the part of Chestertons or the vendor, (iii) whilst made in good faith, none of the statements contained within these particulars are to be relied upon as a statement or representation of fact, (iv) any intending purchasers must satisfy themselves by inspection or otherwise as to the correctness of each of the statements contained within these particulars, (v) the vendor does not make or give either Chestertons or any person in their employment any authority to make or give representation or warranty whatsoever in relation to this property. Wide angle lenses may be used. ©Copyright Chestertons | Chesterton Global Ltd | Registered Office 5th Floor, The Lantern, 75 Hampstead Road, London, NW1 2PL Registered Company Number 05334580.



This paper is
100% recyclable