

## Grove End Road, NW8

### £375,000

A bright one bedroom apartment featuring an open plan kitchen/reception room and presented in good condition throughout. The property is offered chain free and benefits from a share of freehold.

Addison House is well located for the amenities of St John's Wood High Street and the open spaces of Regent's Park. The area offers a strong residential feel with excellent convenience. Transport links include St John's Wood underground station (Jubilee line) and nearby bus routes.

### Features

- One Bedroom
- Chain Free
- Bright Property
- Share of Freehold
- Excellent Location
- Good Condition

# Grove End Road, London, NW8

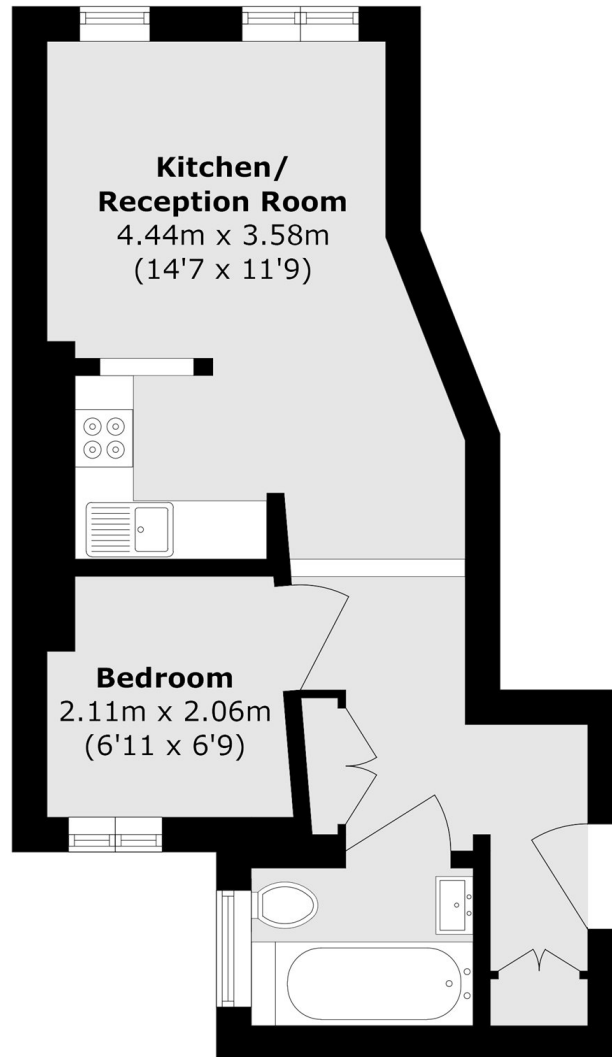

Total area (approx.): 28.0 sq. m (301.3 sq. ft)