



## Wood House , Grosvenor Waterside, Gatliff Road, London SW1W 8DE

£447,000

- 24/7 CONCIERGE
- 1 BEDROOM 1 RECEPTION WITH OPEN PLAN KITCHEN
- MOMENTS AWAY FROM BATTERSEA PARK
- VIDEO VIEWING AVAILABLE
- 1 BATHROOM
- NEWLY REFURBISHED
- WALKING DISTANCE TO SLOANE SQUARE AND VICTORIA STATION

## WOODS HOUSE, GATLIFF ROAD

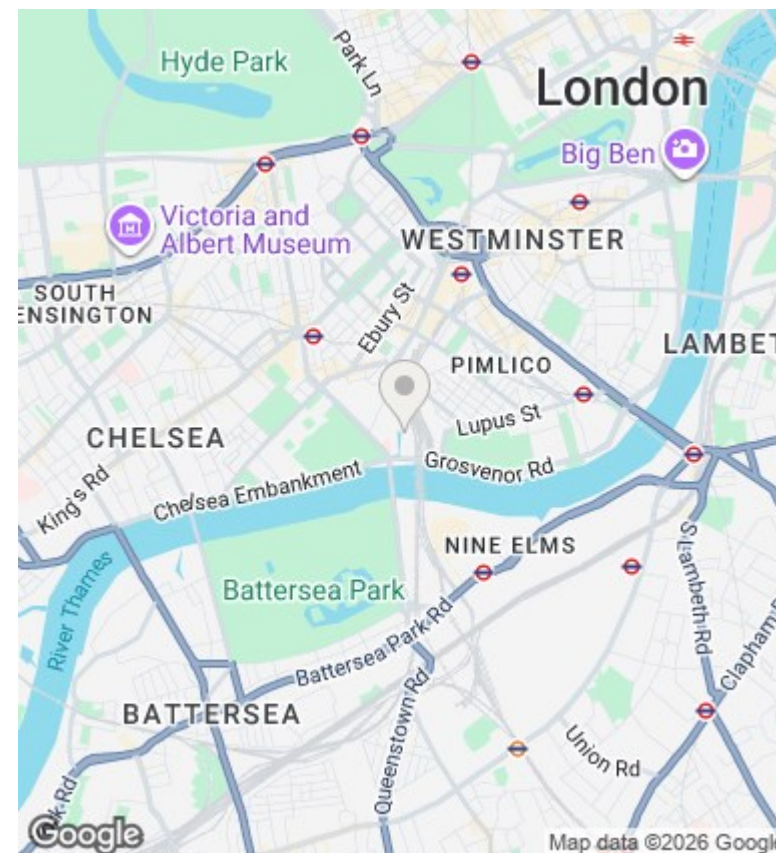
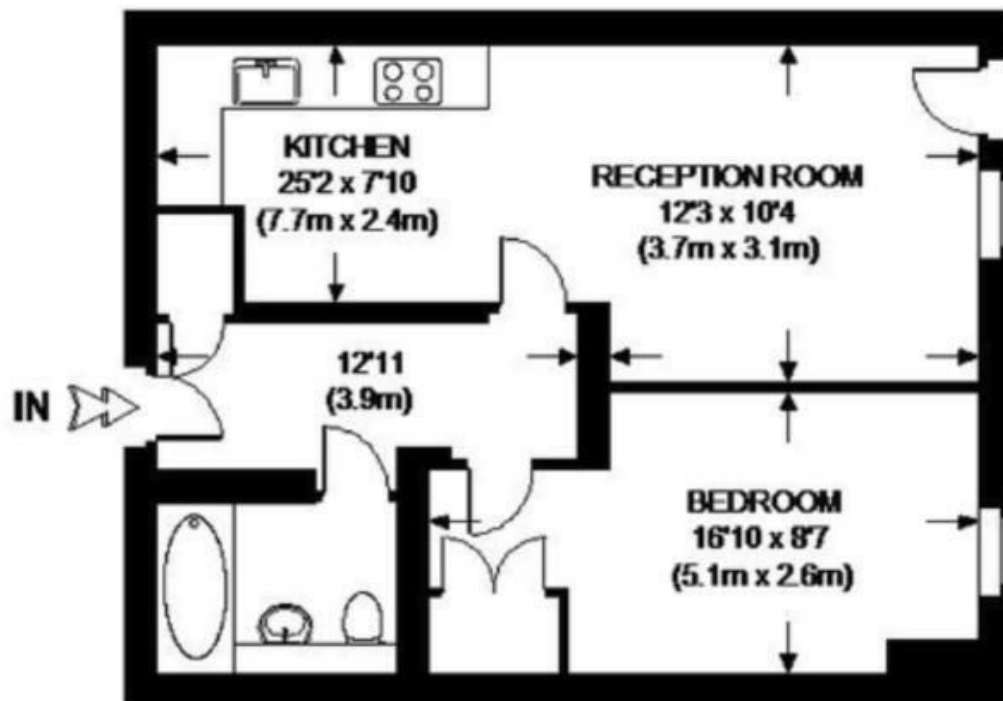

### Viewings

Viewings by arrangement only.  
Call 02077225022 to make an appointment.

### Council Tax Band

### EPC Rating:

B

Energy Efficiency Rating		Current	Potential
<i>Very energy efficient - lower running costs</i>			
(92 plus) <b>A</b>			
(81-91) <b>B</b>		<b>81</b>	<b>81</b>
(69-80) <b>C</b>			
(55-68) <b>D</b>			
(39-54) <b>E</b>			
(21-38) <b>F</b>			
(1-20) <b>G</b>			
<i>Not energy efficient - higher running costs</i>			
<b>England &amp; Wales</b>		EU Directive 2002/91/EC	