



6 Greenslade Close

Kettering, Northamptonshire NN15 6GL



Simpson & Partners

Welcome to this four-bedroom detached property, ideally situated on the popular Leisure Village. Perfectly positioned within convenient distance of both Kettering General Hospital and Kettering mainline railway station, this home offers an excellent blend of comfort and accessibility.

The property is well-appointed throughout, benefiting from UPVC double glazing and gas radiator central heating to ensure year-round comfort. Upon entering, you are greeted by a welcoming entrance hall that leads through to the ground floor accommodation. Here you will find a downstairs WC, a generous 14-foot kitchen/breakfast room complete with built-in appliances, a bright and inviting living room, and a separate dining room — ideal for entertaining guests or enjoying family meals.

Upstairs, the first floor hosts four bedrooms, with bedroom one enjoying its own en-suite shower room. A family bathroom serves the remaining bedrooms, providing facilities for the whole household.

Externally, the property features front and rear gardens that offer wonderful outdoor space for relaxation and enjoyment. Practical needs are well catered for with off-road parking and a garage, providing secure and convenient vehicle storage.

This is a fantastic opportunity to acquire this family home in a sought-after location. An internal viewing is highly recommended to fully appreciate all that this property has to offer and to avoid any disappointment.

Price £335,000



4



2



2



Simpson & Partners

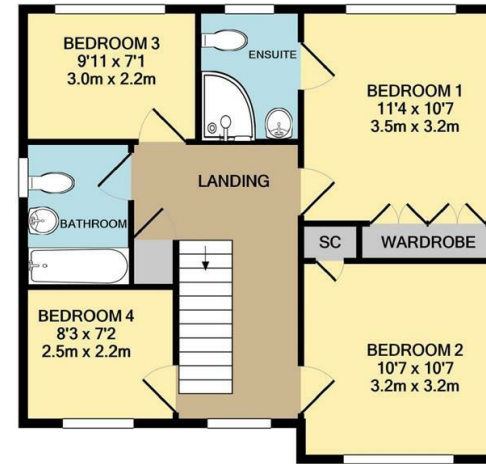

GROUND FLOOR

1ST FLOOR

Whilst every attempt has been made to ensure the accuracy of the floor plan contained here, measurements of doors, windows, rooms and any other items are approximate and no responsibility is taken for any error, omission, or mis-statement. The plan is copyright to Simpson and Partners and is for illustrative purposes and should only be used as such by any prospective purchaser. The services, systems and appliances shown have not been tested and no guarantee as to their operability can be given.
Made with Maptopia ©2021

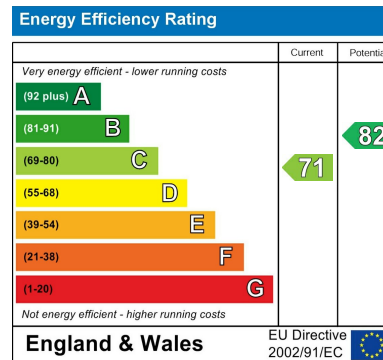

When you buy with Simpson and Partners, you know **you'll be in safe hands**. From the moment you walk through our doors, we'll make you **feel truly welcome**. Our sales consultants and financial advisors will take you through **every step of the process**, offering **free expert advice** along the way, from help choosing the right mortgage and insurance through to finding your conveyancer. And if you need help selling your home too, **with over 20 years of local experience, you can trust us to get you moving**.



**Simpson
& Partners**

Making Every
Journey Personal



01536 518200

kettering@simpsonandpartners.co.uk

<https://www.simpsonandpartners.co.uk/>

1 Silver Street, Kettering, Northants, NN16 0BN