

Property ref: 115741

## Pages Gardens, Pangbourne, RG8 7JE

**£875 PCM**

**HASLAMs**  
Lettings



A beautifully presented modern studio apartment, located in the heart of Pangbourne village, close to the train station, shops and local amenities. West Berkshire Borough Council Tax band A.

Water supply: Mains

Drainage info: Mains

Electricity supply: Mains

Broadband/Mobile Info: Connections available. For an indication of specific speeds and supply of Broadband and Mobile, we advise applicants go to the Ofcom website Broadband and Mobile Coverage Checker.

- Good size living area
- Modern bathroom
- Modern fitted kitchen
- EPC rating E; Parking space at £75 per month- subject to availability
- £250 sundry additional to the rent to include:- water, electric and Wi-Fi
- Furnished; Managed by HASLAMs

**Available 02/03/2026**

\*Fees For Assured Shorthold Tenancies: when you rent a property from us you will be required to pay a sum equivalent to one weeks' rent for a holding deposit. Upon successful application, this amount will be off set against your first months' rent. You will also be required to pay a security deposit equivalent to 5 weeks' rent which will be held and protected in line with Deposit legislation. For more information about our fees please visit: [www.haslams.net](http://www.haslams.net)  
Fees for all other tenancies (Non Housing Act Tenancies / Company Lets): when you rent a property from us we will charge you a one-off fee per property. This charge is the equivalent of 15 days of the monthly rental charge (+VAT) with a minimum fee of £450 (inc.VAT) up to a maximum of £650 (inc.VAT). Other fees may apply depending on your circumstances.

**0118 960 1055**

**[lettings@haslams.net](mailto:lettings@haslams.net) [www.haslams.net](http://www.haslams.net)**

**Haslams Estate Agents Ltd, 159 Friar Street, Reading, Berkshire, RG1 1HE**





# Reading Road, Pangbourne, Reading, RG8

Approximate Area = 317 sq ft / 29.4 sq m

For identification only - Not to scale

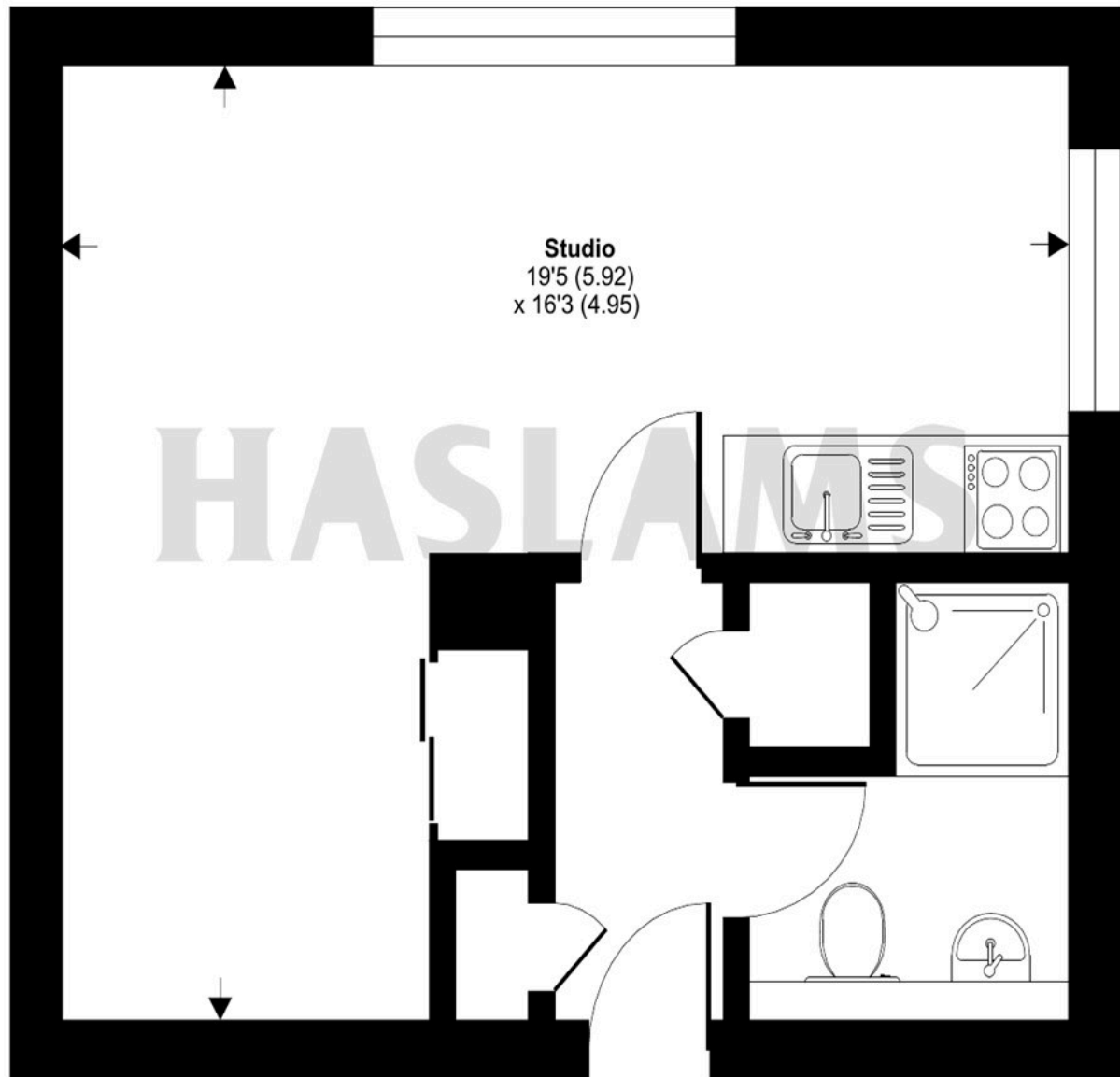
**GROUND FLOOR**

Floor plan produced in accordance with RICS Property Measurement 2nd Edition,  
Incorporating International Property Measurement Standards (IPMS2 Residential). © nichecom 2025.  
Produced for Haslamss. REF: 1329142