

12 Rochdale Road, Manchester, M4 4HT

Guide price £195,000

- Completed development with fully tenanted apartments
- High-quality fixtures and finishes throughout
- Excellent access to Manchester city centre and transport links
- Attractive rental yields circa 7.5%–8%
- Located in Manchester's popular and fast-growing M4 district
- Ideal turnkey investment opportunity with immediate rental income
- Selection of 1 and 2 bedroom apartments available
- Strong and consistent rental demand from professionals

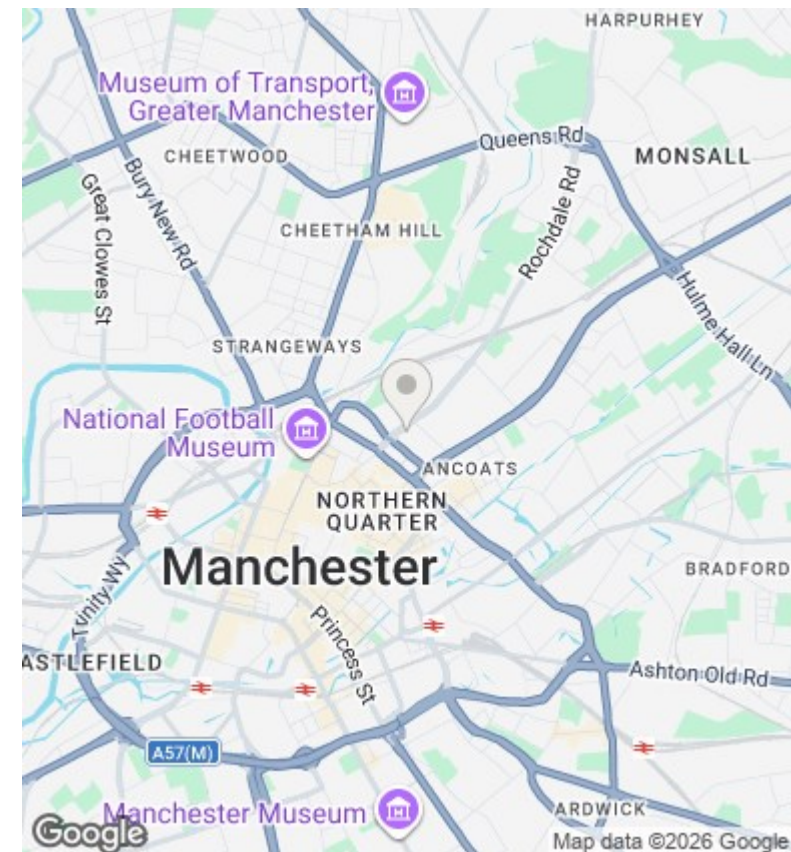
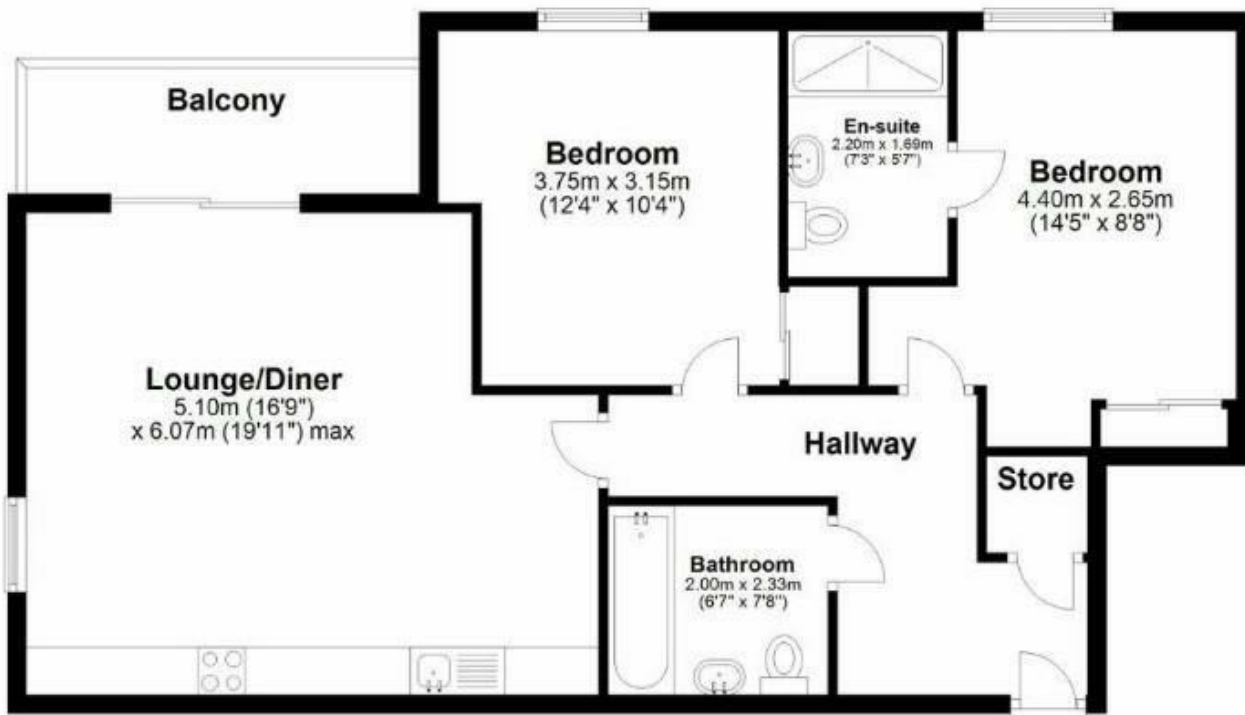

Directions

Viewings

Viewings by arrangement only. Call 0113 3224 345 to make an appointment.

Council Tax Band

EPC Rating:

Energy Efficiency Rating		
	Current	Potential
<i>Very energy efficient - lower running costs</i>		
(92 plus) A		
(81-91) B		
(69-80) C		
(55-68) D		
(39-54) E		
(21-38) F		
(1-20) G		
<i>Not energy efficient - higher running costs</i>		
England & Wales	EU Directive 2002/91/EC	