



1 Kingfisher Fields, Pershore

Fixed Price **£197,750**

**SHELDON
BOSLEY
KNIGHT** LAND AND
PROPERTY
PROFESSIONALS



1 Kingfisher Fields

Pershore, Pershore

Council Tax band: C

Tenure: Freehold

EPC Energy Efficiency Rating: B

EPC Environmental Impact Rating: B

- NO ONWARD CHAIN
- THREE BEDROOM SEMI DETACHED
- KITCHEN BREAKFAST ROOM
- SPACIOUS LOUNGE
- FAMILY BATHROOM, WC AND EN-SUITE
- PLENTY OF STORAGE
- PRIVATE REAR GARDEN
- MODERN AND WELL PRESENTED
- CLOSE TO LOCAL AMENITIES
- VIEWING HIGHLY ADVISED





Ground Floor

Approx. 39.4 sq. metres (424.4 sq. feet)

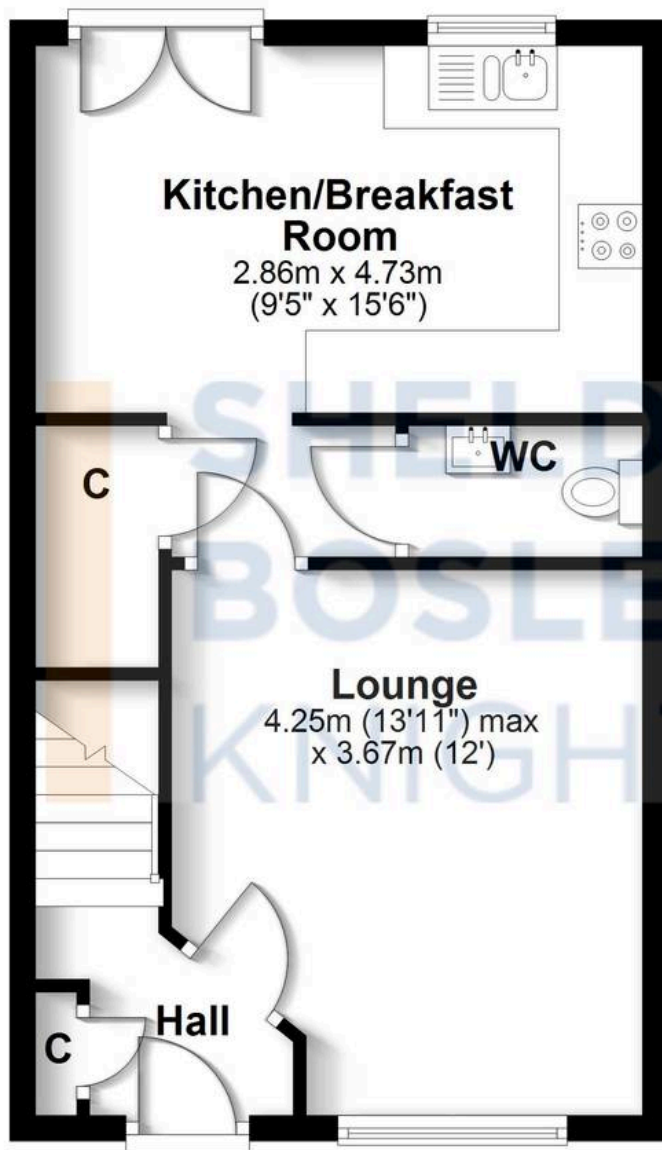

First Floor

Approx. 39.0 sq. metres (419.8 sq. feet)

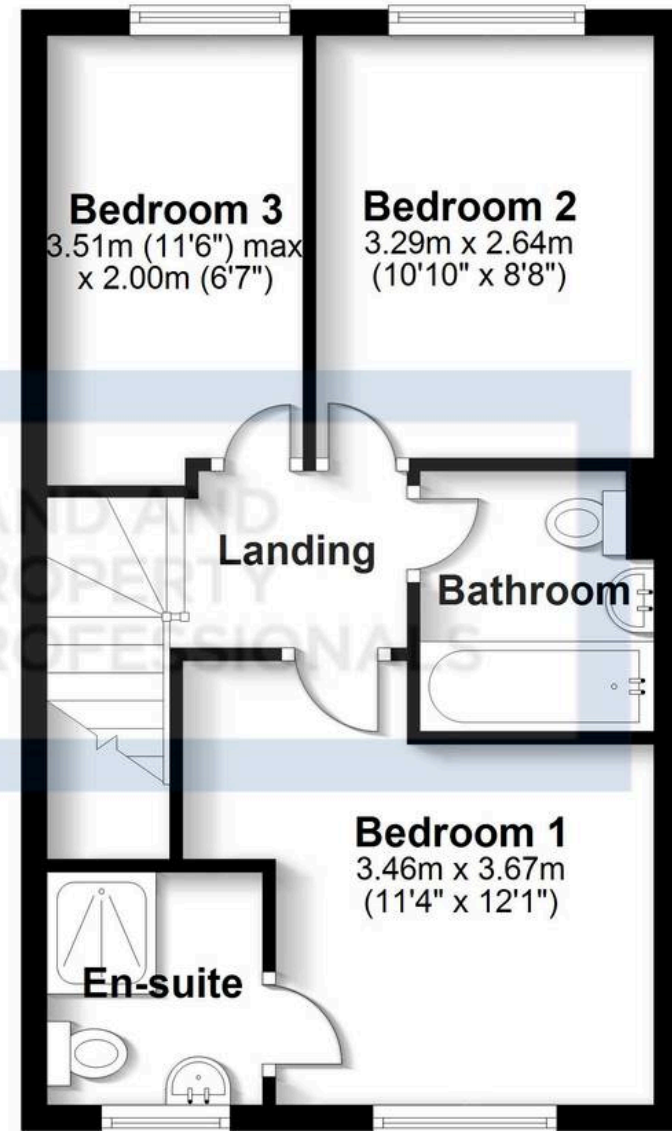

Total area: approx. 78.4 sq. metres (844.2 sq. feet)

All efforts have been made to ensure the measurements are accurate on this floor plan, however these are for guidance purposes only.

Plan produced using PlanUp.