



Sherbourne Crescent

, Coundon, CV5 8LG

£1,000 PCM



Pointons are pleased to offer this well-presented three-bedroom terrace home, situated in a popular residential area of Coventry. Offering generous living space throughout, this property is ideally suited to families or professional tenants looking for a home close to local amenities, schools and excellent transport links.

The accommodation comprises a bright and spacious through lounge/diner, a modern fitted kitchen with ample cupboard space, three well-proportioned bedrooms, and a contemporary shower room. Externally, the property benefits from a private enclosed rear garden with lawn and patio areas, providing the perfect space to relax or entertain.

Conveniently located within easy reach of local shops, public transport, and major road networks, this property offers comfortable living in a sought-after location. EPC - D / Council Tax -B



Area Map

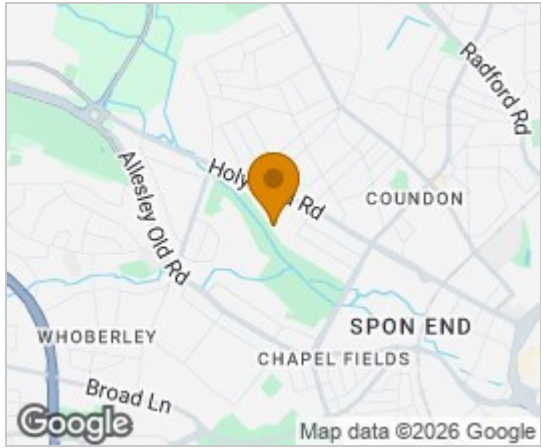

Floor Plans

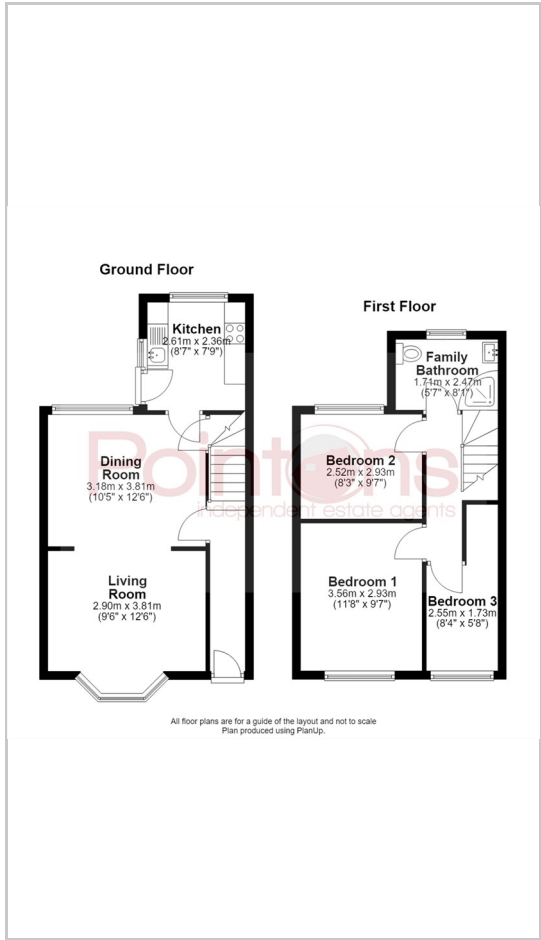

Energy Efficiency Graph

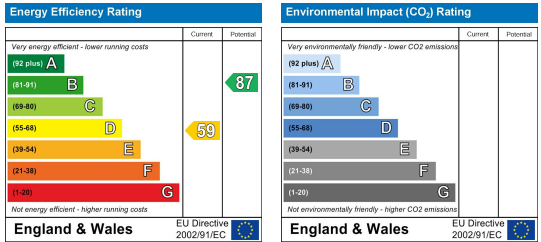

These particulars, whilst believed to be accurate are set out as a general outline only for guidance and do not constitute any part of an offer or contract. Intending purchasers should not rely on them as statements of representation of fact, but must satisfy themselves by inspection or otherwise as to their accuracy. No person in this firm's employment has the authority to make or give any representation or warranty in respect of the property.

109 NEW UNION STREET
COVENTRY, CV1 2NT
 coventry@pointons-group.com
024 7710 333
 Company No: 7359350

BOND GATE CHAMBERS
 NUNEATON, CV11 4AL
 nuneaton@pointons-group.com
024 7637 3300
 Company No: 6743033

74 LONG STREET
ATHERSTONE, CV9 1AU
 atherstone@pointons-group.com
 01827 711911
 Company No: 81323250



www.pointons-group.com

VAT NO 742186125