

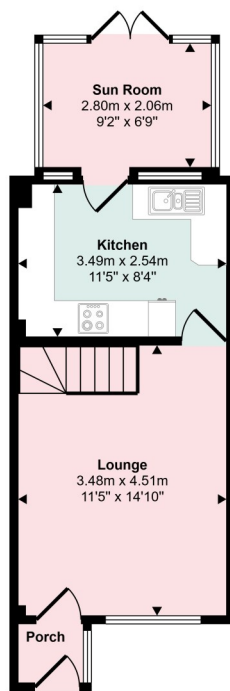

43 Oxhill Place, Dumbarton, G82 4EX

This beautifully maintained two-bedroom mid-terrace home is located in the ever-popular Oxhill Place, offering stylish interiors, excellent storage, and low-maintenance outdoor space. Ideal for first-time buyers, downsizers, or those seeking a well-presented home in a quiet residential setting.

Approx Gross Internal Area
58 sq m / 622 sq ft



Ground Floor
Approx 33 sq m / 354 sq ft

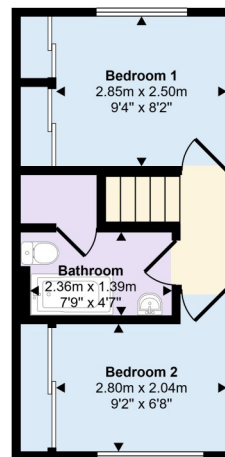

First Floor
Approx 25 sq m / 268 sq ft

This floorplan is only for illustrative purposes and is not to scale. Measurements of rooms, doors, windows, and any items are approximate and no responsibility is taken for any error, omission or mis-statement. Icons of items such as bathroom suites are representations only and may not look like the real items. Made with Made Snappy 360.



David Muir Estate Agents
2 Church Street, Dumbarton,
G82 1QL



Tel 01389 734366
Fax 01389 742476



tracy@davidmuirestates.co.uk



davidmuirestates.com



davidmuirestates

Travel Directions

Travelling west from Dumbarton towards Helensburgh. After crossing the Artizan Bridge continue through 2 sets of traffic lights into Cardross Road. Take the second on your left into Oxhill Road. Continue to end of the road and veer left into Oxhill Place. No 43 is on your left.

Additional Information

Home Report Valuation: £145,000
Asking Price: Offers Over £143,000
Council Tax Band: C
Energy Efficiency Rating: C
Gas Central Heating
Double Glazing

Home Report

This property benefits from a Home Report which can be obtained from davidmuirestates.com or onesurvey.org

Disclaimer

These property details are set out as a general outline only and do not constitute any part of an Offer or Contract. All fixtures and fittings mentioned in these particulars are included in the sale. All others in the property are specifically excluded. Photographs are reproduced for general information and it must not be inferred that any item is included for sale with the property. All measurements, distances and areas are approximate and for guidance only.