



Mount Park Road

Harrow, HA1 3JS

£2,400 Per month



A generous three bedroom ground floor apartment in a gated, listed Tudor-style building on the exclusive Mount Park Estate.



Set within the exclusive gated Mount Park Estate, this generous three bedroom ground floor apartment offers rare space and heritage in a listed Tudor-style building.

The home features three larger-than-average bedrooms, a separate fitted kitchen and dining room, and a spacious lounge with access to the gardens. Additional benefits include a modern bathroom, hardwood flooring, and a large walk-in storage room, plus landscaped communal gardens and secure gated entry.

Walking distance to the Piccadilly Line, close to Waitrose, Harrow-on-the-Hill, and the Metropolitan Line.

Area Map

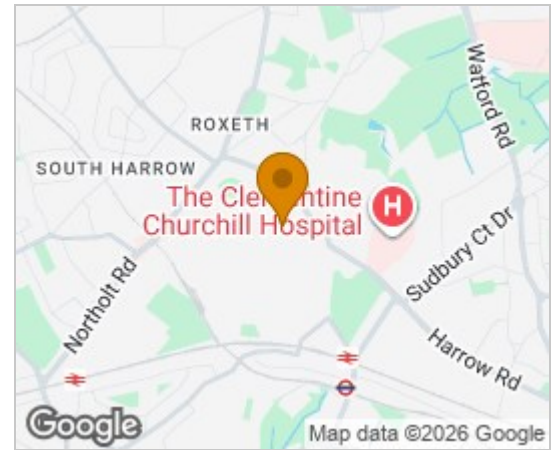

Floor Plans

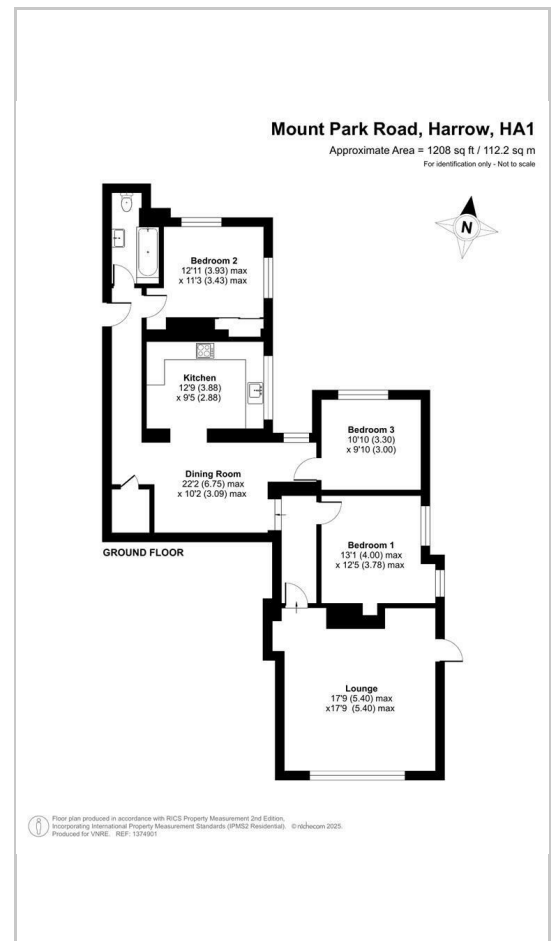

Energy Efficiency Graph

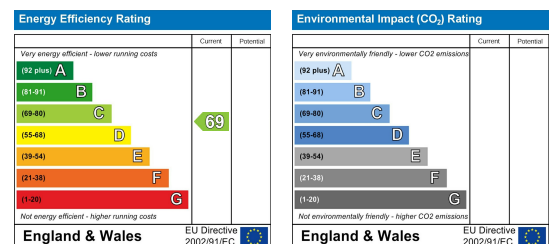

These particulars, whilst believed to be accurate are set out as a general outline only for guidance and do not constitute any part of an offer or contract. Intending purchasers should not rely on them as statements of representation of fact, but must satisfy themselves by inspection or otherwise as to their accuracy. No person in this firm's employment has the authority to make or give any representation or warranty in respect of the property.