



**Warwick Court Princes Drive, Harrow, HA1 4UB**

**In Excess of £300,000 | Leasehold**



**LAWRENCE RAND**





## Key Features & Description:

- Stylish and spacious two-bedroom flat in a sought after residential area
- Bright open plan living area with large windows and natural light
- Modern fitted kitchen & bathroom
- Primary bedroom with en-suite for added privacy and comfort

Two bedroom flat that perfectly captures the essence of modern urban living. Situated in a highly desirable residential area, this beautifully presented home offers a harmonious blend of style, comfort, and everyday convenience. Upon entry, a welcoming foyer leads into a spacious open plan living area, where large windows fill the room with natural light, creating a bright and inviting atmosphere ideal for both relaxation and entertaining. Laminate flooring throughout and neutral décor provide a contemporary backdrop suited to any interior style.

The modern fitted kitchen is a standout feature, boasting high end stainless steel appliances, generous worktop space, and stylish cabinetry a perfect setting for both casual cooking and hosting dinner guests. The primary bedroom offers a peaceful retreat with generous proportions and a private en suite bathroom. The second bedroom provides excellent versatility, ideal as a guest room, home office, or children's bedroom. A contemporary family bathroom with quality fittings adds to the home's comfort and convenience. **Presented with care by Lawrence Rand - helping you find the place you'll love to call home.**





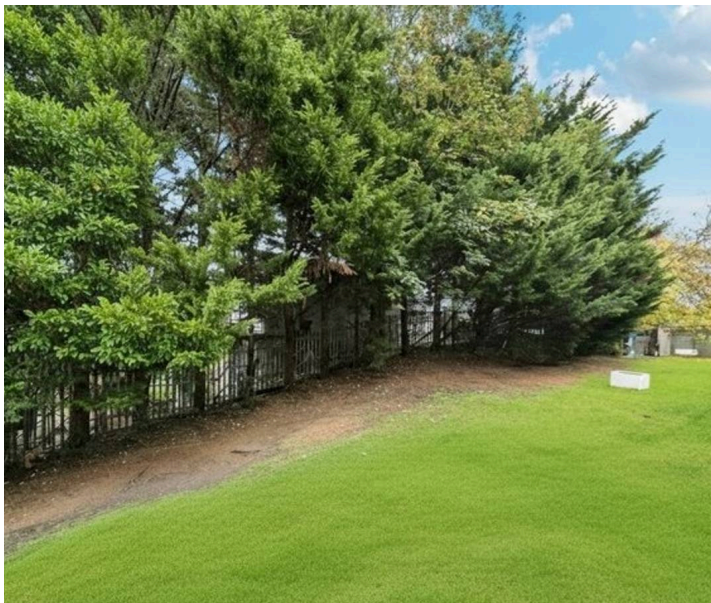

### **Nearest Stations:**

Harrow & Wealdstone (Rail & Underground) – 0.2 miles provides National Rail services, London Underground (Bakerloo) and London Overground connections

Headstone Lane (Overground) – 0.95 miles: National Rail services on the Watford line.

Harrow-on-the-Hill (Tube & Rail) – 0.96 miles:

### **Verified Material Information:**

Energy Performance rating: D

Council tax band: C, Local Authority: London Borough of Harrow

Service charge and ground rent: £2447 per year

Length of lease: 145 years

### **Suppliers:**

Electricity supply: Mains, Water supply: Mains water, Sewerage: Mains Heating: Gas central heating

### **Broadband & mobile coverage:**

Broadband: FTTP (Fibre to the Premises) Mobile coverage: O2 - Excellent, Vodafone - Excellent, Three - Excellent, EE Excellent



## Warwick Court, Princes Drive, Harrow, HA1

Approximate Area = 510 sq ft / 47.4 sq m

For identification only - Not to scale

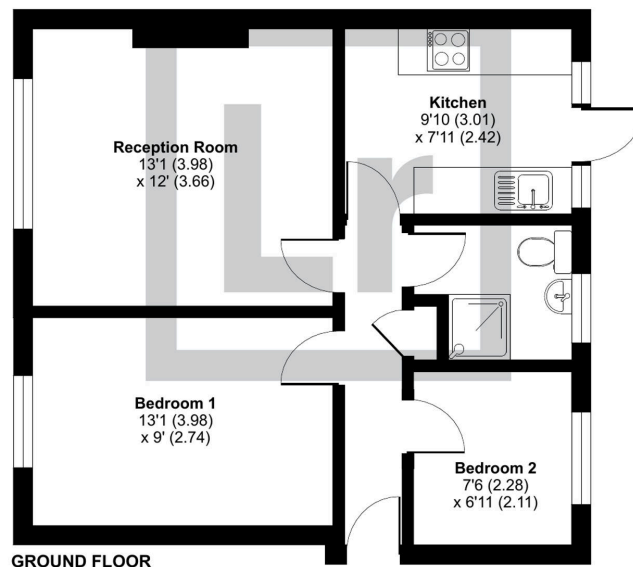

Floor plan produced in accordance with RICS Property Measurement 2nd Edition,  
Incorporating International Property Measurement Standards (IPMS2 Residential). © nichecom 2025.  
Produced for Lawrence Rand. REF: 1376586

## Lawrence Rand

51 Victoria Road, Ruislip - HA4 9BH

01895 632211

[Sales@lawrence-rand.co.uk](mailto:Sales@lawrence-rand.co.uk)

[www.lawrence-rand.co.uk](http://www.lawrence-rand.co.uk)

Lawrence Rand Limited has made every reasonable effort to ensure the accuracy of the information provided. However, we accept no responsibility for errors, omissions, or misstatements. All measurements, distances, and descriptions are approximate and for guidance only. Prospective purchasers or tenants must verify all details independently. Some images may include AI-generated virtual staging to illustrate the potential of the property and are for visual guidance only. No warranty is given or implied, and these particulars do not form part of any offer or contract. Lawrence Rand reserves the right to amend or withdraw any property without notice.