



hrt
herbert r thomas

Apt 6, Horizon Slon Lane, Ogmores-By-Sea

£395,000

Apartment 6

Horizon Slon Lane

Stylish 2-bed ground floor apartment with sea views, private patio, parking, underfloor heating, set in an exclusive Ogmore-by-Sea development. Furniture pack available.

Council Tax band: E

Tenure: Leasehold

EPC Energy Efficiency Rating: B

EPC Environmental Impact Rating: B

- Beautifully presented 2-bedroom ground floor apartment
- Spectacular sea views across the Bristol Channel
- Exclusive development of just six apartments (built 2017)
- Open-plan living space with sliding doors to private patio
- Contemporary kitchen with integrated Smeg appliances
- Principal bedroom with ensuite and sea views
- High-quality bathroom with Duravit sanitary ware
- Full underfloor heating with mains gas supply
- Allocated parking to front and gated rear access
- Option to purchase furniture



Apartment 6, Horizon is a beautifully presented two-bedroom ground floor apartment enjoying a spectacular coastal location with outstanding sea views. Stylishly finished throughout, the property is also available with an option to purchase furniture and contents for immediate occupation. Built in 2017 as part of an exclusive development of just six apartments, the property is accessed via a shared ground floor hallway from both the front and rear parking areas. The apartment opens into a spacious and welcoming entrance hall featuring timber-effect ceramic flooring, which runs seamlessly throughout. There is a large double storage cupboard and access to a superb open-plan living and dining area.

The light-filled open plan **LIVING SPACE** features coated aluminium double-glazed sliding doors opening onto a private patio with uninterrupted views across the communal gardens towards the Bristol Channel and West Country coastline. It flows into a contemporary **KITCHEN** in charcoal and light grey, with sleek worktops, a stainless steel one-and-a-half bowl sink, and integrated Smeg appliances including twin ovens, ceramic hob with extractor, fridge freezer, and dishwasher.

A **SECONDARY HALLWAY** offers excellent storage via a large walk-in cupboard housing the mains gas combi boiler, with space for a washing machine and tumble dryer. The **PRINCIPAL BEDROOM** is a generous double with full-length side windows enjoying sea views, complemented by a high-specification **ENSUITE** with walk-in shower, WC, basin, heated towel rail, and quality tiling.

The **SECOND BEDROOM** is also a well-proportioned double with timber-effect ceramic flooring. The **MAIN BATHROOM** features Duravit sanitary ware, including a basin, WC, and panel bath with shower and screen, plus a heated towel rail.

Externally, there is dedicated parking to the front and additional secure gated parking to the rear. The communal gardens are mainly laid to lawn with established shrubs and offer sweeping 180-degree sea views. The private patio, exclusive to Apartment 6, also enjoys these coastal views.

Further benefits include mains gas and underfloor heating throughout. This immaculately presented apartment occupies a stunning coastal setting and is available furnished, ideal for immediate occupation.

Directions;

From Cowbridge travel west along the A48. At the bottom of Crack Hill, turn left and travel through the villages of Corntown and Ewenny. At the T-junction turn left and then right and follow this road into Ogmore-by-Sea. Take the right turn onto 'Slon Lane' where you will find Apartment 6 at the end of the road.



hrt
herbert r thomas



GROUND FLOOR
983 sq.ft. (91.3 sq.m.) approx.

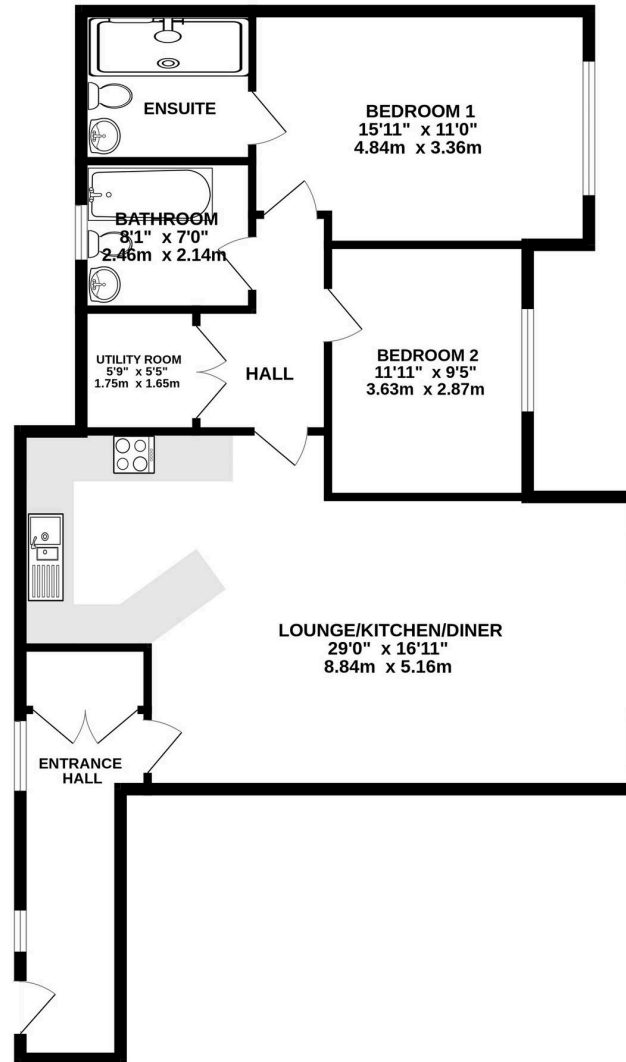

TOTAL FLOOR AREA : 983 sq.ft. (91.3 sq.m.) approx.

Whilst every attempt has been made to ensure the accuracy of the floorplan contained here, measurements of doors, windows, rooms and any other items are approximate and no responsibility is taken for any error, omission or mis-statement. This plan is for illustrative purposes only and should be used as such by any prospective purchaser. The services, systems and appliances shown have not been tested and no guarantee as to their operability or efficiency can be given.
Made with Metropix ©2026





Herbert R Thomas

Herbert R Thomas, 59 High Street - CF71 7YL

01446772911 • cowbridge@hrt.uk.com • www.hrt.uk.com/



These particulars are provided as a general guide only and do not form part of any contract offer. While believed to be accurate, they are not guaranteed. Some images may include CGI or digitally enhanced furnishings for illustrative purposes only and are not included in the sale. All negotiations must be conducted through Herbert R Thomas.