

HUNTERS[®]

HERE TO GET *you* THERE



Drysdale Street

London, N1 6ND

£2,750 Per Calendar Month



An exceptional apartment just off Hoxton Square, located in a modern, architecturally designed development. This secure, gated property spans 882 sq ft and features a spacious double bedroom, a contemporary living area with floor-to-ceiling windows that flood the space with natural light, a sleek, fully integrated kitchen with an island, and a stylish modern bathroom.

Perfectly positioned on the edge of Shoreditch High Street, the apartment offers excellent transport links and easy access to a vibrant selection of restaurants, bars, and entertainment options. Old Street and Shoreditch High Street stations provide convenient tube and overground connections to destinations across London.



Area Map



Floor Plans

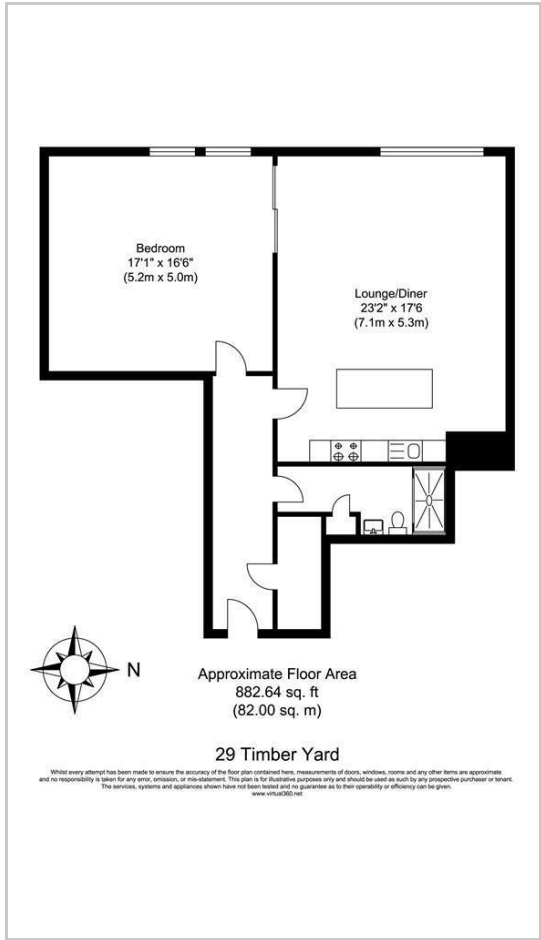

Energy Efficiency Graph

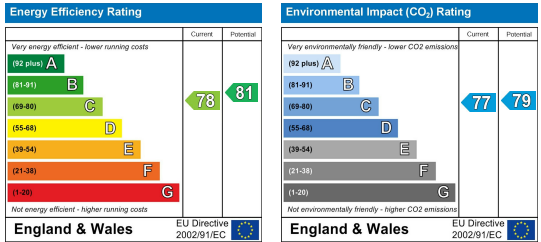

These particulars are intended to give a fair and reliable description of the property but no responsibility for any inaccuracy or error can be accepted and do not constitute an offer or contract. We have not tested any services or appliances (including central heating if fitted) referred to in these particulars and the purchasers are advised to satisfy themselves as to the working order and condition. If a property is unoccupied at any time there may be reconnection charges for any switched off/disconnected or drained services or appliances - All measurements are approximate. **THINKING OF SELLING?** If you are thinking of selling your home or just curious to discover the value of your property, Hunters would be pleased to provide free, no obligation sales and marketing advice. Even if your home is outside the area covered by our local offices we can arrange a Market Appraisal through our national network of Hunters estate agents.