



Eastney Street, SE10

£415,000

A well presented three bedroom purpose built flat which is offered to the market chain free. This would make an ideal first purchase and a viewing is highly recommended.

Eastney street is a quiet residential street located a short walk from Maze Hill Mainline Station providing direct links to London Bridge, Cannon Street and St Pancras. Greenwich Park is located nearby as are the many historical attractions of Greenwich including the National Maritime Museum, Royal Observatory and the Royal Naval College. There are an array of local shops, restaurants and cafés along Trafalgar Road for residents to enjoy while larger supermarkets are also within easy reach. A number of popular nurseries and schools for families are also in the local vicinity.

Features

- Three Bedrooms
- Chain Free
- Purpose Built
- Sought After Location
- Ideal First Purchase



Eastney Street, SE10



Eastney Street,
London, SE10

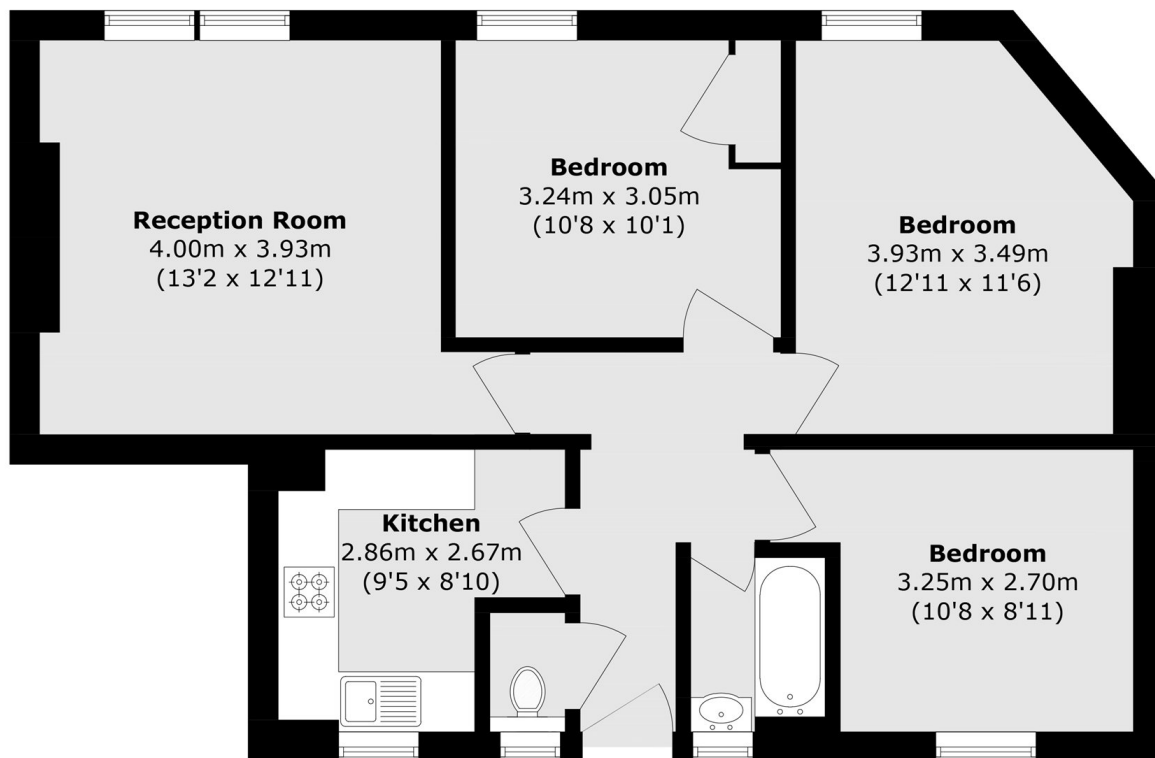

Total area (approx.): 67.1 sq. m (722.3 sq. ft)