



ICONIC
ESTATE AGENTS

Cowdewell Mews, Taverham
£950 pcm Freehold



- Well Presented Mid Terrace House
- Porch Entrance
- Two Bedrooms
- Lounge
- Luxury Kitchen With Integrated Appliances
- Modern Bathroom Suite
- Enclosed Garden With Shed
- Two Allocated Parking Spaces
- Available From August 2024
- EPC Rating C / Council Tax Band B

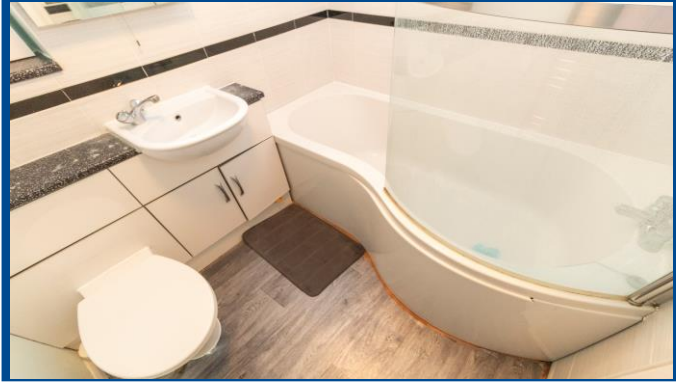

GROUND FLOOR

1ST FLOOR

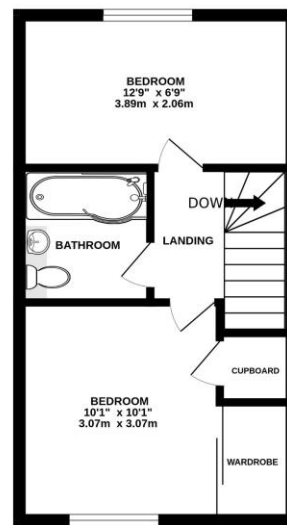
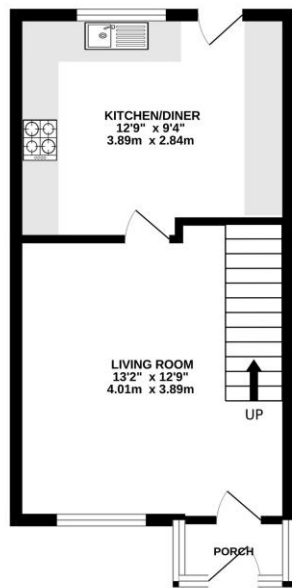

Whilst every attempt has been made to ensure the accuracy of the floorplan contained here, measurements of doors, windows, rooms and any other items are approximate and no responsibility is taken for any errors, omissions or mis-statement. This plan is for illustrative purposes only and should be used as such by any prospective purchaser. The services, systems and appliances shown have not been tested and no guarantee is given as to their operability or efficiency can be given.
Made with MettPro 12/2024

Leave Norwich via Drayton Road and continue onto Drayton High Road heading towards Taverham. Take the first turning into Windsor Chase and take the second left into Ashdown. Take the first turning into Mokyll Croft and the second turning into Cowdewell Mews where the property can be found indicated by our For Sale Board.

Viewings strictly by appointment with: 297 Fakenham Road, Norwich, NR8 6LE

Taverham **01603 261104**
Norwich **01603 740044**



We bring to prospective purchasers attention that we, as estate agents for the property, have not tested any appliances and purchasers should make their own enquiries of the relevant Authorities regarding the connection and viability of all services. These particulars, whilst believed to be accurate are set out as a general outline only for guidance and do not constitute any part of an offer or contract. Intending purchasers should not rely on them as statements of representation of fact, but must satisfy themselves by inspection or otherwise as to their accuracy.