



CASSILIS ROAD, E14

£500,000

A two bedroom, two bathroom property consisting of a spacious, semi-open plan reception/ kitchen with access to a private balcony, two large double bedrooms, the principal of which provides access to an en suite and both feature built in storage, and a family bathroom.

- Two Double Bedrooms
- Two Bathrooms
- Private Balcony
- 24 Hour Concierge
- Gym
- Built In Storage

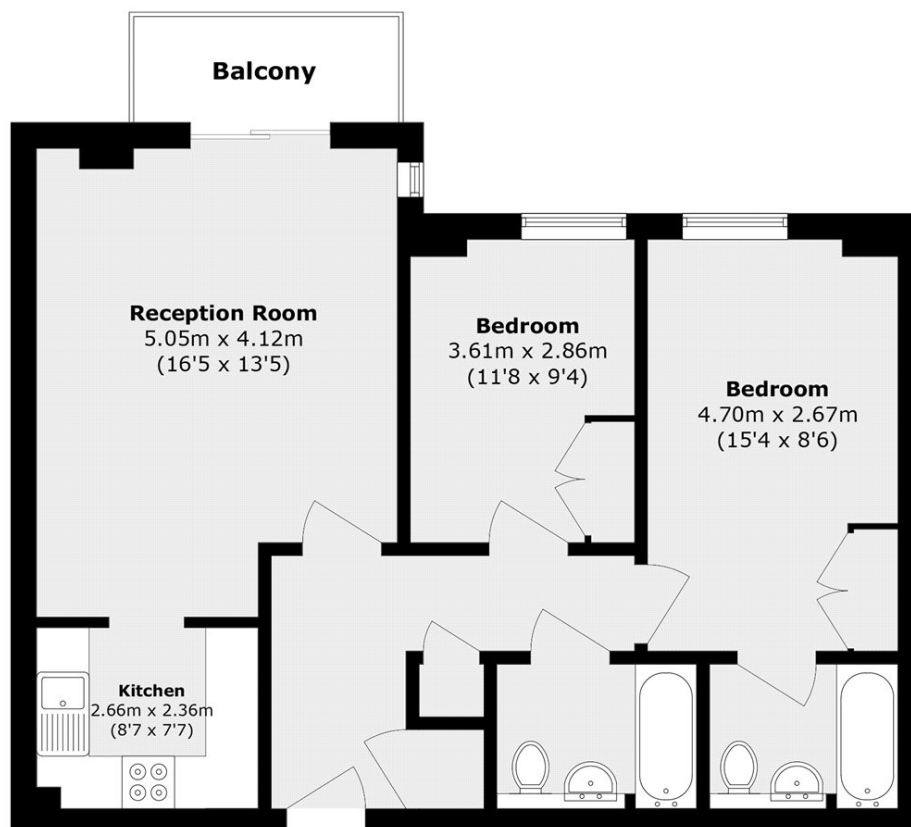

Total area (approx.): 68.2 sq. m (734.1 sq. ft)

Balcony area (approx.): 3.6 sq. m (38.7 sq. ft)

LiFE RESIDENTIAL

36 Millharbour, London, E14

9JS

Sales: 020 3668 1033

Lettings: 020 3668 1030

Energy Rating: C. We aim to make our particulars both accurate and reliable. However they are not guaranteed; nor do they form part of an offer or contract. If you require clarification on any points then please contact us, especially if you're traveling some distance to view. Please note that appliances and heating systems have not been tested and therefore no warranties can be given as to their good working order.