



NORTH BLOCK, SE1

£400,000

A one-bedroom apartment in the County Hall development, Waterloo, featuring a bright, spacious living area, a modern fully equipped kitchen, and an updated bathroom. Residents also enjoy year-round access to the gym and swimming pool.

- One Double Bedroom
- 24 Hour Concierge
- Gym & Pool
- London Eye
- 0.3m to Waterloo Station
- EPC: C



ABOUT THE HOME

County Hall is enviably located, on the South Bank, tucked just back from the riverside and adjacent to Waterloo station, with incredible transport links across the city. Nearby are numerous attractions, restaurants and amenities.





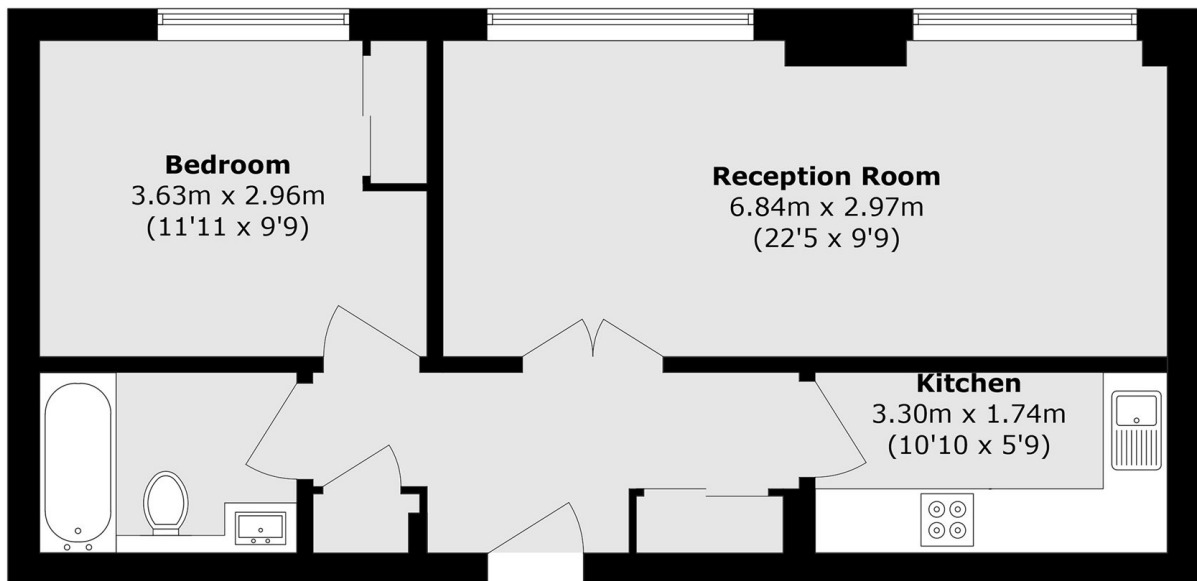

Total area (approx.): 50.7 sq. m (545.7 sq. ft)

LiFE RESIDENTIAL

252 Westminster Bridge
Road, London, SE1 7PD
Sales: 020 7476 0125
Lettings: 020 7620 1600

Energy Rating: C. We aim to make our particulars both accurate and reliable. However they are not guaranteed; nor do they form part of an offer or contract. If you require clarification on any points then please contact us, especially if you're traveling some distance to view. Please note that appliances and heating systems have not been tested and therefore no warranties can be given as to their good working order.