



AGENTS NOTE: There is a maintenance charge for the development of £214.56 for 2026. We understand there may be a Deed of Variation required and recommend you seek advice from your solicitor. C G Fry & Son have development plans for the land adjacent to Meyer Close.

LOCATION: Meyer Close is located on the Cades Farm development within walking distance of the town centre, a supermarket and bus route with a local primary school located close by. Wellington offers a wide range of independently run shops and larger national stores including the well renowned Waitrose. The town also benefits from a good assortment of educational and leisure amenities such as a Sport Centre with its own swimming pool and local cinema. The town itself stands between the River Tone and the Blackdown Hills. The County Town of Taunton is approximately 7 miles distant with its mainline railway station and the M5 can be accessed via Junction 26 just outside the town.

DIRECTIONS: From our Wellington office proceed in the Taunton direction passing through the traffic lights, take the second exit at the first roundabout and the third exit at the second roundabout into Cades Farm. Follow the road through to the end of the development where you will enter Meyer Close as indicated by the Green space directly in front of you. Follow the road around to the left hand side where number 9 will be located tucked away in the corner.

GENERAL REMARKS AND STIPULATION

Tenure: The property is offered for sale Freehold, by private treaty with vacant possession on completion.

Services: Mains electricity, mains water, mains drainage, gas central heating, telephone

Local Authority: Somerset Council, County Hall, The Crescent, Taunton, TA1 4DY.

Property Location: w3w.co///gentlemen.decorator.possible

Council Tax Band: B

Construction: Timber frame construction with a rendered outer leaf under a tiled roof

Broadband and mobile coverage: We understand that there is good mobile coverage. The maximum available broadband speeds are 1000 Mbps download and 1000 Mbps upload. We recommend you check coverage on <https://checker.ofcom.org.uk/>.

Flood Risk: Surface Water: very low **Rivers and the Sea:** very low **Reservoirs:** Unlikely **Groundwater:** Unlikely

We recommend you check the risks on <https://www.gov.uk/check-long-term-flood-risk>

Planning: Local planning information is available on <https://www3.somersetwestandtaunton.gov.uk/asp/webpages/plan/plapplookup.asp>

IMPORTANT NOTICE Wilkie May & Tuckwood for themselves and for the vendors of the property, whose agents they are, give notice that: 1. the particulars are intended to give a fair and substantially correct overall description for the guidance of intending purchaser and do not constitute part of an offer or contract. Prospective purchasers and lessees ought to seek their own professional advice. 2. All descriptions, dimensions, areas, reference to condition and necessary permissions for use and occupation and other details are given in good faith, and are believed to be correct, but any intending purchasers should not rely on them as statements or representations of fact but must satisfy themselves by inspection or otherwise as to the correctness of each of them. 3. No person in the employment of Wilkie May & Tuckwood has any authority to make or give any representations or warranty

whatever in relation to this property on behalf of Wilkie May & Tuckwood, nor enter into any contract on behalf of the vendor. 4. No responsibility can be accepted for any expenses incurred by intending purchasers in inspecting properties which have been sold, let or withdrawn. MEASUREMENTS AND OTHER INFORMATION All measurements are approximate. While we endeavour to make our sales particular accurate and reliable, if there is any point which is of particular importance to you, please contact the office and we will be pleased to check the information with you.

Code of Practice for Residential Estate Agents: Effective from 1 August 2011:

'8. Financial Evaluation 8a At the time that an offer has been made and is being considered by the seller, you must take reasonable steps to find out from the prospective buyer the source and availability of his funds for buying the property and pass this information to the seller. Such information will include whether the prospective buyer needs to sell a property, requires a mortgage, claims to be a cash buyer or any combination of these. Such relevant information that is available should be included in the Memorandum of Sale having regard to the provisions of the Data Protection Act.8b These reasonable steps must continue after acceptance of the offer until exchange of contracts (in Scotland, conclusion of missives) and must include regular monitoring of the prospective buyer's progress in achieving the funds required and reporting such progress to the seller.

The agent has not tested any apparatus, equipment, fixtures and fittings or services and so cannot verify that they are in working order or fit for their purpose. A Buyer is advised to obtain verification from their solicitor or surveyor. References to the Tenure of the Property are based on information supplied by the Seller. The agent has not had sight of the title documents. A Buyer is advised to obtain verification from their Solicitor.

GROUND FLOOR
308 sq.ft. (28.7 sq.m.) approx.

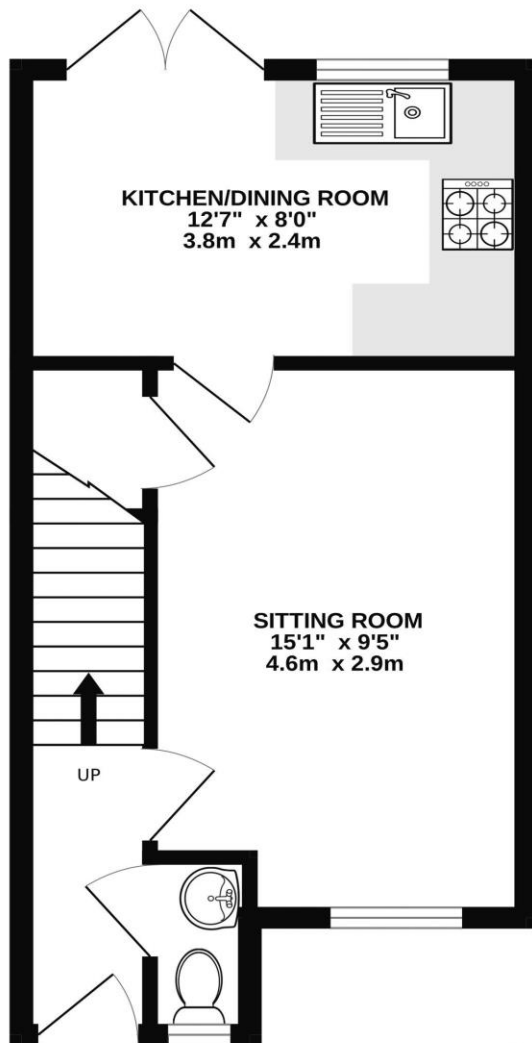

1ST FLOOR
290 sq.ft. (27.0 sq.m.) approx.

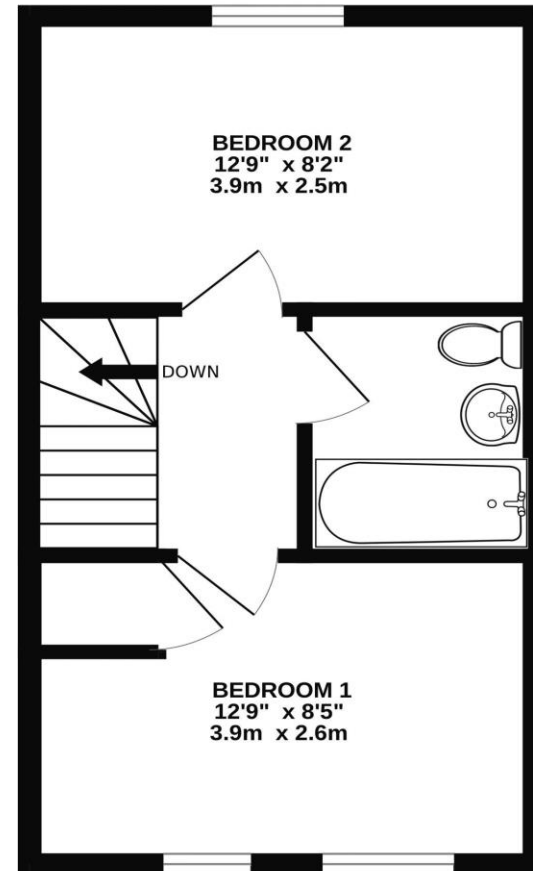

TOTAL FLOOR AREA : 599 sq.ft. (55.6 sq.m.) approx.

Whilst every attempt has been made to ensure the accuracy of the floorplan contained here, measurements of doors, windows, rooms and any other items are approximate and no responsibility is taken for any error, omission or mis-statement. This plan is for illustrative purposes only and should be used as such by any prospective purchaser. The services, systems and appliances shown have not been tested and no guarantee as to their operability or efficiency can be given.
Made with Metropix ©2026

9 Meyer Close is a spacious two double bedroom semi detached house set in a tucked away position on the popular Cades Farm development. The property has a delightful garden and parking for two vehicles.

Built in 2016 to The Alnwick design by Persimmon Homes, the accommodation comprises in brief; front door opens into the entrance hall with downstairs cloakroom, stairs to the first floor and a door to the sitting room. The sitting room provides ample space for furnishings with a window to the front elevation and useful under stairs storage.

To the rear of the property, there is a kitchen/dining room fitted with a range of modern wall and base units with integrated oven and gas hob. French doors open out to the garden.

To the first floor there are two generously sized double bedrooms serviced by the family bathroom which is fitted with a three piece white suite.

Externally, the property is set back from the road with off road parking for two vehicles. There is a wide side access to the garden which is predominantly laid to lawn and patio with mature borders and a Summer house.



- Two double bedrooms
- Off road parking for two vehicles
- Delightful rear garden
- Tucked away position on a modern development

