



The Dingle Whinfield Road, Dibden Purlieu, SO45 4QA
£625,000



ANTHONY JAMES
PROPERTIES



The Dingle Whinfield Road

Dibden Purlieu, Southampton

Offered to the market with no onward chain, this well presented detached three bedroom bungalow occupies an extensive 0.27 acre plot in the sought after village of Dibden Purlieu within the Wildground School catchment area. The accommodation is arranged to offer a spacious open plan living and dining room, ideal for both relaxing and entertaining. The kitchen is fitted with a range of units and provides access to the side of the property, while three well proportioned bedrooms offer flexible options for family living or home office use. The bathroom is fitted with a white suite and there is the additional benefit of a separate shower. The property further benefits from gas fired central heating and double glazing, ensuring comfort and efficiency year round. Externally, a generous driveway provides ample off road parking and leads to a car port and single garage, offering excellent storage and workshop potential. The size of the plot gives buyers significant scope to further enhance the property, whether by extending or reconfiguring the existing layout (subject to planning permission), making this a rare opportunity in such a popular area.

Council Tax band: E

Tenure: Freehold



1 Southward House
Dibden Purlieu SO45 4PT



T: 02380 844405

info@anthonyjamesproperties.co.uk





GROUND FLOOR
1223 sq.ft. (113.6 sq.m.) approx.

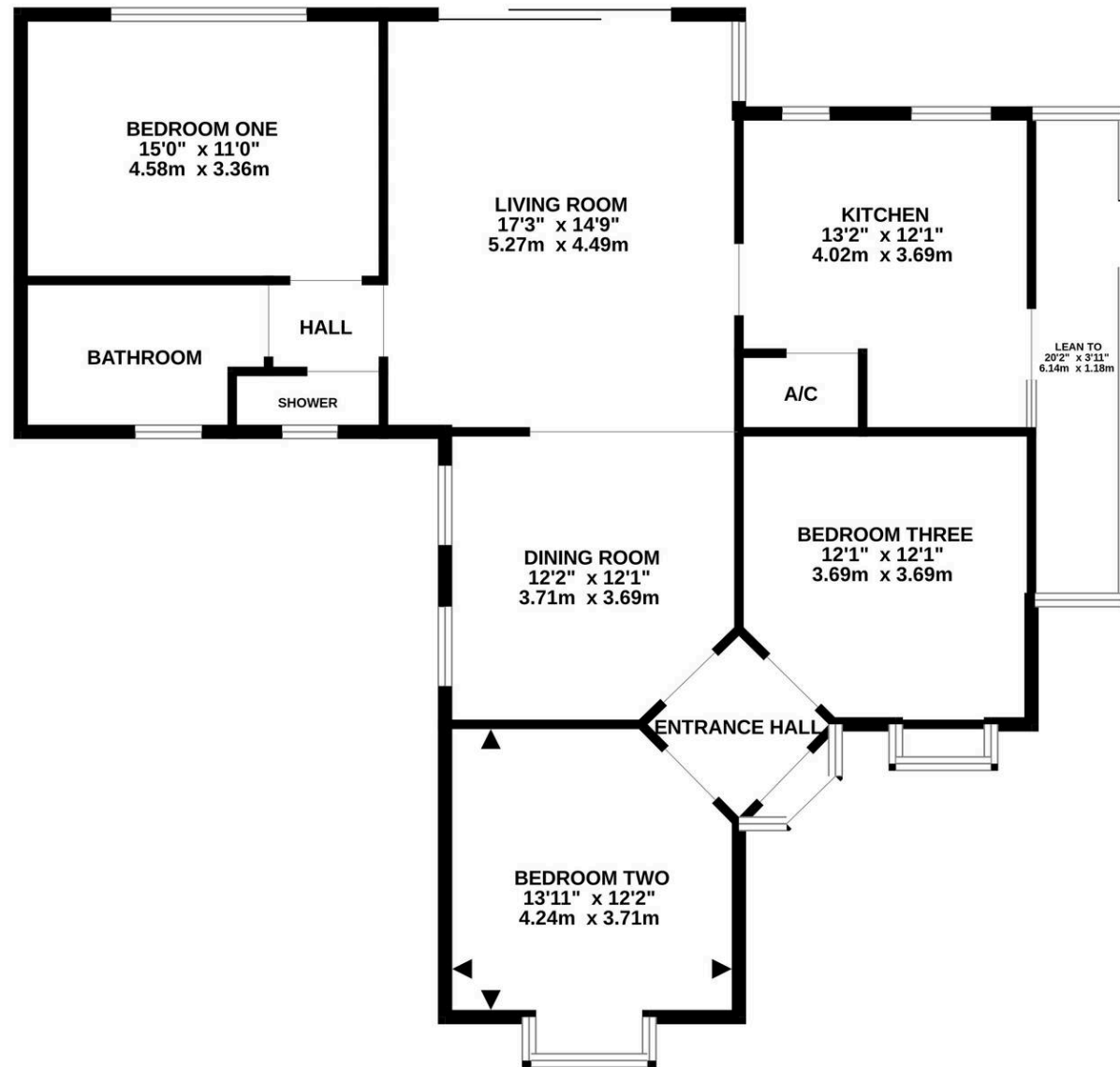

TOTAL FLOOR AREA: 1223 sq.ft. (113.6 sq.m.) approx.

Whilst every attempt has been made to ensure the accuracy of the floorplan contained here, measurements of doors, windows, rooms and any other items are approximate and no responsibility is taken for any error, omission or mis-statement. This plan is for illustrative purposes only and should be used as such by any prospective purchaser. The services, systems and appliances shown have not been tested and no guarantee as to their operability or efficiency can be given.
Made with Metropix ©2026