



1



1



1



c

DavidJames
the estate agent

Burton Road, Carlton, Nottingham, NG4 3DQ

£675 Per Calendar Month

About This Property

A modern one bedroom first floor apartment set in the popular Odlin Court development in Carlton with secure parking for one car. Neutral décor throughout, modern white bathroom suite and kitchen with oak effect wall and base units with integrated appliances including a washing machine, dishwasher and tall fridge freezer. This property is ideal for a single person or couples. Located a very short walk away from Carlton Precinct where you will find various shops and a large Tesco supermarket. Local attractions close by include the Gedling Country Park, Colwick Country Park and great transport links to the City Centre. There is also the Victoria Retail Park a short drive away and transport links to take you there.

TENANCY DETAILS

Available From: 13th March 2026
Tenancy Term: Minimum 6 months
Furnishing: Unfurnished
EPC Rating: C
Council Band: A
Pets: Not permitted

- Modern first floor apartment
- One double bedroom
- Open plan living
- Kitchen with integrated appliances
- Bathroom/WC with white suite and shower over the bath
- UPVC double glazing
- Gas central heating
- Secure gated car park with allocated space
- Close to local amenities and transport links



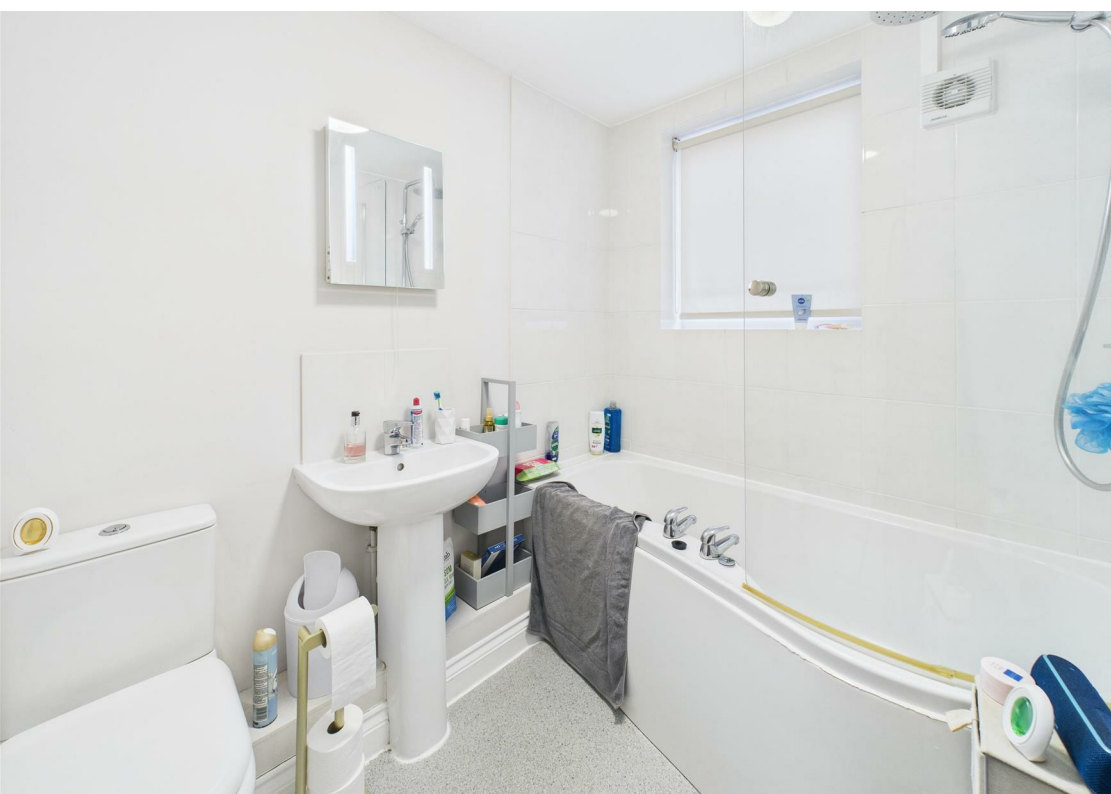

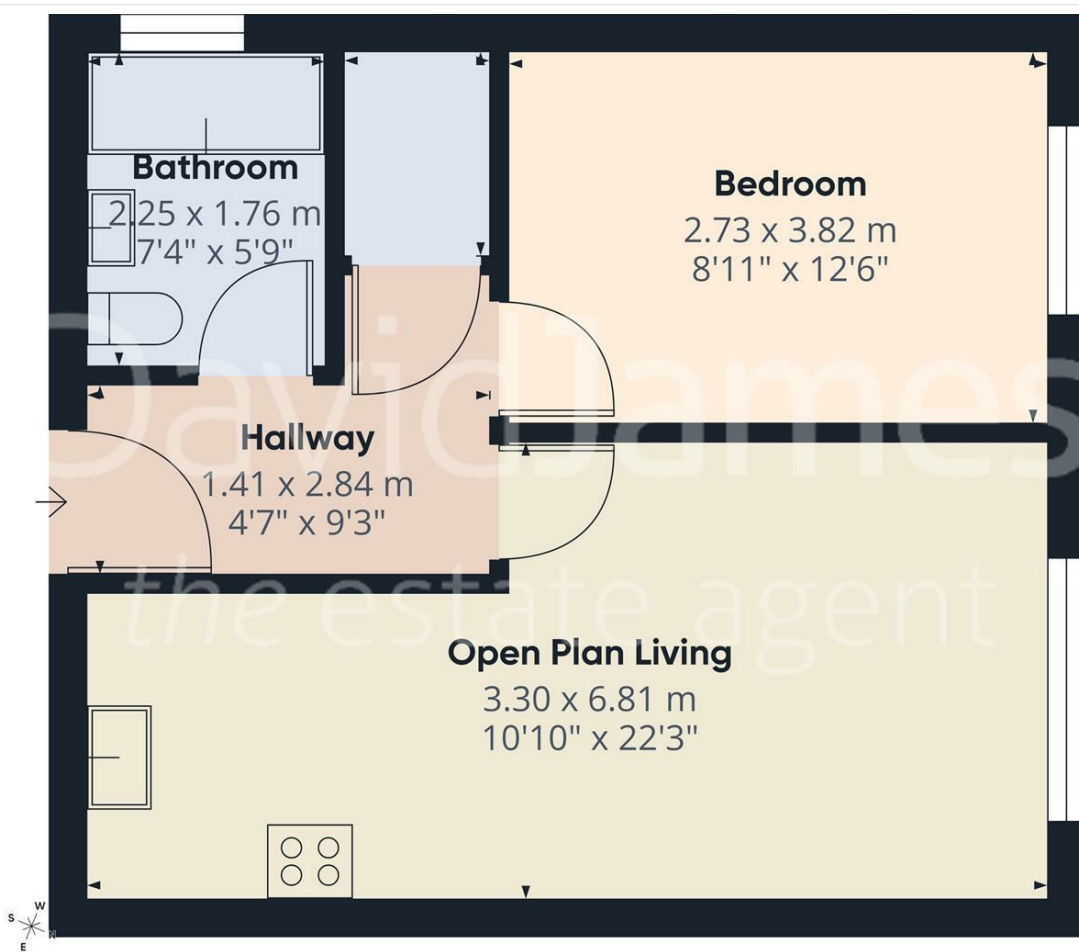

DavidJames
the estate agent

Approximate total area⁽¹⁾

40.7 m²
438 ft²

(1) Excluding balconies and terraces

Calculations reference the RICS IPMS 3C standard. Measurements are approximate and not to scale. This floor plan is intended for illustration only.

GIRAFFE360

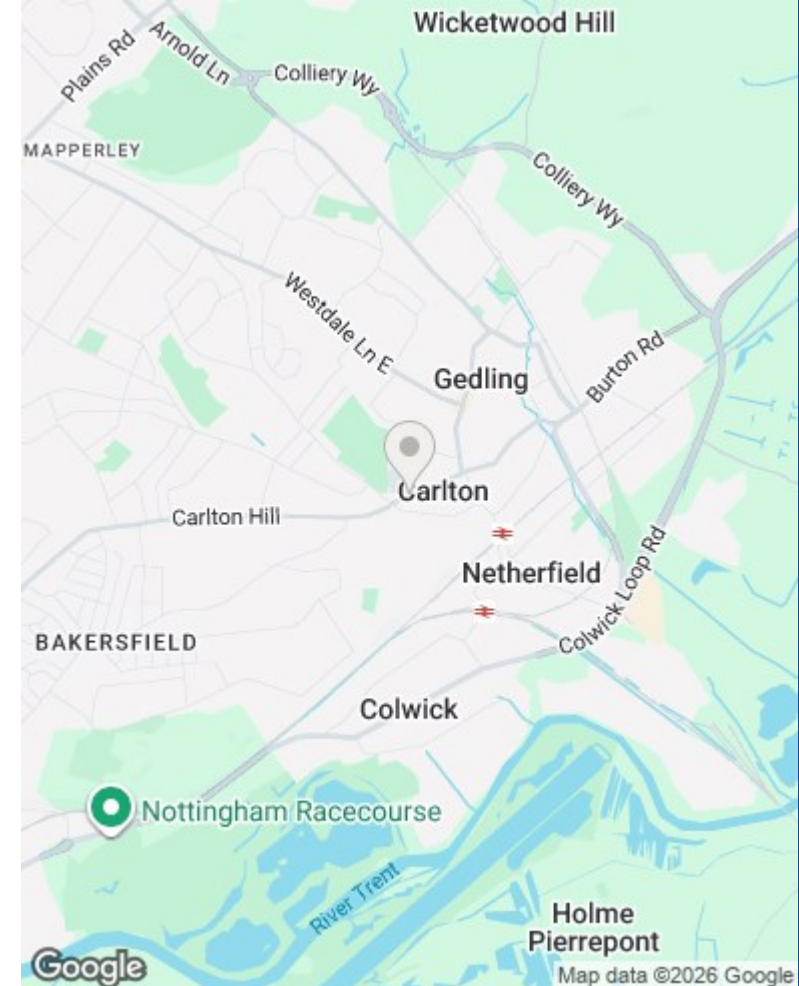

Council Tax Band: A
Gedling Borough Council

These particulars are produced in good faith, are set out as a general guide only and do not constitute any part of a contract. No person in the employment of David James Estate Agents Ltd has any authority to make any representation whatsoever in relation to the property. All services, together with electrical fittings or fitted appliances have NOT been tested. All the measurements given in the details are approximate. Floor plans are for illustrative purposes only and are not drawn to scale. The position and size of doors, windows, appliances and other features are approximate only. The photographs of this property have been taken with a 10mm wide-angle lens. No responsibility can be accepted for any loss or expense incurred in viewing. If you have a property to sell you may wish to take advantage of our free valuation service. David James Estate Agents have established professional relationships with third-party suppliers for the provision of services to Clients. As remuneration for this professional relationship, the agent receives referral commission from the third-party company. David James Estate Agents receives the following commission from each third party supplier on a per referral basis: W A Barnes Ltd: £60 including VAT. All Moves UK Ltd: 18% including VAT of the invoice total (£107 including VAT average). MoveWithUs Limited: £188 including VAT (average).

DavidJames
the estate agent

David James Estate Agents
45b Plains Road, Mapperley, Nottingham, NG3 5JU
t: 0115 962 4213 e: lettings@david-james.com

naea | propertymark
PROTECTED

