



**Berry Close, Hedge End, SOUTHAMPTON, SO30 0PJ**

**welcome to**

**Berry Close, Hedge End SOUTHAMPTON**

This well-presented family home is located in the heart of Hedge End and features a garage alongside attractively landscaped gardens.

Further benefits include three bedrooms, a family bathroom, a generous lounge, and a kitchen/dining room ideal for entertaining or suited to growing families.



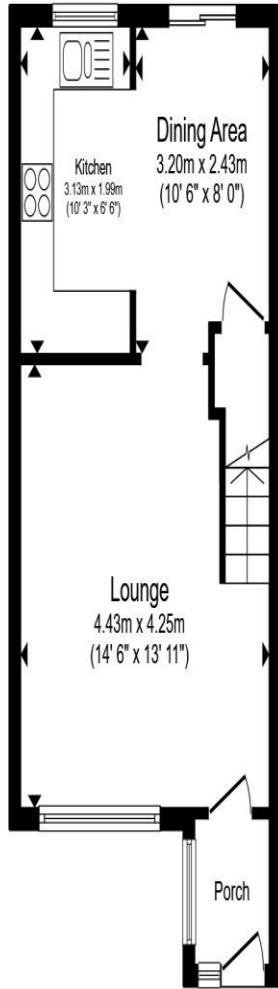

**Ground Floor**

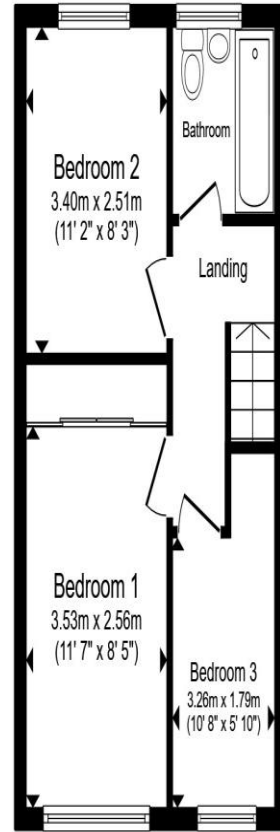

**First Floor**

Total floor area 69.6 m<sup>2</sup> (750 sq.ft.) approx

This floor plan is for illustrative purposes only. It is not drawn to scale. Any measurements, floor areas (including any total floor area), openings and orientation are approximate. No details are guaranteed, they cannot be relied upon for any purpose and they do not form part of any agreement. No liability is taken for any error, omission or misstatement. A party must rely upon its own inspection(s). Powered by [www.propertybox.io](http://www.propertybox.io)



**Entrance Porch**

**Lounge**

**Kitchen/Diner**

**Bedroom 1**

**Bedroom 2**

**Bedroom 3**

**Bathroom**

**Front**

**Rear Garden**

**Garage**

welcome to

## Berry Close, Hedge End SOUTHAMPTON

- Garage with additional parking also available locally
- Landscaped rear garden with separate patio and lawn areas and rear access
- Contemporary family bathroom with three piece bathroom suite
- Separate kitchen/dining room with a range of integrated appliances
- Spacious lounge

Tenure: Freehold EPC Rating: C

Council Tax Band: C

**£310,000**



Please note the marker reflects the postcode not the actual property

**view this property online** [fox-and-sons.co.uk/Property/HEE106336](https://fox-and-sons.co.uk/Property/HEE106336)



Property Ref:  
HEE106336 - 0002

1. MONEY LAUNDERING REGULATIONS Intending purchasers will be asked to produce identification documentation at a later stage and we would ask for your co-operation in order that there is no delay in agreeing the sale. 2. These particulars do not constitute part or all of an offer or contract. 3. The measurements indicated are supplied for guidance only and as such must be considered incorrect. Potential buyers are advised to recheck measurements before committing to any expense. 4. We have not tested any apparatus, equipment, fixtures or services and it is in the buyers interest to check the working condition of any appliances. 5. Where an EPC, or a Home Report (Scotland only) is held for this property, it is available for inspection at the branch by appointment. If you require a printed version of a Home Report, you will need to pay a reasonable production charge reflecting printing and other costs. 6. We are not able to offer an opinion either written or verbal on the content of these reports and this must be obtained from your legal representative. 7. Whilst we take care in preparing these reports, a buyer should ensure that his/her legal representative confirms as soon as possible all matters relating to title including the extent and boundaries of the property and other important matters before exchange of contracts.

  
fox & sons



**01489 785269**



[HedgeEnd@fox-and-sons.co.uk](mailto:HedgeEnd@fox-and-sons.co.uk)



Stirling House, 5 St. Johns Road, Hedge End,  
SOUTHAMPTON, Hampshire, SO30 4AA



[fox-and-sons.co.uk](https://fox-and-sons.co.uk)