



## Key Features

- ◆ Single Occupancy Room
- ◆ Council Tax and Water bills included
- ◆ Private kitchenette
- ◆ Shared use of shower room and WC
- ◆ Sought after Little Chelsea location
- ◆ EPC rating C

1  0  1 

Hyde Road, Eastbourne

£500 PCM



Council tax and Water Bills included in rent.

Northwood are delighted to welcome to the market this unfurnished, ground-floor, single-occupancy room in central Eastbourne.

Accommodation comprises of a good-sized room with private kitchenette, mini-oven, fridge-freezer, electric heating and uPVC double-glazed bay window.

Further benefits include shared use of shower room and separate WC.

Located in the ever-popular Little Chelsea area of Eastbourne, this large, single occupancy room is surrounded by boutique shops, bohemian cafés and local restaurants whilst being just a short walk from the town centre, mainline train station, theatres, cinema and Eastbourne's fabulous Victorian seafront.

Please view our immersive virtual tour to fully appreciate this fantastic property:  
<https://tour.giraffe360.com/82f3dcdb70fd46f9ba92d34190470a8b>

Mobile Phone Coverage and Broadband speeds can be checked on the Ofcom website:  
<https://checker.ofcom.org.uk/>

Holding Deposit: £115.00 (one week's rent)  
Full Deposit: £500.00  
1st month's rent + Full Deposit: £1000.00

Total household income must exceed £15,000.00 to be considered for this property.



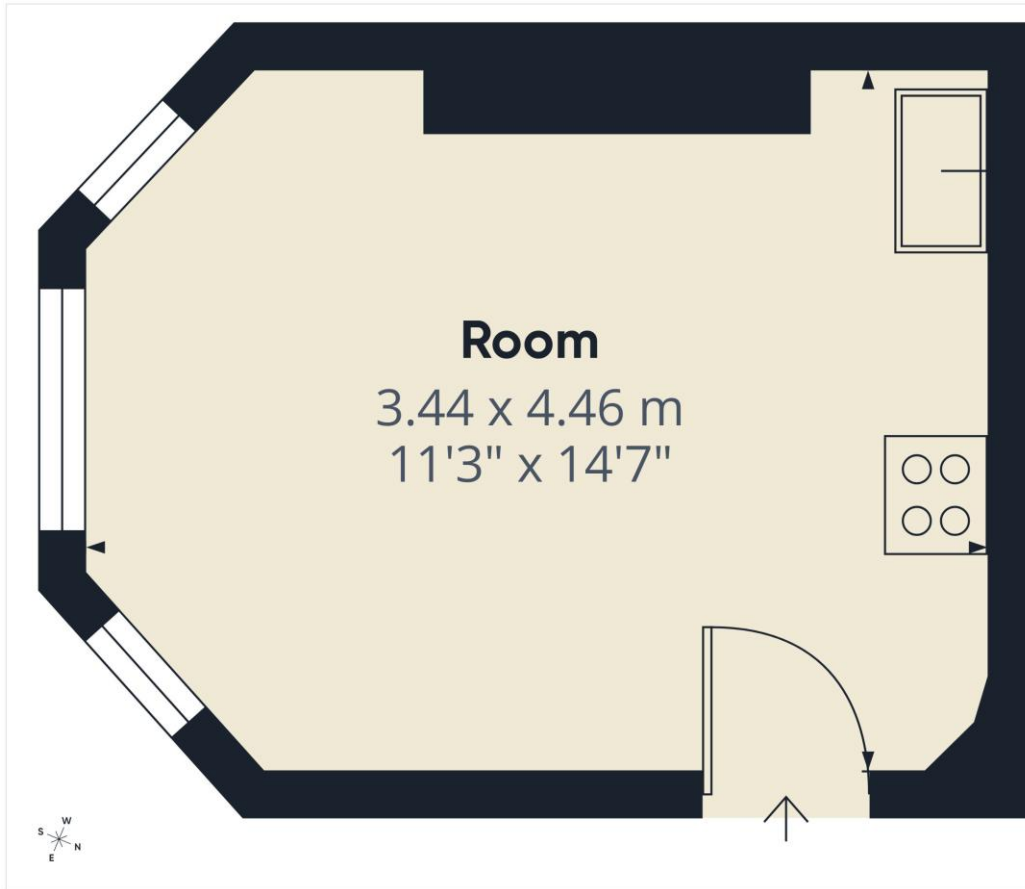

**Room**  
 3.44 x 4.46 m  
 11'3" x 14'7"



Approximate total area<sup>(1)</sup>  
 14.3 m<sup>2</sup>  
 154 ft<sup>2</sup>

(1) Excluding balconies and terraces

Calculations reference the RICS IPMS 3C standard. Measurements are approximate and not to scale. This floor plan is intended for illustration only.

GIRAFFE360



SEE MORE ONLINE

**Northwood**

81-83 South Street  
 Eastbourne  
 BN21 4LR  
 01323 744544  
 eastbourne@northwooduk.com

