

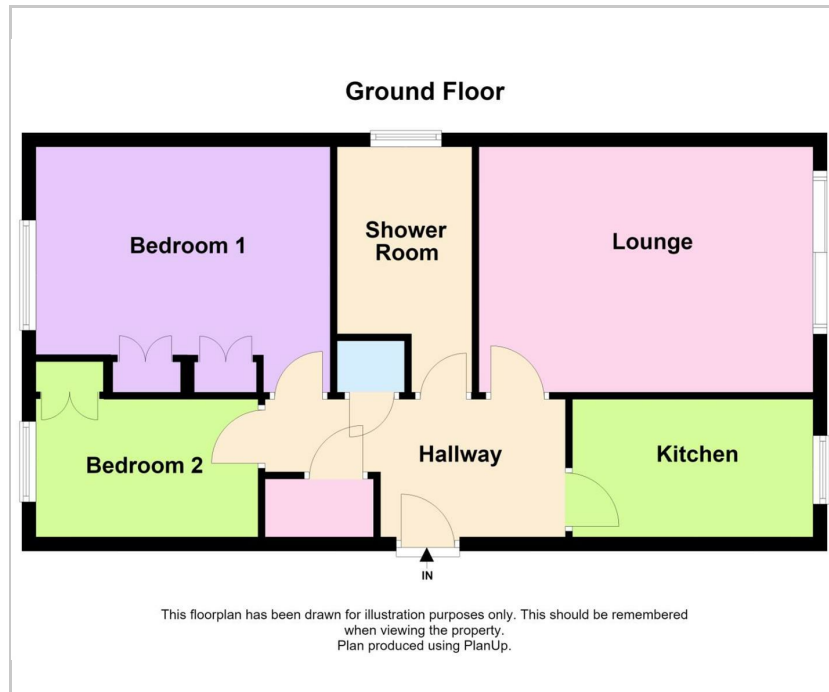

2 William Nichols Court Huntly Grove, PE1 4DW
£162,500

2 1 1 C

Floor Plan



Accommodation

Offering no upward chain and situated in a prime location within Peterborough is this spacious two bedroom ground floor flat. This property benefits from having a good sized lounge, with patio doors overlooking the front garden area. Re-fitted kitchen and a re-fitted shower room off the hall and with access to two bedrooms, with both benefiting from fitted wardrobes. Outside, Visitors parking bay to the side of the flats and in turn, with access leading to a single garage situated in a block. Furthermore, there is a secure gated access which leads to a communal garden area for the residents.

Tenure: Leasehold 186 years remaining
Service Charge: £1625 pa (£812.50 payable twice a year)
Council Tax Band: C

Entrance Hall:

Lounge: 15'7" x 11'8" (4.77m x 3.56m)

Kitchen: 12'4" x 5'9" (3.76m x 1.77m)

Bedroom 1: 13'8" x 11'5" (4.17m x 3.50m)

Bedroom 2: 10'4" x 6'5" (3.17m x 1.97m)

Shower Room: 11'7" x 5'10" (3.54m x 1.80m)



Area Map

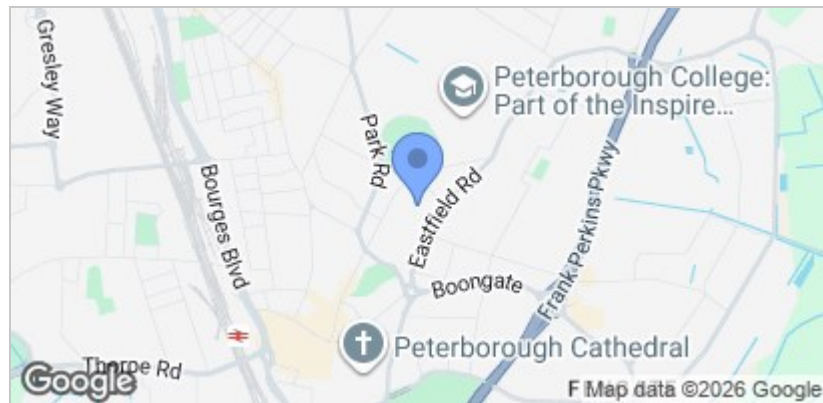

Viewing

Please contact our Peterborough Office on 01733 834727 if you wish to arrange a viewing appointment for this property or require further information.

Energy Efficiency Graph

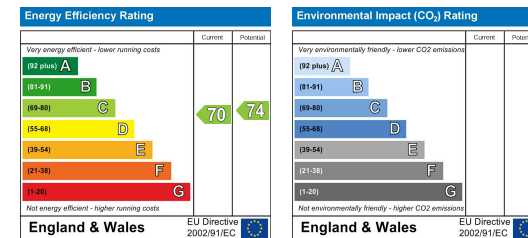

These particulars, whilst believed to be accurate are set out as a general outline only for guidance and do not constitute any part of an offer or contract. Intending purchasers should not rely on them as statements of representation of fact, but must satisfy themselves by inspection or otherwise as to their accuracy. No person in this firm's employment has the authority to make or give any representation or warranty in respect of the property.



381 Eastfield Road,
Peterborough, PE1 4RA
T: 01733 834727
E: peterborough@firminandco.co.uk