



CAPITOL WAY, NW9

£1,750 pcm

This modern 478 sq/ft 4th-floor apartment offers a highly functional open-plan lounge and kitchen layout, available either furnished or unfurnished. The high-specification kitchen comes fully integrated with premium white goods, including a dishwasher, tall standing fridge-freezer, and dedicated wine storage. Additional benefits include a secure video entry

- Parking Space Included
- On-Site Amenities Gym
- Integrated Kitchen with Wine Fridge
- Moments to Colindale Underground



ABOUT THE HOME

Situated in a highly sought-after Colindale development, this property is just moments from Colindale and Hendon Central stations, providing seamless commuting links via the Northern Line. Road commuters also benefit from rapid access to the M1. The development serves as a self-contained hub, boasting an exceptional array of on-site amenities including a gym, an on-site GP surgery, a M&S Foodhall, dry cleaners, a local pub, diverse restaurants, and cash points.





- FA Fire Alarm
- FE Fire Extinguisher

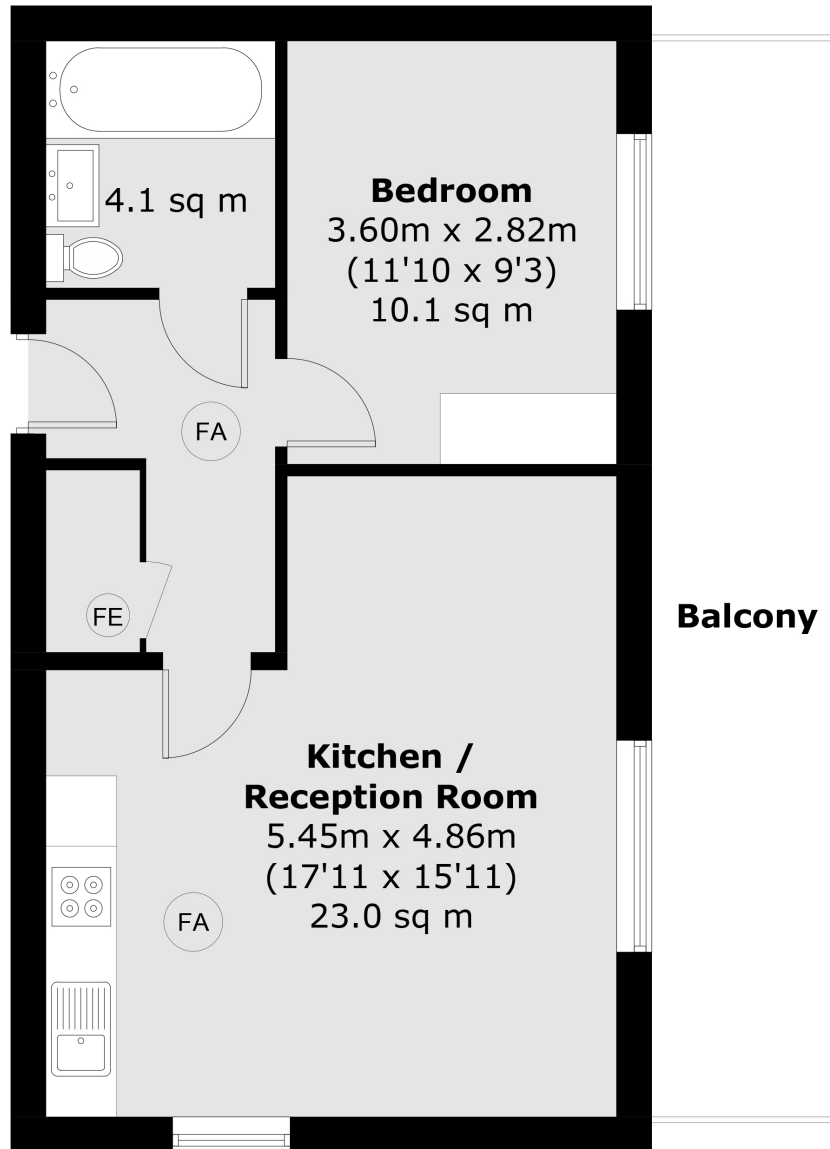

Total area (approx.): 44.5 sq. m (478.9 sq. ft)
Balcony: 14.2 sq. m (152.8 sq. ft)

LiFE RESIDENTIAL

203 Trentham Court, Victoria
Road, London, W3 6BT
Sales: 020 3668 1112
Lettings: 020 3668 1111

Energy Rating: B. We aim to make our particulars both accurate and reliable. However they are not guaranteed; nor do they form part of an offer or contract. If you require clarification on any points then please contact us, especially if you're traveling some distance to view. Please note that appliances and heating systems have not been tested and therefore no warranties can be given as to their good working order.