

Franklyn James



Homer Drive

, London, E14 3UF

Guide Price £315,000

CHAIN FREE Offered to the market in superb condition this spacious one bedroom apartment is set within the highly sought-after Cyclops Wharf development.

The well presented property features a welcoming entrance hall leading to a generously sized reception room complete with a Juliet balcony overlooking the peaceful courtyard. The separate refurbished kitchen offers ample space for cooking and storage while the double bedroom provides a comfortable retreat. The stylish fitted bathroom boasts a three piece suite.

Cyclops Wharf is one of E14's most desirable developments, offering residents exclusive access to a premium leisure complex including a swimming pool, sauna, steam room, and gym. Additional benefits include gated covered parking and a 24-hour concierge service.

Ideally located just moments from Mudchute DLR Station, the apartment enjoys excellent transport links into Canary Wharf and the City.

- One bedroom apartment in prestigious Cyclops Wharf
- Large double bedroom
- Spacious reception room
- 24 hour concierge
- Residents Gym
- Spa Facilities and Swimming Pool
- Juliet Balcony
- Allocated parking space
- Abundance of natural light
- Easy access into Canary Wharf and the City

Viewing

Please contact our Limehouse Sales Office on 02077911777 if you wish to arrange a viewing appointment for this property or require further information.



Floor Plan

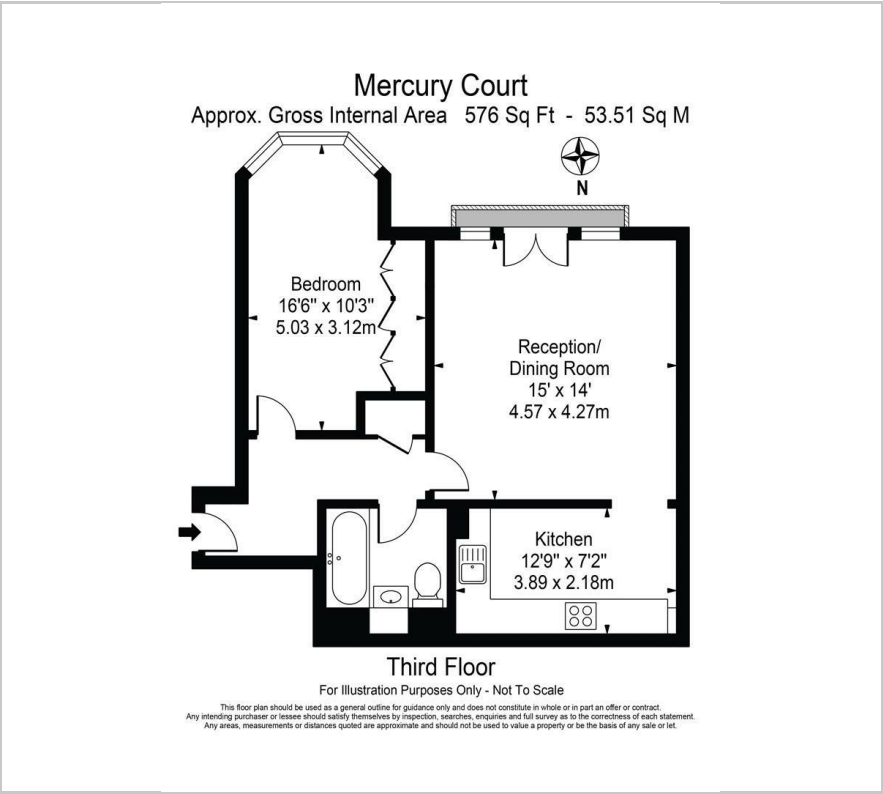

Area Map

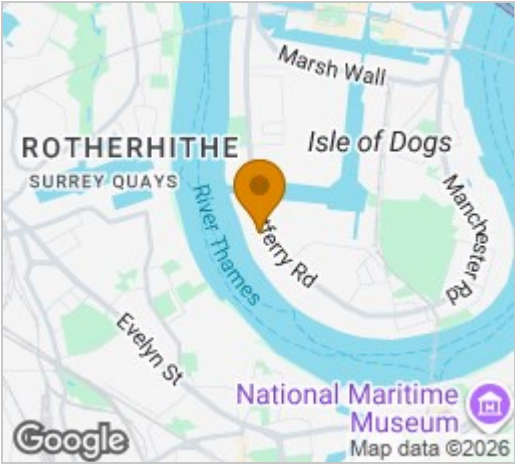

Energy Efficiency Graph

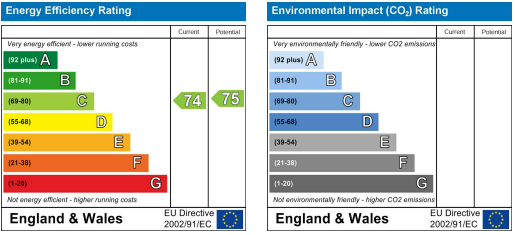

These particulars, whilst believed to be accurate are set out as a general outline only for guidance and do not constitute any part of an offer or contract. Intending purchasers should not rely on them as statements of representation of fact, but must satisfy themselves by inspection or otherwise as to their accuracy. No person in this firm's employment has the authority to make or give any representation or warranty in respect of the property.