

Golf Open 2026 - St. Thomas More Drive, Southport - Sleeps 4

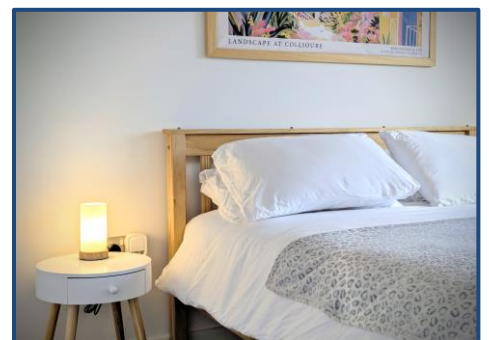

Sales

T: 01704 550048

E: sales@ajestateagents.co.uk



Rentals

T: 01704 543434

E: rentals@ajestateagents.co.uk



Property Management

T: 01704 545800

E: pm@ajestateagents.co.uk



**The Property
Ombudsman**

Property Features

- 2026 GOLF OPEN ACCOMMODATION
- 1.7 MILES FROM ROYAL BIRKDALE
- SLEEPS FOUR
- TWO DOUBLE BEDROOMS
- CLOSE TO AINSDALE VILLAGE
- MASTER SUITE WITH ENSUITE
- CONTEMPORARY MODERN FEEL
- OFF STREET PARKING



Property Description

AVAILABLE FOR THE ROYAL BIRKDALE OPEN 2026 – SLEEPS 4 Welcome to this beautifully presented, modern two-bedroom townhouse, ideally located just 1.7 miles from the prestigious Royal Birkdale Golf Club – the perfect contemporary retreat for guests attending The Open in 2026. Spanning three spacious levels, this thoughtfully designed home offers comfortable accommodation ideal for small groups or families. Each of the two generously sized double bedrooms is situated on its own floor, providing privacy and convenience, with a dedicated bathroom on each level. The inviting reception room is bathed in natural light thanks to overhead skylights, creating a bright and airy atmosphere. The fully equipped kitchen offers ample space for meal preparation, along with a charming dining area perfect for enjoying meals together. A convenient ground-floor WC adds further practicality. Step outside through the patio doors into a well-maintained garden, featuring flagged areas and astro turf, complete with a four-seater dining table – an ideal spot to unwind after a day at the course. Perfectly placed near Royal Birkdale, the property also benefits from its location close by to the heart of Ainsdale – a delightful area known for its leafy streets, relaxed coastal charm, and vibrant village feel. Within walking distance, you'll find a variety of shops, cosy cafés, welcoming bars, and highly regarded restaurants. For nature lovers, Ainsdale offers tranquil pine forest walks and stunning sandy beaches – the ideal setting for a sunset stroll. Stay connected with superfast WiFi throughout your stay. Flexible arrival and departure times can be arranged to suit your travel plans, ensuring a smooth, stress-free experience. Combining a crisp modern finish with all the comforts of home, this exceptional townhouse provides the ideal base for your 2026 Open Championship adventure.



Sales

T: 01704 550048

E: sales@ajestateagents.co.uk



Rentals

T: 01704 543434

E: rentals@ajestateagents.co.uk



Property Management

T: 01704 545800

E: pm@ajestateagents.co.uk



The Property Ombudsman



Sales

T: 01704 550048

E: sales@ajestateagents.co.uk



Rentals

T: 01704 543434

E: rentals@ajestateagents.co.uk



Property Management

T: 01704 545800

E: pm@ajestateagents.co.uk



**The Property
Ombudsman**



Sales

T: 01704 550048

E: sales@ajestateagents.co.uk



Rentals

T: 01704 543434

E: rentals@ajestateagents.co.uk



Property Management

T: 01704 545800

E: pm@ajestateagents.co.uk



**The Property
Ombudsman**

Ground Floor

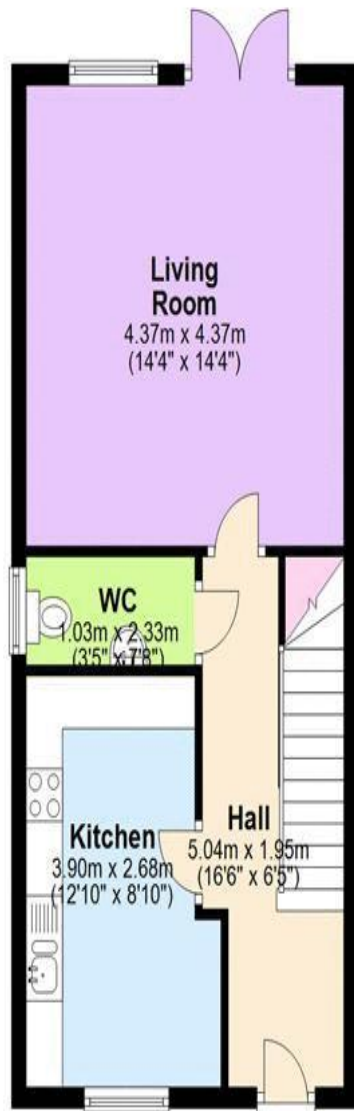

First Floor

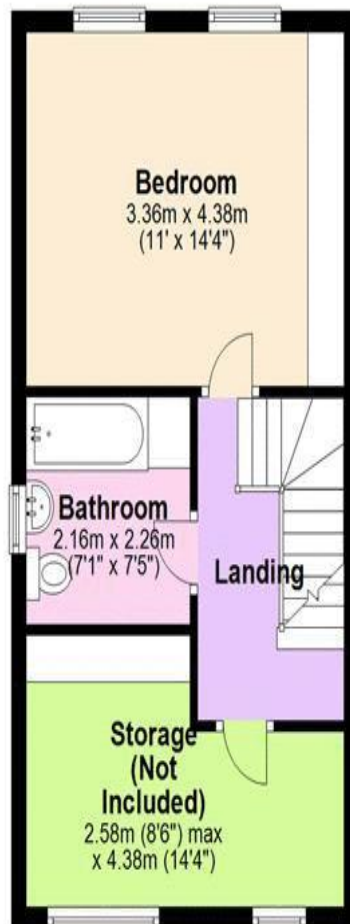

Second Floor



"Whilst every attempt has been made to ensure the accuracy of the floor plan contained here, measurements of doors, windows, rooms and any other item are approximate and no responsibility is taken for any error, omission, or misstatement. This plan is for illustrative purposes only and should only be used as such by any prospective purchaser.

Plan produced using PlanUp.

Disclaimer: Interested parties should satisfy themselves, by inspection or otherwise as to the accuracy of the description given and any floor plans shown in these property details. All measurements, distances and areas listed are approximate. Fixtures, fittings and other items are included unless specified in these details.

Sales

T: 01704 550048

E: sales@ajestateagents.co.uk



Rentals

T: 01704 543434

E: rentals@ajestateagents.co.uk



Property Management

T: 01704 545800

E: pm@ajestateagents.co.uk



The Property Ombudsman