



Kontiki. Old Glebe
Hemsby, Great Yarmouth, NR29 4HS
Offers Over £175,000



Kontiki. Old Glebe

Hemsby, Great Yarmouth, NR29 4HS

Aldreds are pleased to offer this detached bungalow of non standard construction on a generous plot which is situated in a tucked away location close to local amenities. The property offers accommodation comprising of an entrance porch, central living room with feature fireplace, newly installed kitchen, utility area, three double bedrooms, snug/study area and modern refurbished shower room. Outside is a generous established garden with a south facing aspect where there is ample off street parking and an attached workshop/studio. The property has been well maintained and benefits from double glazed windows, electric heating and solar panels for cheaper running costs. The property would make an ideal retirement home or for holiday let purposes.

Entrance Porch

Part double glazed composite entrance door, double glazed windows, wood panelled internal door to:

Living Room

16'4" x 11'7" (5.00 x 3.55)

Plus recess with the cast iron wood burner, double glazed windows to front and rear, wood effect LVT flooring, tv point, electric heater, access off to:

Kitchen

10'0" x 8'5" (3.07 x 2.57)

Recently re-fitted with a modern shaker style coloured finish kitchen with wall and matching base units with solid wood work surfaces over, white one and a half bowl ceramic sink with mixer taps, recess with range cooker with electric ovens and LPG hob, extractor hood over, wood effect flooring, double glazed French doors to rear, double glazed window, open access to:

Utility Area

4'7" x 4'5" (1.40 x 1.37)

Fitted base unit with solid wood work surface over and adjacent space and plumbing for a washing machine, double aspect double glazed windows, new stable door to rear.

Snug/Study

8'7" x 7'0" (2.63 x 2.14)

Double glazed window to rear, wood effect laminate flooring, doors leading off to:

Bedroom 1

17'10" x 8'8" (5.44 x 2.65)

Double glazed windows to front and rear aspects, built in wardrobe, electric panel heater, dressing room area.

Bedroom 2

9'11" x 8'7" (3.04 x 2.62)

Double glazed window to front aspect.

Bedroom 3

8'7" x 7'1" (2.64 x 2.18)

Double glazed window to front aspect, double casement doors.





Shower Room

Aqua panelling to walls, shower cubicle with electric shower, pedestal wash basin, low level wc, chrome electric towel rail/radiator, frosted double glazed window to side aspect.

Outside

The property is accessed via a shared private driveway which leads to the drive for the bungalow. In addition there is a further hardstanding parking area and beyond to the enclosed south facing garden. At the rear pf the property there is a further paved garden. On the eastern side of the property is a further yard and access to the non standard workshop/studio.

Tenure

Leasehold - annual license renewable with an approximate Ground rent £1,060 per year payable to the Geoffery Watling Trust Fund.

Services

Mains water, electric and drainage.

Council Tax

Great Yarmouth Borough Council - Band 'A'

Location

Hemsby is a coastal village approximately 7 miles north of Great Yarmouth. There is a variety of shops, post office, medical centre, first school with older children attending the middle and high schools in Martham, a school bus service link, regular bus service to and from Great Yarmouth. The beaches are one of the major draws of Hemsby, with miles of sandy coastline. Large sand dunes form a natural barrier between the beach and the village behind it. Hemsby is split into two parts: Hemsby Village and Hemsby Beach. Hemsby Village is mainly the residential area located about a mile inland. Kings Way this is also the main location for buses into Great Yarmouth and Martham.

Directions

From the Yarmouth office head north along the A149 Caister Road, continue past the Yarmouth Stadium, at the roundabout turn left onto the Caister Bypass, continue over the next roundabout into Jack Chase Way, continue over the next roundabout into Scratby Road, continue into Yarmouth Road, continue over the mini roundabout into Kingsway, at the next mini roundabout turn right into Beach Road, continue towards the end, turn left just before The main Glebe estate and between the take away and gift shop, down a private road leading to the property which can be found at the bottom.

Ref: Y12461



Floor Plan

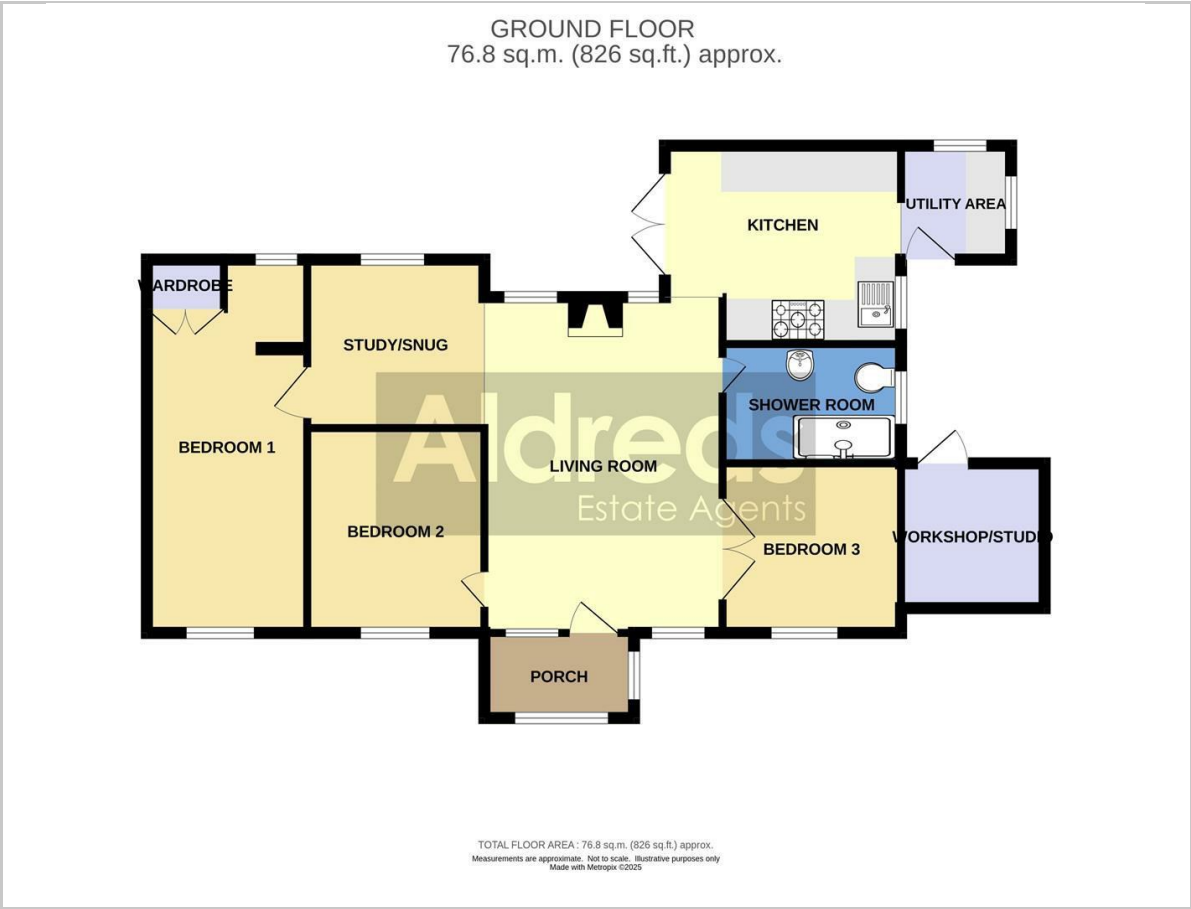

Area Map

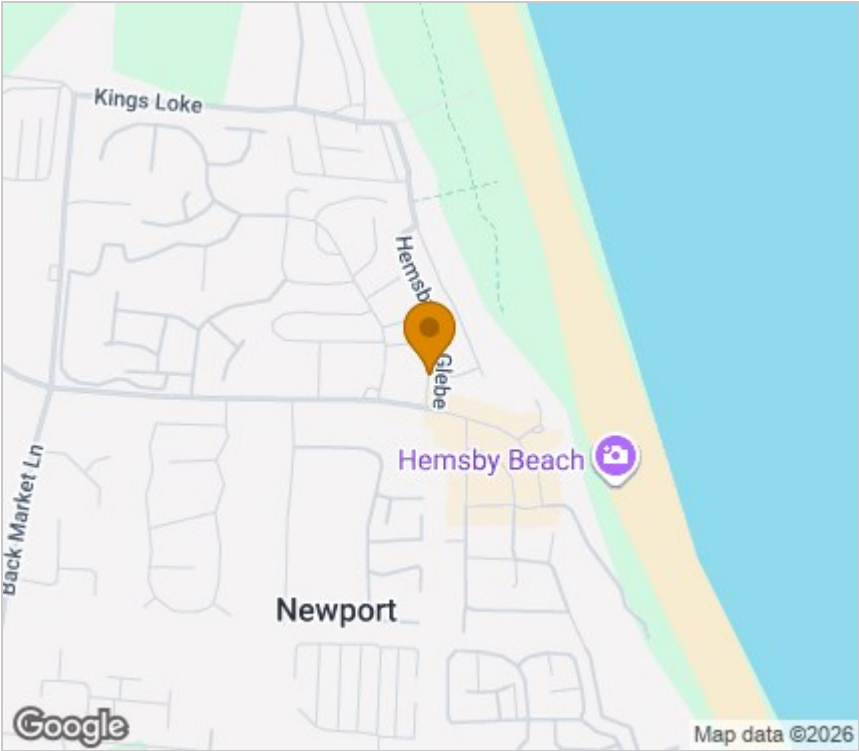

Energy Efficiency Graph

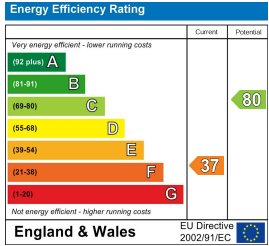

Viewing

Please contact our Aldreds Great Yarmouth Office on 01493 844891 if you wish to arrange a viewing appointment for this property or require further information.

Disclaimer
These particulars are issued on an understanding that all negotiations shall be conducted through Messrs. Aldreds. Please note: Messrs. Aldreds for themselves and for the vendors or lessors of this property whose agents they are given notice that: 1. Particulars are set out as a general outline only for guidance of intending purchasers or lessees, and do not constitute nor constitute part of, an offer or contract. 2. All descriptions, dimensions, references to condition and necessary permissions for use and occupation, and other details are given without responsibility and any intending purchasers or tenants should not rely on them as statements or representations of fact but must satisfy themselves by inspection or otherwise as to the correctness of each of them. 3. No person in the employment of Messrs. Aldreds has any authority to make or give any representation or warranty whatever in relation to this property. 4. If you are proposing to visit the property and are travelling some distance please check with Aldreds on the issue of availability prior to travelling. 5. Aldreds Property Consultants and associated services may offer additional services to the prospective purchaser for which they will be entitled to receive a commission. Aldreds are pleased to be working with Mortgage Advice Bureau. They're an award-winning mortgage broker with over 1,400 advisers across the UK, and have access to over 12,000 mortgage products from over 90 lenders. Aldreds Estate Agents Ltd receive a commission of £200 on each completed case. Your home may be repossessed if you do not keep up repayments on your mortgage. There may be a fee for mortgage advice. The actual amount you pay will depend upon your circumstances. The fee is up to 1%, but a typical fee is 0.3% of the amount borrowed. Mortgage Advice Bureau is a trading name of Mortgage Seeker Limited which is an appointed representative of Mortgage Advice Bureau Limited and Mortgage Advice Bureau (Derby) Limited which are authorised and regulated by the Financial Conduct Authority. Mortgage Seeker Limited Registered Office: Lovewell Blake, Sixty Six North Quay, Great Yarmouth, Norfolk, NR30 1HE. Registered in England Number: 03721415. 6. Potential purchasers should check with their providers that the broadband and mobile phone coverage they would require is available.

17 Hall Quay, Great Yarmouth, Norfolk, NR30 1HJ
Tel: 01493 844891 Email: yarmouth@aldreds.co.uk <https://www.aldreds.co.uk/>
Registered in England Reg. No. 08945751 Registered Office: 17 Hall Quay, Great Yarmouth, Norfolk NR30 1HJ
Directors: Mark Duffield B.S.c. FRICS. Dan Crawley MNAEA Paul Lambert MNAEA