



enfields

# Gainsford Road, Southampton, SO19 7AR

Offers Over £350,000

🛏️ 3 🚿 2 🚗 2



- No Forward Chain
- Three Bedrooms
- Driveway Parking
- Utility Room
- Waterside Views
- Semi Detached Family Home
- Two Reception Rooms
- Conservatory



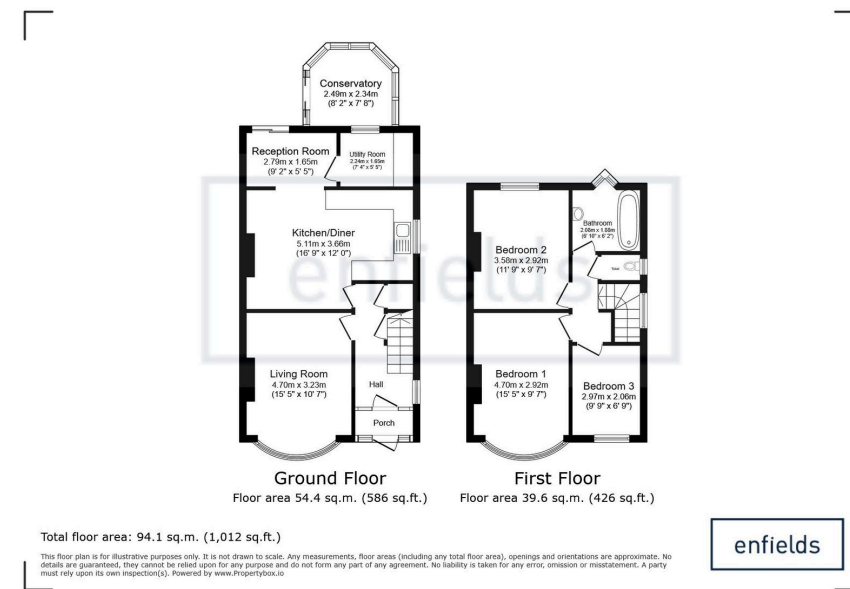

Enfields are delighted to present to the market this three bedroom semi detached family home situated within a popular location in Peartree Green and offering views over the River Itchen to the rear. Viewing is highly recommended.

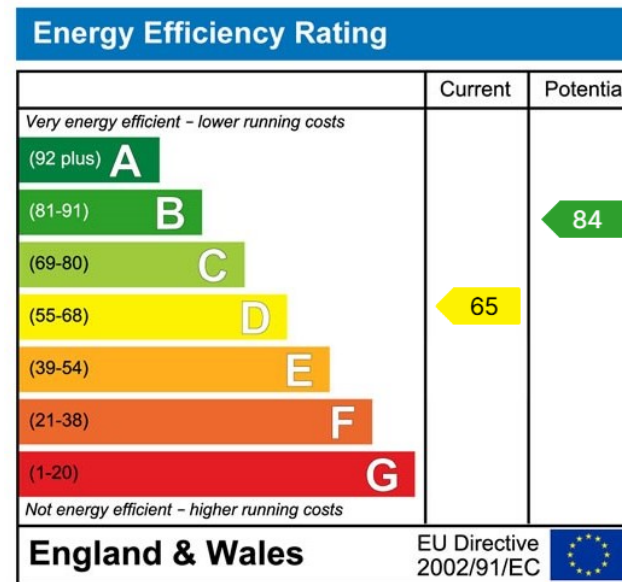

[www.enfields-southampton.co.uk](http://www.enfields-southampton.co.uk)



It is Enfields policy to respect any sole agency currently in force and we would not be able to commence marketing until this has expired or been terminated. If you fail to terminate any previous agreement you could be liable for two sets of fees. Enfields Hythe is a trading name of YTF LTD Registered office: 345 Shirley Road, Southampton, Hampshire, England, SO15 3JD. Company Registration No: 10459987. VAT Registration No: 281 2975 81.

Enfields Lettings - Embley Management LTD T/A Enfields. Registered Address: 345 Shirley Road, Southampton, Hampshire, England, SO15 3JD. Company Registration No: 14847604. VAT Registration No: 439 8546 45.