



Bromyard Avenue, W3

£299,950

A one bedroom apartment situated in this prestigious gated development with 24-hour concierge. The flat offers in excess of 500 sq.ft of accommodation, has access to communal gardens and is offered with no onward chain.

Bromyard Avenue is on the borders of Shepherds Bush and just over half a mile from East Acton (Central line) and Acton Central (Overground) stations providing excellent access into town.

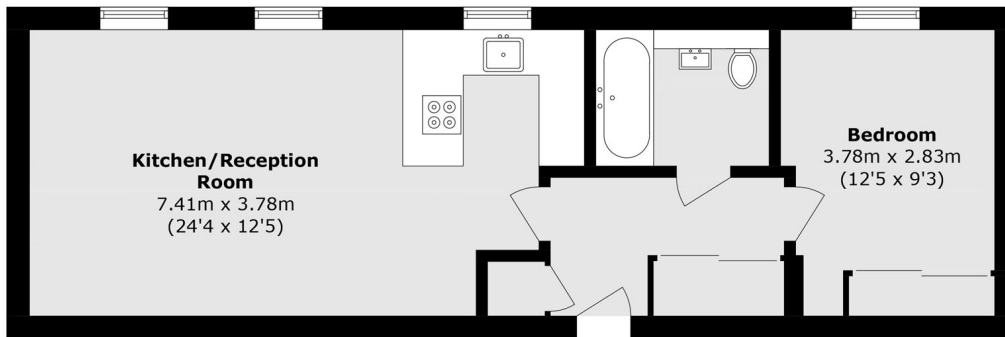

Total area (approx.): 48.1 sq. m (517.7 sq. ft)

Robertson Smith & Kempson Acton Sales
137 High Street, Acton,
London, W3 6LY
020 8896 3996
actonsales@robertsonsmithandkempson.co.uk

Energy Rating: C. We aim to make our particulars both accurate and reliable. However they are not guaranteed; nor do they form part of an offer or contract. If you require clarification on any points then please contact us, especially if you're traveling some distance to view. Please note that appliances and heating systems have not been tested and therefore no warranties can be given as to their good working order.