

LEASEHOLD



Apartment - First Floor (EPC Rating: C)

**166 WEST WING FAIRFIELD HALL, KINGSLEY
AVENUE, FAIRFIELD, HITCHIN, HERTFORDSHIRE,
SG5 4FY**

Price Guide

£320,000



First Step



2



2



1



C

2 Bedroom Apartment - First Floor located in Fairfield, Hitchin

CHAIN FREE... GRAND first floor apartment... EN-SUITE & DRESSING AREA... 2 DOUBLE Bedrooms... IMPRESSIVE BAY WINDOW with WOODEN SHUTTERS enjoying BEAUTIFUL VIEWS... EXCELLENT Storage... ALLOCATED Parking...

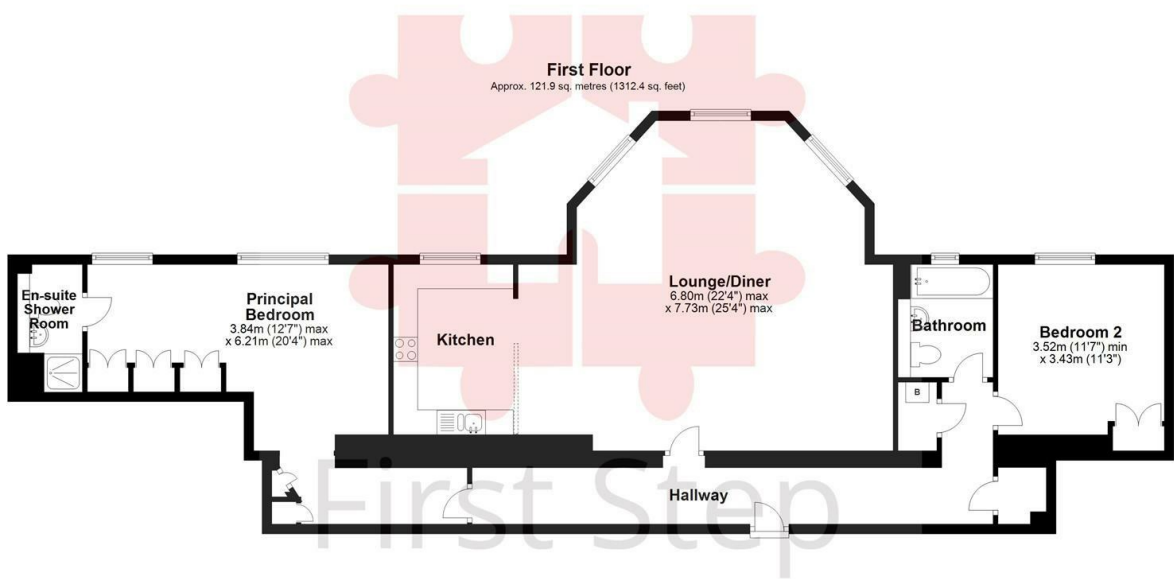

Total area: approx. 121.9 sq. metres (1312.4 sq. feet)

Council Tax Band

E

Energy Performance Graph

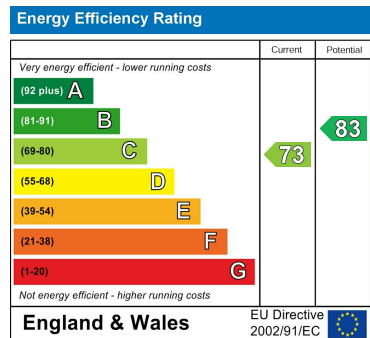

Call us on

01462 659 730

sales@firststep.ltd

www.firststep.ltd

Agents Note: Whilst every care has been taken to prepare these particulars, they are for guidance purposes only. All measurements are approximate and are for general guidance purposes only and whilst every care has been taken to ensure their accuracy, they should not be relied upon and potential buyers are advised to recheck the measurements.



First Step