

17 Steeplefield, Leigh-on-Sea, Essex, SS9 5XS  
Price Guide £450,000

**bear**  
*Estate Agents*



# 17 Steeplefield, Leigh-on-Sea, Essex, SS9 5XS

Price Guide £450,000

Council Tax Band: C

\* NO ONWARD CHAIN \* Guide Price £450,000 to £475,000. Bear Estate Agents are pleased to bring to market this well-presented four bedroom family home situated in a peaceful residential location. Offering generous internal living space across two floors, this property features an open-plan kitchen/diner, spacious lounge, utility room, four well-proportioned bedrooms, and a garage with driveway parking. Ideal for growing families, the home is move-in ready and conveniently located close to local schools, parks and commuter links. Eastwood Primary School and Eastwood Academy are within catchment.

Located in a peaceful and family-friendly residential area, Steeplefield enjoys a convenient position within Eastwood, offering easy access to a wide range of local amenities. The property is within close proximity to well-regarded schools including Eastwood Primary School and The Eastwood Academy, parks and local shops, making it ideal for families. Excellent transport links are nearby, including bus routes and major road connections such as the A127, providing quick access to Southend town centre, the seafront, and beyond. For commuters, nearby train stations offer direct links into London, while leisure options including golf courses, nature reserves and beaches are all just a short drive away.

## Frontage & Parking

The property enjoys a smartly landscaped frontage with a block-paved driveway offering parking for two vehicles, bordered by decorative shingle. There is side access to the garden and direct access to the integrated garage. A UPVC double-glazed front door opens into the:

## Porch

A bright and welcoming entrance space with UPVC double-glazed windows to the front and side aspects, feature exposed brickwork, coir matting, and wall lighting. An original wooden and glazed internal door leads through to:

## Entrance Hall

Spacious hallway with laminate flooring, large storage cupboard, access to the downstairs WC, utility room, and internal garage. Carpeted stairs rise to the first floor with additional storage beneath. Radiator.

## Lounge

18'0 x 15'0

A spacious reception room with UPVC double-glazed window to the side aspect, feature electric fireplace, alcove storage, modern vertical radiator, and laminate flooring. Opens directly into the:

## Kitchen/Diner

17'3 x 10'1

Beautifully presented open-plan space with a UPVC double-glazed rear window and sliding doors leading out to the garden. Fitted kitchen with a mix of wall

and base units, real wooden worktops, and tiled splashbacks. Features include a five-ring Siemens gas hob with extractor, integrated oven, space for a fridge/freezer and dishwasher, inset stainless steel sink with mixer tap, tiled flooring, coving, and spotlights.

## Utility Room

Accessed via the hallway and providing an external door to the side garden. Fitted with both wall-mounted and base units, stainless steel sink with drainer and chrome mixer tap, and space for two undercounter appliances. Laminate flooring.

## Ground Floor WC

Obscured UPVC double-glazed window to front, WC, countertop wash basin with chrome mixer tap and tiled splashback, and laminate flooring.

## Landing

With carpeted flooring, skirting, loft access, and doors to all rooms.

## Bedroom One

11'9 x 11'2

Double bedroom with UPVC double-glazed window to the front aspect, carpeted flooring, skirting, and radiator.

## Bedroom Two

10'7 x 9'8

Double bedroom with UPVC double-glazed rear window, radiator, skirting, and laminate flooring.

## Bedroom Three

12'7 x 7'2

Another well-sized room with UPVC double-glazed rear window, laminate flooring, skirting, and radiator.

## Bedroom Four

11'5 x 6'8

Front-facing room with UPVC double-glazed window, built-in wardrobe, original wooden floorboards, skirting, and radiator.

## Bathroom





**Loft**

Fully boarded and insulated, ideal for storage.

**Garden**

The rear garden begins with a hardstanding patio area, perfect for outdoor seating and entertaining. The remainder is mainly laid to lawn, enclosed by fencing with side access from the front.



# bear

*Estate Agents*

204 Woodgrange Drive  
 Southend-on-Sea  
 Essex  
 SS1 2SJ  
 01702 811211  
[info@bearestateagents.co.uk](mailto:info@bearestateagents.co.uk)  
<https://www.bearestateagents.co.uk>

GROUND FLOOR

1ST FLOOR

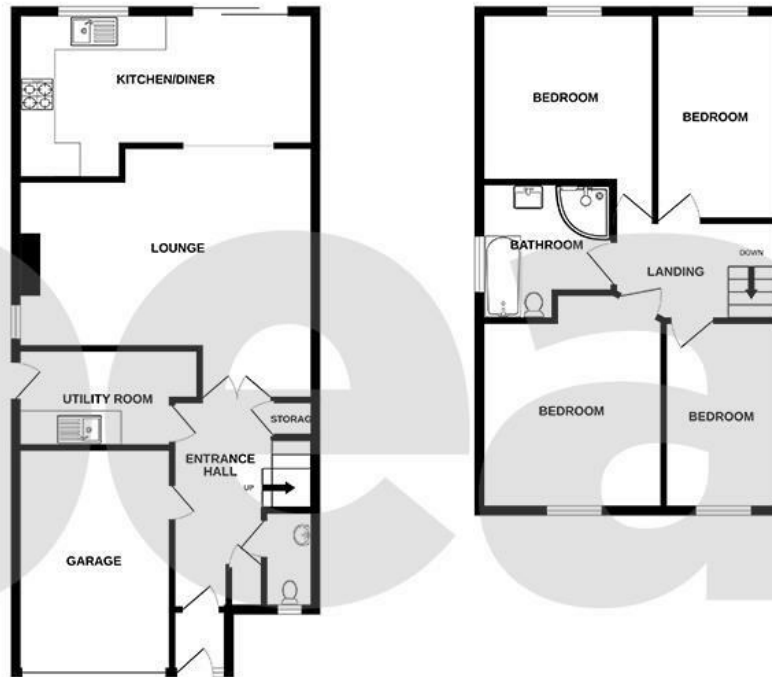

Whilst every attempt has been made to ensure the accuracy of the description contained here, measurements of rooms, windows, doors and any other items are approximate and no responsibility is taken for any error, omission or mis-statement. This plan is for illustrative purposes only and should be used as such by any prospective purchaser. The services, systems and appliances shown have not been tested and no guarantee is given as to their operability or efficiency at the time.  
 Made with MyPlanix ©2025

Energy Efficiency Rating		
	Current	Potential
Very energy efficient - lower running costs		
(92 plus) <b>A</b>		
(81-91) <b>B</b>		
(69-80) <b>C</b>	72	77
(55-68) <b>D</b>		
(39-54) <b>E</b>		
(21-38) <b>F</b>		
(1-20) <b>G</b>		
Not energy efficient - higher running costs		
England & Wales	EU Directive 2002/91/EC	