

JAMES EDWARD

Comprehensively Cared For



Athlone House

14 Thomas Barnardo Way, Ilford, IG6 1FY

£240,000



1



1



1



Athlone House



Description

Larger than usual one bedroom apartment with private patio and direct access to communal garden. Situated in the beautiful Barnardo's Garden Village development, just a stone's throw from Barkingside High Street, Barkingside Underground Station (Central Line) and Fairlop Waters Country Park.

- 25% discount from Developer
- One allocated private parking space
- 5 minute walk to Barkingside Underground
- Exclusive Barnardo's Garden Village development
- Private patio with direct access to communal garden
- 595 sq ft
- South Facing Garden
- 5 minute walk to Fairlop Waters Country Park
- Immaculate condition built in 2017
- Chain Free





Floor Plan

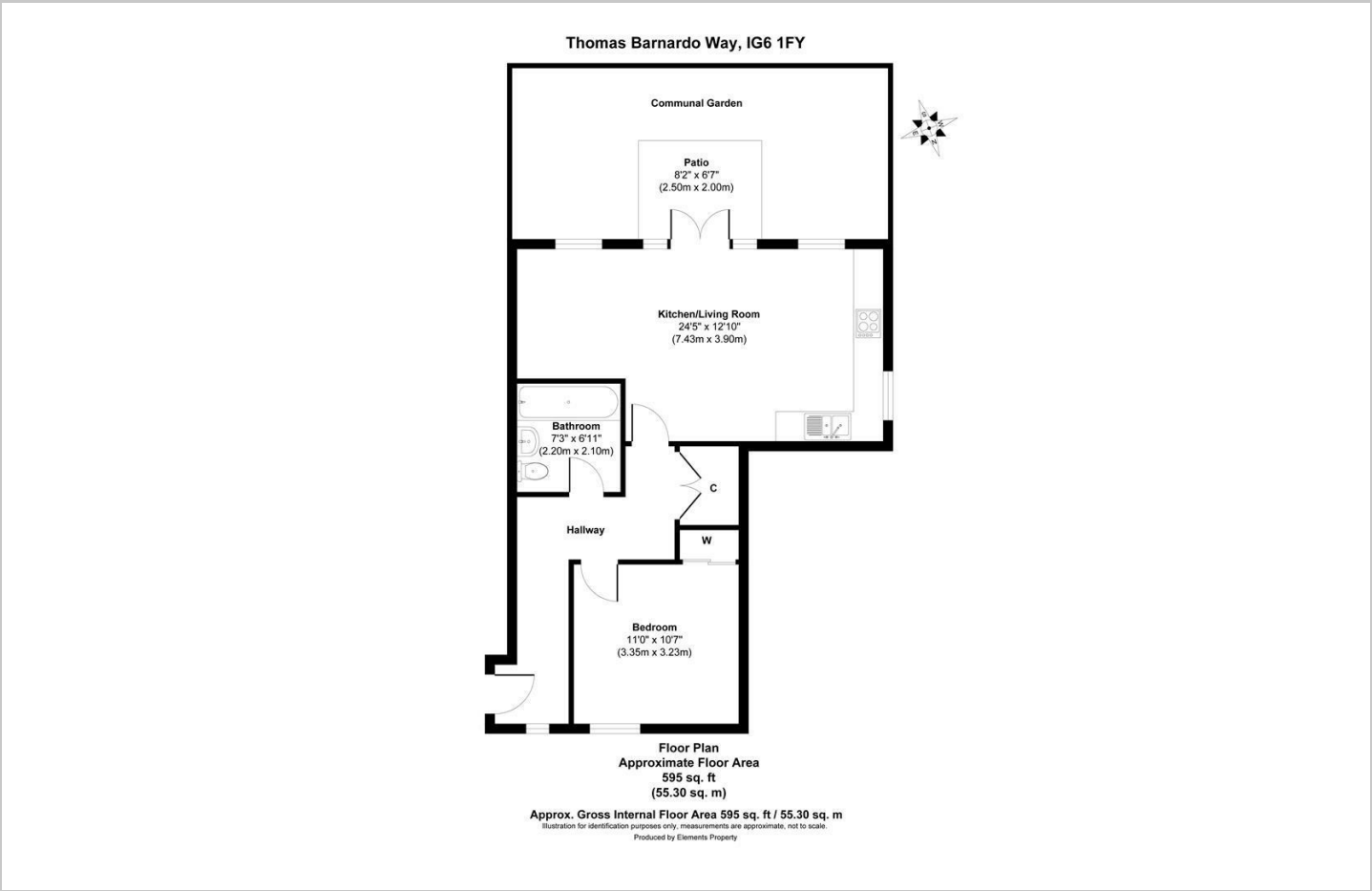

Area Map

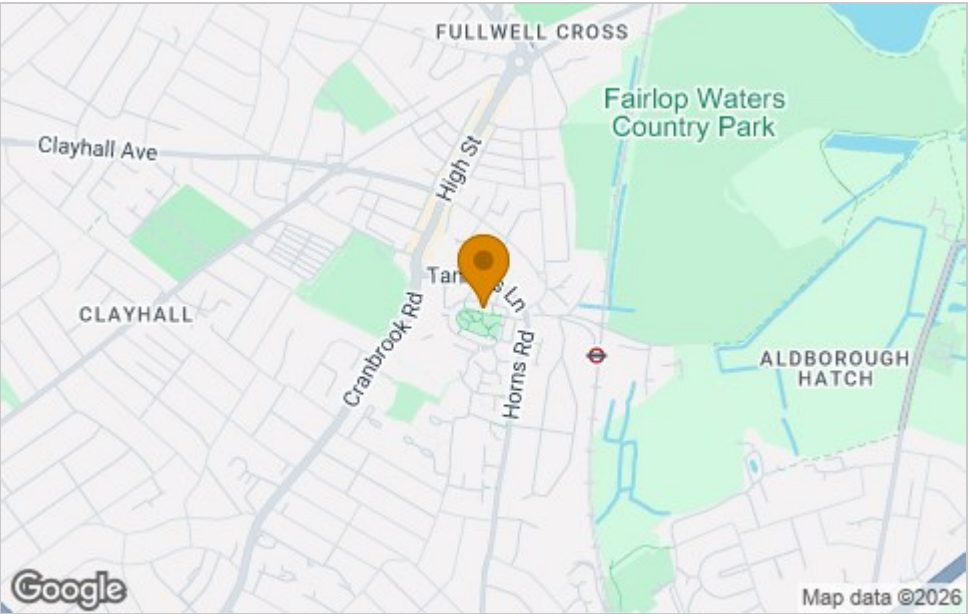

Viewing

Please contact our James Edward Office on 020 7952 5197 if you wish to arrange a viewing appointment for this property or require further information.

Energy Efficiency Graph

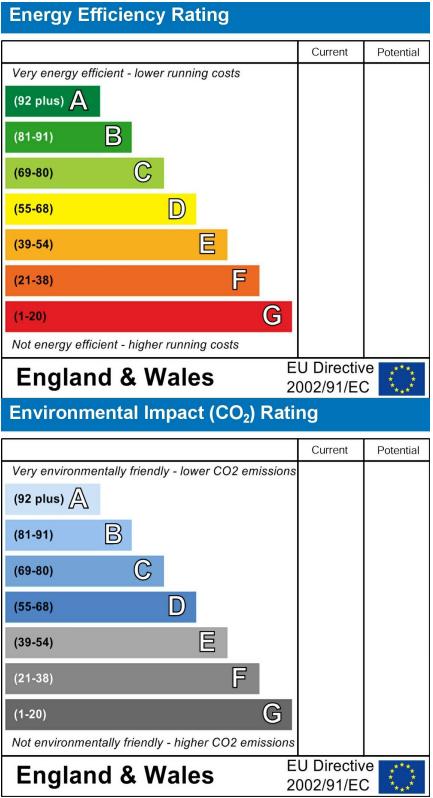

These particulars, whilst believed to be accurate are set out as a general outline only for guidance and do not constitute any part of an offer or contract. Intending purchasers should not rely on them as statements of representation of fact, but must satisfy themselves by inspection or otherwise as to their accuracy. No person in this firms employment has the authority to make or give any representation or warranty in respect of the property.