



## Wandsworth Road, SW8

£2,600 Per calendar month

A well presented and spacious two double bedroom, two bathroom apartment set in a popular modern development. The property also offers an open plan kitchen/ reception room, two private balcony's and an on-site concierge

Ideally located on Wandsworth Road which offers many local amenities that include Pure Gym, Tesco's Express and the newly opened Nine Elms Station ( Northern Line).

### Features

- Two Double Bedrooms
- Modern Development
- Two Bathrooms
- On-Site Concierge
- Two Private Balcony's
- Close To Underground

# Wandsworth Road, London, SW8

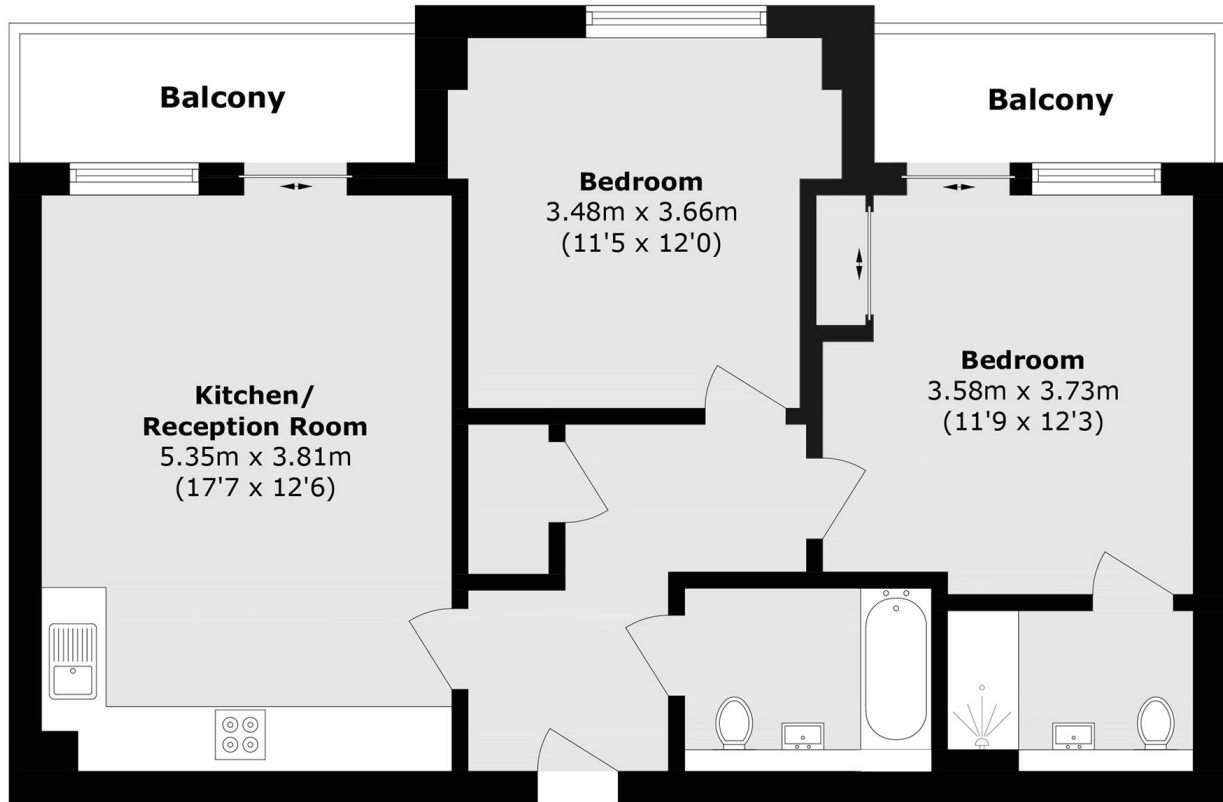

Total area (approx.): 62.5 sq. m (672.7 sq. ft)

Balcony area (approx.): 6.9 sq. m (74.2 sq. ft)